



Russell Hobbs



SUPREME STEAM GENERATOR

2 YEAR WARRANTY

RHC670

RHC670AU_JIB_FA_251023
Part no. T22-9002334

INSTRUCTIONS & WARRANTY

IMPORTANT SAFEGUARDS

When using this appliance, basic safety precautions should always be followed, including the following: Read all instructions before, and follow whilst using this appliance.



1. To protect against electrical hazards, do not immerse the power cord, plug or iron in water or any other liquid.
2. Do not use outdoors or in damp or moist areas.
3. Do not touch hot surfaces, always use the appliance handles.
4. Care should be taken when using the appliance due to the emission of steam.
5. This appliance is not intended for use by persons (including children) with reduced physical, sensory or mental capabilities, or lack of experience and knowledge, unless they have been given supervision or instruction concerning use of the appliance by a person responsible for their safety.
6. This appliance must be attended whilst plugged in.
7. Ensure the iron is situated on the base unit and clear from any surrounding objects when switching on.
8. Ensure the iron is unplugged during filling and emptying.
9. Always turn off and unplug from the wall power outlet when not in use.
10. To avoid possible burns, ensure the appliance is off and has cooled before cleaning.
11. To disconnect, turn off the wall power outlet, then grasp and pull the plug from the wall outlet. Never pull by the cord.
12. Do not operate this appliance with a damaged cord/plug or after the appliance has been dropped, is leaking, damaged or has malfunctioned in any manner. Contact Customer Service for examination, adjustment, repair or replacement.
13. There are no user serviceable parts. If repairs are required, they must be performed by the manufacturer or a suitably qualified person in order to avoid a hazard.
14. Do not use on an inclined or unstable surface.
15. Keep the appliance and the power cord away from the edge of tables or countertops and out of reach of children and persons with reduced physical, sensory and mental capacities.
16. Ensure the power cord does not present a tripping hazard.
17. Do not place on or near any heat sources.
18. Follow the instructions when cleaning this appliance.
19. Cleaning or user maintenance shall not be carried out by children without the supervision of a person responsible for their safety.
20. Do not use this appliance for other than its intended purpose.
21. Misuse of the appliance may cause injury.
22. Do not leave the iron unattended when switched on or where it may be touched by children or persons with reduced physical, sensory and mental capacities while it is still hot.
23. This appliance is not a toy. Children should be supervised to ensure they do not play with the appliance.
24. This appliance is not intended to be operated by means of an external timer or separate remote control system.
25. For added safety, electrical appliances should be connected to a power outlet that is protected by a residual current device (RCD / 'Safety Switch') having a rated residual operating current not exceeding 30mA. Your switchboard may already incorporate an RCD. If unsure, call an electrician for verification and fitting if necessary.
26. This appliance is intended to be used in household and similar applications such as:
 - a. Staff kitchen areas in shops, offices and other working environments;
 - b. Farm houses;
 - c. By clients in hotels, motels, and other residential type environments;
 - d. Bed & breakfast type environments.

SAVE THESE INSTRUCTIONS.

 The surfaces of the appliance will get hot.

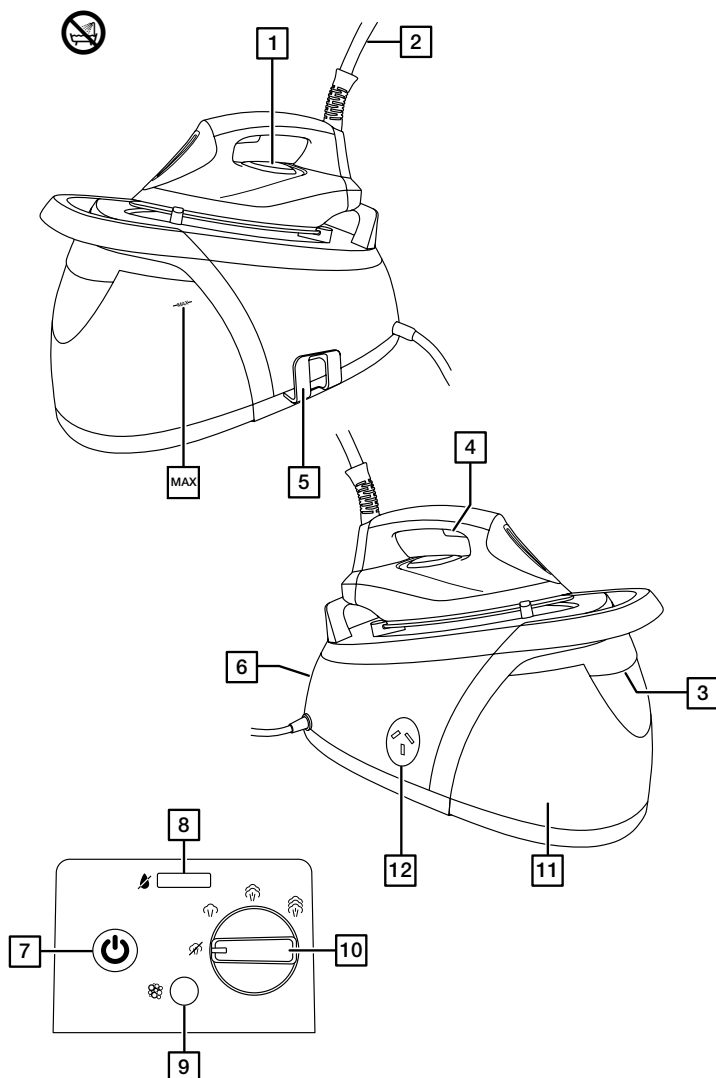

PARTS

- | | |
|------------------------------|---|
| 1. Thermostat light | 8. Low water light |
| 2. Steam pipe | 9. Anti-scale filter warning light/reset button |
| 3. Water tank release button | 10. Steam control |
| 4. Steam trigger | 11. Reservoir |
| 5. Hose clip | 12. Plug storage socket |
| 6. Control panel | 13. Cover |
| 7. On/off button | 14. Anti-scale filter |

BEFORE USING FOR THE FIRST TIME

- Remove any labels, stickers or packaging from the steam station and iron soleplate.
- Remove the water tank and rinse with clean water.
- Before using the iron for the first time, or if it's not been used for a long time, iron a scrap piece of cotton or linen to remove any accumulated residues.
- The iron may give off an odour and small amount of vapour when switched on for the first time. This is normal and will stop as the element cures.

AUTO SHUT-OFF

If you don't press the steam trigger for 10 minutes your iron's auto shut-off feature will operate. The thermostat light and the on/off button will flash to tell you that it is in auto shut-off mode. To cancel the auto shut-off mode, press the steam trigger. Note that your iron will need time to heat up again. Wait until the temperature light has stopped flashing before resuming ironing.

FILLING/REFILLING

- Don't add anything to the water and don't use water with anything added to it. When the water is converted to steam, chemicals, perfume, and other additives will coat the inside of the steam chamber, shortening the life of the iron.
1. Press the water tank release button and pull the water reservoir away from the body of the steam generator (fig. A).
 2. Fill the reservoir to the **max** mark. Do not exceed the **max** mark.
 3. Refit the reservoir into the base unit pushing it in until it clicks.
- A warning light (⚡) will come on and the unit will beep twice when the reservoir needs refilling. If the reservoir is empty, the steam function will stop working after one minute, however, you can still use your iron without steam.

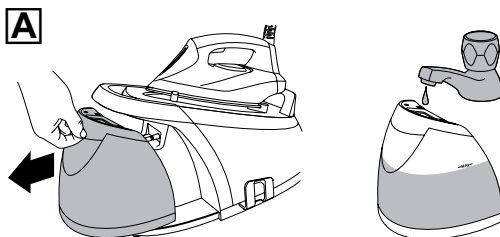

PRELIMINARY SETTINGS

1. Put the iron on top of the base unit.
2. Put the plug into the power socket (switch the socket on, if it's switchable).
3. Turn the unit on by pressing the on/off button.

USING

The temperature of your iron is safe to use on all ironable fabrics and garments.

DRY IRONING

1. Set the steam control to ☞
2. When the temperature light stops flashing your iron is ready to use.

STEAM IRONING

1. Set the steam control to the setting you want, ☞ = no steam, ☞☞ = high steam.
 2. Squeeze the steam trigger to produce steam, release it to stop.
- Your steam generator produces steam very efficiently so use the trigger in short, controlled bursts. Too much steam can wet the fabric or cause condensation issues on your ironing board. Steam can also be reduced by setting the steam control to a lower setting.

NOTE: When you first start your steam generator and pull the trigger for steam ironing, there will be a delay as your steam generator pumps water from the reservoir to prime the system. This is normal and may take 20-30 seconds. This will also happen after refilling the reservoir.

VERTICAL STEAMING

Remove wrinkles from hanging clothes, hanging curtains, and furnishing fabrics.

- Check that there's adequate ventilation behind the fabric, otherwise moisture may build up, causing mildew.
 - Check that there's nothing behind the fabric that may be damaged by the steam.
 - Check that pockets, turn-ups, and cuffs are empty.
1. Lift the iron off the fabric.
 2. Squeeze the steam trigger to produce steam, release it to stop.

AFTER USE

1. Put the iron on top of the base unit.
2. Switch the appliance off and unplug it.
3. Empty the reservoir.
4. Let the iron cool down completely before cleaning it, moving it, or storing it away.
5. The steam pipe can be coiled together and placed into the hose clip.
6. Wrap the mains cable around the steam generator then slot the plug into the plug storage socket.

ANTI-SCALE FILTER

To extend the life of the appliance and to avoid problems with lime scale, your steam generator is fitted with an anti-scale filter. When the anti-scale filter needs cleaning, the anti-scale filter warning light (8) will come on. If the warning light comes on when you are ironing you can continue without cleaning the filter. The next time your steam generator is switched on, the light will come on and the appliance will beep continuously. **The filter must be cleaned and the anti-scale filter warning must be reset before your steam generator can be used again.**

Before attempting to remove and clean the filter you must unplug and allow the appliance to stand for at least 1 hour to allow any built up steam and heat to dissipate.

To clean the filter and reset the anti-scale warning light:

1. Switch off and unplug your steam generator.
2. Remove the iron from the top of the generator to expose the cover beneath.
3. Open the cover.
4. Unscrew the plug underneath the cover and lift the plug and filter assembly out of the base (Fig B).
5. Remove the filter from the plug by twisting it (Fig C).
6. Rinse the filter under a tap to remove any deposits. Use a soft brush if necessary.
7. Replace the filter onto the plug and twist it until it locks.
8. Refit the plug and filter assembly into the base and tighten it firmly. Close the cover.
9. Plug in your steam generator.

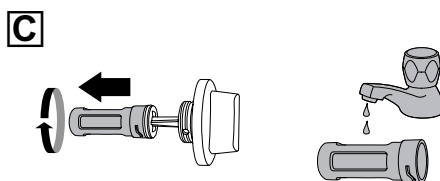
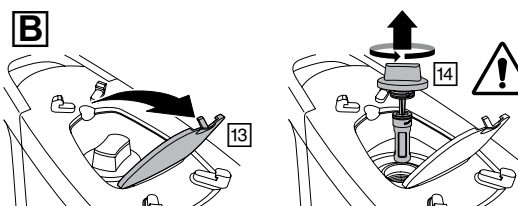

10. Reset the anti-scale filter warning by pressing and holding the anti-scale warning light/reset button (⌘) for 3 seconds until the light goes out. The thermostat light will continue to flash until the iron has reached operating temperature.
11. Once the appliance is ready, pull the steam trigger until the steam is being produced. This will prime the system.

IMPORTANT: Using the appliance without cleaning the filter can cause a reduction in the generated steam output and damage the appliance. The guarantee will not cover damage caused to the appliance by not cleaning the anti-scale filter when required. Do not clean the anti-scale filter in a dishwasher. Wash by hand only using a soft bristled brush if necessary.

CARE & MAINTENANCE

- Unplug the steam generator when not in use, and before cleaning.
- Allow the iron to cool down completely before cleaning and storing away.
- Wipe outer surfaces with a damp cloth. If necessary, use a little dishwashing liquid.
- Remove spots from the soleplate with a little vinegar. Take care not to scratch the soleplate.
- Do not immerse the steam generator or iron in water or any other liquid.
- Do not use harsh or abrasive cleaning agents, solvents or scourers on the soleplate as these will damage the coating.

TROUBLESHOOTING

Your steam generator is programmed to check itself when it is switched on. If a problem is detected and the unit is not able to operate correctly, the steam trigger will stop working, the thermostat light will flash and the unit will beep continuously.

VISUAL AND AUDIBLE INDICATIONS

Your steam generator is programmed to provide visual and audible indications of temperature, water level, anti-scale filter and auto shut-off status.

INDICATION	BEEPS	STATUS
Thermostat light - Flashing	None	Appliance is heating up.
Low water light - On	2 (3 at power on if appliance is cold)	Water tank requires filling.
Anti-scale warning light - On	Continuous	Anti-scale filter requires cleaning following which, the anti-scale warning must be reset.
On/Off button and thermostat light - Flashing	None	Appliance has entered Auto Shut-Off mode.
Thermostat light - Flashing (all other lights off)	Continuous	Internal error.

Note: If at any time the appliance is beeping continuously, press and hold the anti-scale warning light/reset button (⌘) for 3 to 4 seconds. If this does not rectify the issue, discontinue use and contact our customer service team for further assistance.

DISPOSAL/RECYCLING

Legislation in some localities mandates that e-waste (anything with a plug, battery or cord) is disposed of through controlled recycling facilities and must not be disposed of in general household waste. For more information about recycling of electrical and battery operated appliances, please contact your local council or your local household waste disposal service.

Spectrum Brands Australia Pty Ltd

Locked Bag 3004 Braeside
Victoria 3195 Australia

Customer Service in Australia

TollFree: 1800 623 118

Email: info@spectrumbrands.com.au

Website: www.spectrumbrands.com.au

Spectrum Brands New Zealand Ltd

PO Box 9817 Newmarket
Auckland 1149 New Zealand

Customer Service in New Zealand

TollFree: 0800 736 776

Email: service@spectrumbrands.co.nz

Website: www.spectrumbrands.co.nz

Spectrum Brands Australia Pty Ltd and Spectrum Brands New Zealand Ltd Warranty Against Defects

In this warranty:

Australian Consumer Law means the Australian consumer law set out in Schedule 2 to the Competition and Consumer Act 2010;

CGA means the New Zealand Consumer Guarantees Act 1993;

Goods means the product or equipment which was accompanied by this warranty and purchased in Australia or New Zealand, as the case may be;

Manufacturer, We or us means:

1. for Goods purchased in Australia, Spectrum Brands Australia Pty Ltd ABN, 78 007 070 573; or
2. for Goods purchased in New Zealand, Spectrum Brands New Zealand Ltd, as the case may be, contact details as set out at the end of this warranty;

Supplier means the authorised distributor or retailer of the Goods that sold you the Goods in Australia or in New Zealand; and

You means you, the original end-user purchaser of the Goods.

1. Our goods come with guarantees that cannot be excluded under the Australian Consumer Law, or the CGA. You are entitled to a replacement or refund for a major failure and compensation for any other reasonably foreseeable loss or damage. You are also entitled to have the goods repaired or replaced if the goods fail to be of acceptable quality and the failure does not amount to a major failure.
2. The benefits provided by this Warranty are in addition to all other rights and remedies in respect of the Goods which the consumer has under either the Australian Consumer Law or the CGA. The original purchaser of the Goods is provided with the following Warranty subject to the Warranty Conditions:

3. We warrant the Goods for all parts defective in workmanship or materials from the date of purchase, for the period of 2 years from the date of purchase (**Warranty Period**)

If the Goods prove defective within the Warranty Period by reason of improper workmanship or material, we may, at our own discretion, repair or replace the Goods without charge.

Warranty Conditions

4. The Goods must be used in accordance with the manufacturer's instructions. This Warranty does not apply should the defect in or failure of the Goods be attributable to misuse, abuse, accident or non-observance of manufacturer's instructions on the part of the user. As far as the law permits, the manufacturer does not accept liability for any direct or consequential loss, damage or other expense caused by or arising out of any failure to use the Goods in accordance with the manufacturer's instructions.
5. Exhaustible components (such as batteries, ironing board cover, filters and brushes) of the Goods are included under this Warranty only where there is a defect in workmanship or materials used.
6. The warranty granted under clause 3 is limited to repair or replacement only.
7. Any parts of the Goods replaced during repairs or any product replaced remain the property of the manufacturer. In the event of the Goods being replaced during the Warranty Period, the warranty on the replacement Goods will expire on the same date as for the Warranty Period on the original Goods which are replaced.
8. In order to claim under the warranty granted under clause 3 you must:
 - (a) Retain this warranty with your receipt/proof of purchase; and
 - (b) Return the Goods to us at the relevant address or to the Supplier by prepaid freight within the Warranty Period accompanied with (i) the legible and unmodified original proof of purchase, which clearly indicates the name and address of the Supplier, the date and place of purchase, the product name or other product serial number and (ii) this warranty.
9. This warranty is immediately void if:
 - (a) Any serial number or appliance plate is removed or defaced;
 - (b) The Goods have been serviced or otherwise repaired by a person not authorised to do so by us or where non approved replaced parts are used.
10. The Goods are designed for domestic use only. A limited 90-day Warranty applies to any industrial or commercial use of the Goods. The Goods must be connected to the electrical voltage requirements as specified in the ratings label located on the Goods.
11. This warranty does not cover the cost of claiming under the warranty or transport of the Goods to and from the Supplier or us.
12. This warranty is only valid and enforceable in Australia against Spectrum Brands Australia Pty Ltd and in New Zealand against Spectrum Brands New Zealand Ltd.

Contact us or the Supplier for further details.

Register your product online

If you live in Australia please visit: www.spectrumbrands.com.au/warranty

If you live in New Zealand Please visit: www.spectrumbrands.co.nz/warranty

Registration of your warranty is not compulsory, it gives us a record of your purchase AND entitles you to receive these benefits: Product information; Hints and tips; Recipes and news; Information on special price offers and promotions.

Any questions? Please contact Customer Service for advice.

[illegible]

[illegible]

This image shows a full page of white paper with horizontal dotted lines, typical of notebook paper. The lines are evenly spaced and run across the width of the page. There are no margins, text, or other markings present.



www.russellhobbs.com.au

www.russellhobbs.co.nz