



Russell Hobbs



POWER BOOST BLENDER

2 YEAR WARRANTY

RHBL700

RHBL700_IB_RB_FA_030720

Part No. T22-9002058

INSTRUCTIONS & WARRANTY

IMPORTANT SAFEGUARDS

When using this appliance, basic safety precautions should always be followed, including the following:
Read all instructions before, and follow whilst using this appliance.

1. To protect against electric shock do not immerse cord, plug or blender base of unit in water or liquid of any sort.
2. Do not use outdoors.
3. Do not use this appliance near bathtubs, showers, basins or other vessels containing water.
4. This appliance is not intended for use by persons (including children) with reduced physical, sensory or mental capabilities, or lack of experience and knowledge, unless they have been given supervision or instruction concerning use of the appliance by a person responsible for their safety.
5. This appliance is NOT a toy. Children should be supervised to ensure they do NOT play with the appliance.
6. Cleaning or user maintenance shall not be carried out by children without the supervision of a person responsible for their safety.
7. Always turn off and unplug from the wall power outlet when not in use, before fitting or removing parts, and before cleaning the appliance.
8. To disconnect, ensure the appliance switch is set to off, turn off the wall power outlet, then grasp and pull the plug from the wall outlet. Never pull by the cord.
9. Do not operate this appliance with a damaged cord/plug or after the appliance has been dropped, damaged or has malfunctioned in any manner. Contact customer service for replacement, examination, repair or adjustment.
10. There are no user serviceable parts. If the power cord or appliance is damaged, it must be repaired or replaced by the manufacturer or a suitably qualified person in order to avoid hazard.
11. The use of attachments/accessories not recommended by the appliance manufacturer may cause injuries or damage to the appliance and void warranty.
12. Do not use on an inclined plane or unstable surface.
13. Keep the appliance and the power cord away from the edge of tables or countertops and out of reach of children and persons with reduced physical, sensory and mental capacities.
14. Before switching on, ensure the bottle has been assembled correctly and has been seated onto the motor unit. The motor will only operate if the bottle has been properly seated onto the motor unit.
15. Care must be taken when handling any accessories with sharp edges. Cutting blades are very sharp. Handle with extreme care and caution when removing from the bottle and during cleaning.
16. Do not operate the appliance with an empty bottle.
17. CAUTION: Do not blend hot/warm ingredients - always allow to cool to room temperature before blending. Heated ingredients can be ejected out the appliance due to sudden steaming.
18. Wait until the blades come to a complete stop before removing the bottle from the motor unit.
19. Do not run the motor for longer than 1 minute. After 1 minute, switch off for at least 1 minute to allow the motor to cool down.
20. Switch off and unplug the appliance before changing accessories or touching parts that move whilst in use.
21. Do not attempt to defeat any safety interlock mechanisms.
22. To prevent possible damage to the appliance do not use harsh abrasive or alkaline cleaning agents.
23. Always clean the appliance after use.
24. Follow the instructions when cleaning this appliance.



25. Do not place on or near any heat sources.
26. Misuse of the appliance may cause injury.
27. Do not leave the appliance unattended when in use.
28. Do not use appliance for other than its intended purpose.
29. This appliance is not intended to be operated by means of an external timer or separate remote control system.
30. For added safety, electrical appliances should be connected to a power outlet that is protected by a residual current device (RCD / 'Safety Switch') having a rated residual operating current not exceeding 30mA. Your switchboard may already incorporate an RCD. If unsure, call an electrician for verification and fitting if necessary.
31. This appliance is intended to be used in household and similar applications such as:
 - Staff kitchen areas in shops, offices and other working environments;
 - Farm houses;
 - By clients in hotels, motels, and other residential type environments;
 - Bed & breakfast type environments.

SAVE THESE INSTRUCTIONS

Congratulations on the purchase of your new Russell Hobbs Power Boost Blender. Each unit is manufactured to ensure safety and reliability. **Before using the Blender for the first time, please read this instruction booklet carefully and keep it for future reference.** Pass it on if you pass on the appliance.

When using this appliance, basic safety precautions should always be followed.

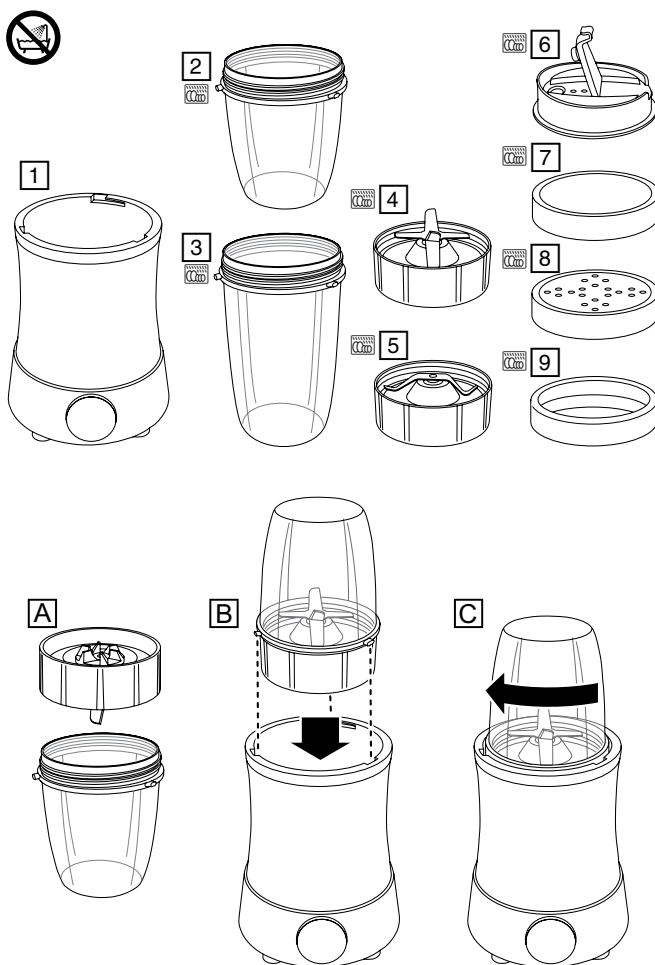

FEATURES

- | | |
|----------------------------|---|
| 1. Motor unit | 6. Travel lid with spout (x2) |
| 2. Small cup (x2) | 7. Solid lid (x2) |
| 3. Large cup (x3) | 8. Shaker lid |
| 4. 6-point blending blade | 9. Lip ring (x2) |
| 5. Serrated grinding blade |  Dishwasher safe |

BEFORE USING FOR THE FIRST TIME

- Clean the appliance before using it for the first time.
- Remove any packaging material and labels.
- Wash everything except the motor unit in warm, soapy water. Rinse and dry.
- Wipe the motor unit with a damp cloth.
- Place the appliance on a dry, firm, level surface, near a power socket.

BLADES

- 6-point blending blade - suitable for blending smoothies, soups, sauces, purées, etc.
- Serrated grinding blade - suitable for grinding harder ingredients like coffee beans, nuts, chocolate, spices, etc.

LIDS

- Travel lid with spout - screw-on lid with opening spout suitable for drinks on-the-go or storage.
- Solid lid - screw-on lid suitable for storing processed ingredients
- Shaker lid - screw-on lid with holes suitable for serving grated cheese, chocolate, spices, etc.
- Lip ring - push-on ring which can be fitted to the large or small cups to cover the screw thread for comfort.

USING

1. Add the ingredients to the small or large cup. Don't exceed the max mark.
2. Screw the desired blade onto the cup and tighten firmly (FIG A).
3. Invert the cup and align the three tabs with the slots in the motor unit (FIG B). Lower the cup assembly into the motor unit.
4. Turn the cup assembly clockwise to start the motor (FIG C).
5. Turn the cup assembly anti-clockwise to stop the motor.

TIPS

- The motor is powerful and operates quickly. Use short controlled bursts so that ingredients aren't over processed.
- Sometimes during processing, the ingredients clump together. If this happens, remove the cup from the motor unit and shake it. Refit the cup to the motor unit and carry on processing.
- Cut your ingredients and hard food such as cinnamon into small pieces before processing. Large pieces may jam the blade and result in damage to the appliance.
- Chocolate, nuts, and cheese will chop/grind better if thoroughly chilled first.

CLEANING

1. Unplug the appliance.
2. Dissassemble the appliance.
3. Wipe the outside of the motor unit with a clean damp cloth.
4. Wash the removable parts in warm soapy water, rinse well, drain, and air dry.



You may wash these parts in a dishwasher.

If you use a dishwasher, the harsh environment inside the dishwasher will affect the surface finishes. Damage should be cosmetic only, and should not affect the operation of the appliance.

Legislation in some localities mandates that e-waste (anything with a plug, battery or cord) is disposed of through controlled recycling facilities and must not be disposed of in general household waste. For more information about recycling of electrical and battery operated appliances, please contact your local council or your local household waste disposal service.

Spectrum Brands Australia Pty Ltd

Locked Bag 3004 Braeside
Victoria 3195 Australia

Customer Service in Australia

TollFree: 1800 623 118

Email: info@spectrumbrands.com.au

Website: www.spectrumbrands.com.au

Spectrum Brands New Zealand Ltd

PO Box 9817 Newmarket
Auckland 1149 New Zealand

Customer Service in New Zealand

TollFree: 0800 736 776

Email: service@spectrumbrands.co.nz

Website: www.spectrumbrands.co.nz

Spectrum Brands Australia Pty Ltd and Spectrum Brands New Zealand Ltd Warranty Against Defects

In this warranty:

Australian Consumer Law means the Australian consumer law set out in Schedule 2 to the Competition and Consumer Act 2010;

CGA means the New Zealand Consumer Guarantees Act 1993;

Goods means the product or equipment which was accompanied by this warranty and purchased in Australia or New Zealand, as the case may be;

Manufacturer, We or us means:

1. for Goods purchased in Australia, Spectrum Brands Australia Pty Ltd ABN, 78 007 070 573; or
2. for Goods purchased in New Zealand, Spectrum Brands New Zealand Ltd, as the case may be, contact details as set out at the end of this warranty;

Supplier means the authorised distributor or retailer of the Goods that sold you the Goods in Australia or in New Zealand; and

You means you, the original end-user purchaser of the Goods.

1. Our goods come with guarantees that cannot be excluded under the Australian Consumer Law, or the CGA. You are entitled to a replacement or refund for a major failure and compensation for any other reasonably foreseeable loss or damage. You are also entitled to have the goods repaired or replaced if the goods fail to be of acceptable quality and the failure does not amount to a major failure.
2. The benefits provided by this Warranty are in addition to all other rights and remedies in respect of the Goods which the consumer has under either the Australian Consumer Law or the CGA. The original purchaser of the Goods is provided with the following Warranty subject to the Warranty Conditions:
3. We warrant the Goods for all parts defective in workmanship or materials for a **(Warranty Period)** period of 2 years from the date of purchase.

If the Goods prove defective within the Warranty Period by reason of improper workmanship or material, we may, at our own discretion, repair or replace the Goods without charge.

Warranty Conditions

4. The Goods must be used in accordance with the manufacturer's instructions. This Warranty does not apply should the defect in or failure of the Goods be attributable to misuse, abuse, accident or non-observance of manufacturer's instructions on the part of the user. As far as the law permits, the manufacturer does not accept liability for any direct or consequential loss, damage or other expense caused by or arising out of any failure to use the Goods in accordance with the manufacturer's instructions.
5. Exhaustible components (such as batteries, filters and brushes) of the Goods are included under this Warranty only where there is a defect in workmanship or materials used.
6. The warranty granted under clause 3 is limited to repair or replacement only.
7. Any parts of the Goods replaced during repairs or any product replaced remain the property of the manufacturer. In the event of the Goods being replaced during the Warranty Period, the warranty on the replacement Goods will expire on the same date as for the Warranty Period on the original Goods which are replaced.
8. In order to claim under the warranty granted under clause 3 you must:
 - (a) Retain this warranty with your receipt/proof of purchase; and
 - (b) Return the Goods to us at the relevant address or to the Supplier by prepaid freight within the Warranty Period accompanied with (i) the legible and unmodified original proof of purchase, which clearly indicates the name and address of the Supplier, the date and place of purchase, the product name or other product serial number and (ii) this warranty.
9. This warranty is immediately void if:
 - (a) Any serial number or appliance plate is removed or defaced;
 - (b) The Goods have been serviced or otherwise repaired by a person not authorised to do so by us or where non approved replaced parts are used.
10. The Goods are designed for domestic use only. The Goods must be connected to the electrical voltage requirements as specified in the ratings label located on the Goods.
11. This warranty does not cover the cost of claiming under the warranty or transport of the Goods to and from the Supplier or us.
12. This warranty is only valid and enforceable in Australia against Spectrum Brands Australia Pty Ltd and in New Zealand against Spectrum Brands New Zealand Ltd.

Contact us or the Supplier for further details.

Register your product online

If you live in Australia please visit: www.spectrumbrands.com.au/warranty

If you live in New Zealand Please visit: www.spectrumbrands.co.nz/warranty

Registration of your warranty is not compulsory, it gives us a record of your purchase AND entitles you to receive these benefits: Product information; Hints and tips; Recipes and news; Information on special price offers and promotions.

Any questions? Please contact Customer Service for advice.



Russell Hobbs



POWER BOOST BLENDER

2 YEAR WARRANTY

RHBL700

RECIPE BOOK

LEEK AND POTATO SOUP

Ingredients:

75g leeks
75g potatoes
1 stock cube
400ml water
Salt and pepper

Method:

1. Process the leeks and potatoes for 2 seconds and transfer to a large pan.
2. Add the water and stock cubes. Bring to the boil, stirring. Reduce the heat and cover the pan. Simmer for 20 minutes.
3. Remove from the heat and cool for 30 minutes. Process till smooth.
4. Bring to serving temperature (don't let it boil) and adjust the seasoning. Serve with bread.

Note: For Vichyssoise, add a couple of chives to the leeks and potatoes, add a knob of butter to the pan before heating. Cool the soup instead of re-heating it, and whisk in 75ml of cream before serving it cold.

www.russellhobbs.com.au

www.russellhobbs.co.nz

RUSSELL HOBBS and logo are Trade Marks of Spectrum Brands, Inc., or one of its subsidiaries.
©2020 Spectrum Brands, Inc.

Recipes are to be used in conjunction with the RHBL700 Power Boost Blender by Russell Hobbs. All rights reserved. No part of this publication may be reproduced, stored in a retrieval system or transmitted in any form or by any means, electronic, mechanical, photocopying, recording or otherwise, without prior permission of the copyright owner.

SPICY PUMPKIN SOUP

Ingredients:

450g pumpkin
15ml vegetable oil
1 leek
1 garlic clove
450ml chicken/vegetable stock
2.5g ground ginger
15ml single cream/crème fraîche
2.5g ground coriander
1 bunch coriander leaves
Salt and pepper

Method:

1. Peel, deseed, and cut the pumpkin into chunks.
2. Heat the oil in a pan. Add the leeks, garlic and spices and stir for 3 minutes.
3. Add the stock and pumpkin. Bring to the boil, stirring. Reduce the heat. Cover the pan. Simmer for 20-30 minutes.
4. Remove from the heat and stir in the coriander and cream.
5. Cool for 30 minutes. Process till smooth (if required, process in batches). Bring to serving temperature (don't let it boil).
6. Adjust the seasoning. Serve with bread.

CORIANDER PESTO

Ingredients:

2 handfuls coriander leaves
2 cloves garlic
60g pine nuts
125ml olive oil
60g Parmesan, grated

Method:

1. Process the coriander, garlic, pine nuts and half the oil till smooth.
2. Transfer to a large bowl and stir in the Parmesan.
3. Add oil to adjust the consistency: For a dip: thick. For a topping: medium. For pasta sauce: thin.

FRUITY SMOOTHIES

Process everything till smooth.

Ingredients:

- 60ml yogurt
- 200ml milk
- 30g oatmeal
- 1 banana
- 30ml honey
- 2 apples, cored

Ingredients:

- 170g chocolate ice cream
- 300g orange juice

Ingredients:

- 150g hazelnut yogurt
- 1 banana
- 200ml milk

Ingredients:

- 300ml chocolate milk
- 2 pears, cored

Ingredients:

- 400ml milk
- 1 banana
- 20ml honey
- 10ml vanilla extract
- 200ml yogurt
- 1 mango, stone removed
- 200ml milk

Ingredients:

- 300ml orange juice
- 300ml cranberry juice
- 1 banana
- 5ml honey
- 300ml milk
- 1 banana
- 12 strawberries

Ingredients:

- 360ml lemonade
- 125g vanilla ice cream
- 70g blueberries

Ingredients:

- 4 halves of tinned apricot
- 80ml apricot juice (from tin)
- 2 peaches, stone removed
- 60ml yogurt
- 200ml milk
- 10ml honey

Ingredients:

- 600ml apple juice
- 1 mango, stone removed

Ingredients:

- 300ml apple juice
- 90g raspberries
- 12 strawberries

Ingredients:

- 400ml apple juice
- 1 kiwi fruit, peeled
- 150g melon

Ingredients:

- 350ml lemonade
- 125ml chocolate ice cream
- 100ml cherries, stones removed