



Russell Hobbs

Smart in the kitchen...



instructions

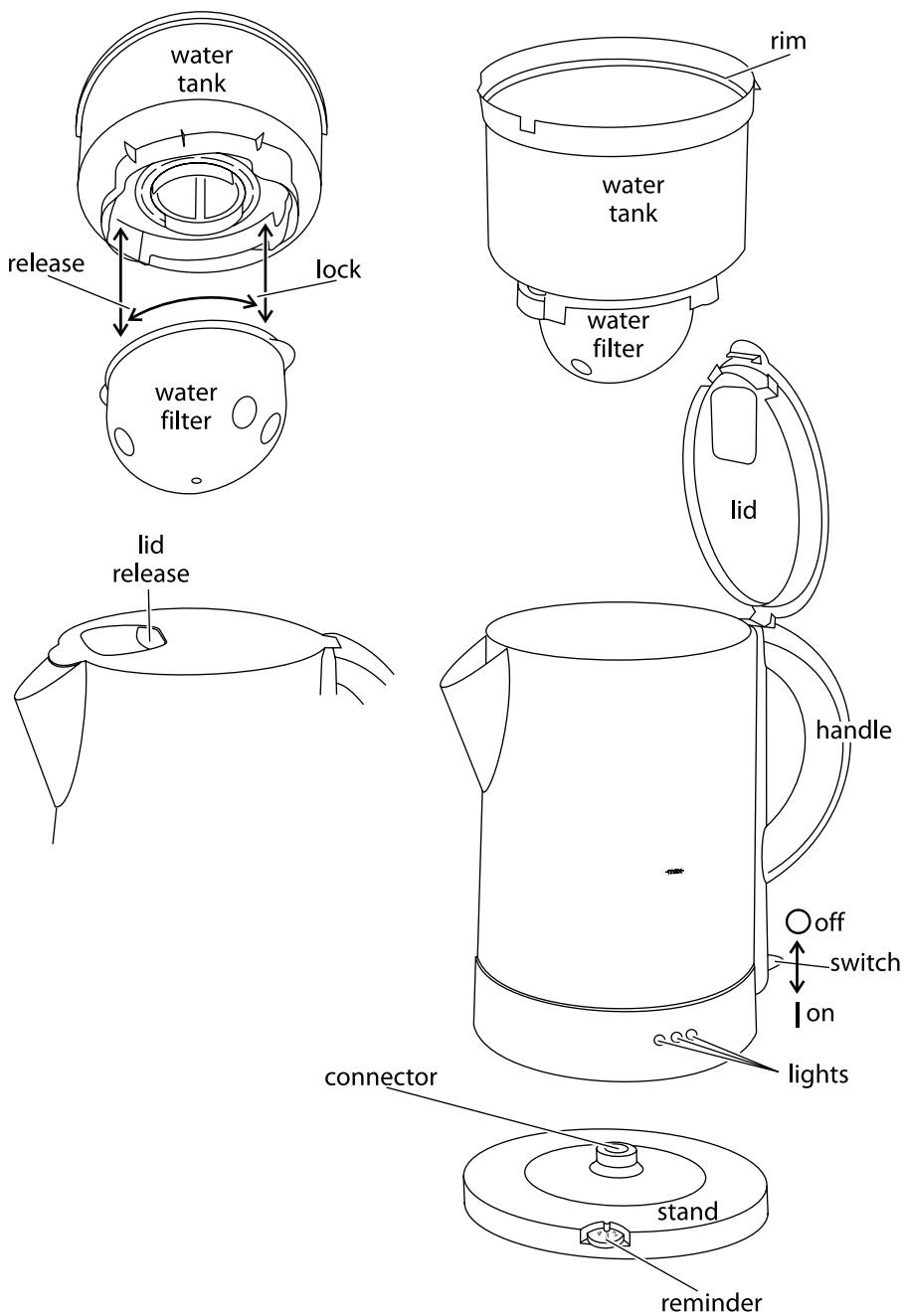

Read the instructions and keep them safe. If you pass the kettle on to anyone else, you should also pass on the instructions too.

Remove all packaging before using the kettle, but keep it till you're satisfied that the kettle is working.

important safeguards

When using electrical appliances, basic safety precautions should always be followed, including the following:

caution In common with most other water filters, this one releases generally harmless, low levels of potassium, and trace levels of silver. Anyone receiving medical treatment should mention this to their doctor.

- 1 This kettle must only be used by or under the supervision of a responsible adult.
- 2 Don't put the kettle, stand, cable, or plug in any liquid; don't use the kettle in a bathroom, near water, or outdoors.
- 3 Don't touch hot surfaces. Use the handle and lid release.
- 4 Don't open the lid while the water is heating.
- 5 Take care when pouring – pour slowly, and don't over-tilt the kettle.
- 6 Water can remain hot for a considerable time after boiling and can present a scald hazard. Keep the kettle, the stand, and the cable away from the edge of worktops and out of the reach of children.
- 7 Only filter cold water.
- 8 Consume filtered water within one to two days.
- 9 Route the cable so it doesn't overhang, and can't be tripped over or caught accidentally. Wind excess cable beneath the stand.
- 10 Unplug the stand when not in use, before moving and before cleaning. Let the kettle cool down before cleaning and storing away.
- 11 Check the lid is properly closed before switching the kettle on, otherwise it may not switch off.
- 12 Check the kettle is properly located on the stand before switching on.
- 13 Don't switch on unless the kettle contains at least 2 cups of water.
- 14 Don't fill past **max**, or water will be left in the water tank which can't be filtered.
- 15 Remove the kettle from its stand before filling or pouring.
- 16 Keep the kettle, stand, cable, and plug away from sources of heat.
- 17 We recommend boiling water for use in the preparation of baby food.
- 18 Don't use the kettle for any purpose other than heating and/or filtering water.
- 19 Use the kettle only with the stand supplied (and vice versa).
- 20 Don't operate the kettle if it's damaged or malfunctions. If the cable or stand is damaged, replace the stand, in order to avoid hazard.



household use only

water filter

The water filter contains ion exchange resin, and activated carbon to reduce the amount of nasties in the water. Together they reduce the amount of calcium carbonate (limescale), chlorine, herbicides, pesticides, fertilisers, bacteria, particles (e.g. sand, rust), odours, etc. Reducing the nasties in the water is better for you, and the reduction of limescale helps your kettle too.

why two filters?

You might have wondered why the kettle has two filters. The spout filter is there to catch any bits of scale that may have formed and broken free inside the kettle

cold or hot?

You can use the water filter to filter water for cold drinks too – just don't switch the kettle on. Perfect for those hot summer days when you don't fancy a cuppa. You don't need to buy a water filter jug, your kettle will do it all for you.

before using the kettle for first time.

- 1 Remove all packaging from the kettle and its stand.
- 2 Take the water tank and water filter out of the kettle, and remove any packaging.
- 3 Before using the kettle for the first time, or if it has been out of use for a long time, fill to max with cold water, close the lid, boil, discard the water, then rinse. Do this three times, to remove manufacturing dust, etc.

preparing the water filter

- 1 Remove all packaging from the water filter.
- 2 There might be black carbon particles in the packaging or on the water filter. Don't worry, they're harmless.
- 3 Wipe the outside of the water filter with a damp cloth. Don't use washing-up liquid, or anything that might leave a taint.
- 4 To ensure the water filter can work at its best, all air bubbles must be removed before use.
- 5 Submerge the water filter in a bowl of cold water and shake it. When no more bubbles are released, the water filter is ready. You may notice some black carbon particles floating around in the water, again don't worry, they're harmless.
- 6 Pull the seal off the water tank.
- 7 Clean the seal and water tank with a damp cloth. Don't use any washing-up liquid, or anything that might leave a taint.
- 8 Push the seal on to the water tank, the seal tabs fit into the slots.
- 9 Align the tabs on the water filter with the same shaped grooves under the water tank.
- 10 Push the water filter towards the water tank, then turn it to your right to lock it into the water tank.

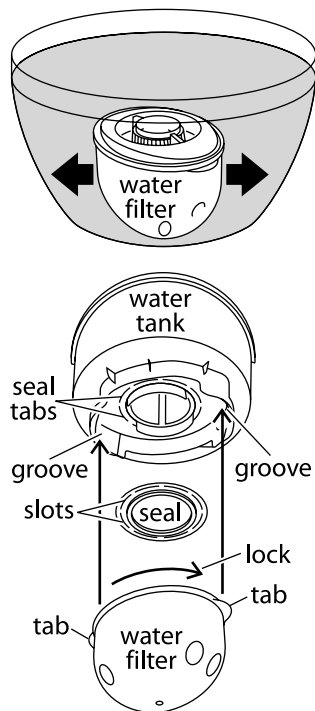

- 11 Squeeze the lid release, then lift it up and back, to open the lid.
- 12 Turn the water tank so the two cut-outs are located equally on each side of the spout.
- 13 Lower the water tank till it sits on the guides inside the kettle.
- 14 Quickly fill the water tank up to the rim, then allow the water to pass through the water filter. Discard the water. Do this twice, to clean the water filter.
- 15 Close the lid.
- 16 If the kettle hasn't been used for over 2 weeks, we recommend you:
 - Empty the kettle
 - Open the lid, take the water tank out of the kettle, turn the water filter to your left to release it from the water tank, then follow steps 3 to 15, to prepare the water filter.

filling

- 1 Put the stand on a stable, level surface. Route the cable so it doesn't overhang, and can't be caught or tripped over.

warning keep clear, steam may escape from the lid.

- 2 Check that the kettle is off – lift the switch up (○).
- 3 Remove the kettle from the stand.
- 4 Open the lid.
- 5 Fill the water tank with at least 2 cups of cold water, but don't fill over the rim, or the water will bypass the filter. This will give just over 1 litre of filtered water. If you want more, gently add more water to the water tank, keeping your eye on the rising water level in the kettle. Do not exceed the -max- mark.
- 6 Replace the lid and press down to lock it.
- 7 Don't let the filtered water in the kettle exceed the -max- (1.5 litre) mark. If it does, the water left in the water tank can't be filtered.
- 8 Check the lid is closed, otherwise the kettle may not switch off when it boils.

switching on

- 1 Check that the kettle is off – lift the switch up (○).
- 2 Plug the stand into the wall socket. If necessary, switch the socket on.
- 3 Gently position the kettle on the stand – take care not to spill any water.
- 4 Press the switch down |. The lights will come on, and the kettle will heat up.

nb You don't have to wait for the water to be filtered before switching the kettle on. Water passes through the water filter quickly, and all the water will be filtered before the kettle finishes boiling.

switching off

- 1 When the water has boiled, the kettle will switch off automatically, the switch will return to the "off" position (○), and the lights will go out.
- 2 To switch off manually, move the switch to ○, or lift the kettle off the stand.

the water filter

To ensure you get the best filtered water from your kettle, you have to change the water filter regularly. The water filter will filter 200 litres of water, which is approximately 8 weeks, for a typical family, in a hard water area. We recommend that the water filter is changed at least once every 10 weeks.

changing the water filter

- 1 Open the lid
- 2 Lift the water tank out of the kettle.
- 3 Hold the water tank and turn the water filter to your left, to release it from the water tank.
- 4 Discard the water filter.
- 5 Prepare the new water filter for use, as described on page 4.

the reminder

Remembering when to change the water filter is perhaps the hardest part.

Don't worry – we've thought of this.

We've built a reminder into the stand, so you know when next to change the water filter.

The reminder uses a number to represent each month of the year (e.g. 1 = January, 2 = February, etc). For example, if you want to change the water filter every month (4 weeks) and it's now April (4), change the water filter, then set the reminder to 5 (May). By looking at the reminder, you can tell you need to change the water filter in May.

general

When you lift the kettle from the stand, you may see moisture on the surface of the base. This is the steam used to switch the kettle off automatically, which then condenses and is allowed to escape via vents in the underside of the kettle. This is normal, and should be ignored.

You may notice discolouration of the coating on the floor of the kettle. This occurs during bonding of the element to the floor. It's unavoidable, harmless, and should be ignored.

Remove the kettle from the stand before pouring.

When filling or carrying the kettle, don't tilt it backwards, as this may allow water to pass through the steam aperture on to the control area. Should this occur, let the kettle dry before use – sit it somewhere warm for 12 hours.

To avoid the risk of splashing, pour slowly and don't over-tilt the kettle.

insufficient water

Don't switch the kettle on unless it contains at least two cups of water. Misuse of this kind will shorten the life of the element.

If the kettle is accidentally switched on when it doesn't contain sufficient water, a boil-dry device will automatically switch it off. Remove it from the stand and let it cool down fully before filling, as the element will be hot and spitting may occur.

care and maintenance

- 1 Switch the kettle off – lift the switch up (○), unplug the stand from the wall socket, and let the kettle cool down fully before cleaning.
- 2 Clean the water filter, water tank, and seal with a damp cloth. Don't use any washing-up liquid, or anything that might leave a taint.
- 3 Wipe the kettle, inside and out, with a damp cloth. If necessary, you may use a little household detergent. If you use detergent inside the kettle, rinse thoroughly afterwards to remove all trace of detergent, to avoid tainting the water.

Keep all connectors and sockets dry.

Don't put the kettle or stand in any liquid.

Don't use harsh or abrasive cleaning agents or solvents.

descaling

The water filter will help to reduce limescale and phosphate scale in your kettle. But you should still check the kettle frequently for signs of scale, even in soft water areas.

Limescale may be white, coloured, even rusty-looking, but it's normally visible.

Phosphate scale isn't generally visible, but it's there, even in soft water areas.

All scale causes overheating, reduces the kettle's life, and may trigger the boil-dry cut-out.

If you need to use a descaler remove the water filter first – the descaler will damage it.

Use a descaler suitable for plastic products (all kettles have plastic parts). Follow the instructions on the descaler, rinse several times, then fill, boil and discard the water, to ensure no residues are left. Then replace the water filter.

cleaning the spout and lid filter

The spout filter is not meant to be removed from the kettle.

Switch the kettle off – move the switch up (○), unplug the stand from the wall socket, and let the kettle cool down fully before cleaning.

Empty the kettle

Check your hands are free from soap, or anything which might leave a taint.

Rinse the filter under a running tap while brushing with a soft brush.

Rinse the kettle out with fresh water, in case scale particles have fallen inside.

connection

The product must be earthed. It has a 13A BS1362 fuse in a 13A BS1363 plug. To replace the plug, fit the green/yellow wire to ⊕ or E, the blue wire to N, and the brown wire to L. Fit the cord grip.

If in doubt, call an electrician.

Don't use a non-rewireable/moulded plug unless the fuse cover is in place. If you remove the plug, dispose of it.

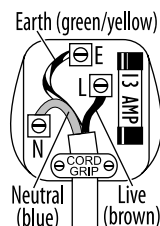

spare parts

Note the Model No (on the rating label) and the parts you need, ring 0845 658 9700 or email service@saltoneurope.com for prices, then purchase using VISA or MASTERCARD.

service

The product isn't user-serviceable. If it's not working, read the instructions, check the plug fuse and main fuse/circuit breaker. If it's still not working, consult your retailer. If that doesn't solve the problem:

Pack carefully, with a note of your name, address, day phone number, and what's wrong. If under guarantee, say where and when purchased, and include proof of purchase (till receipt). Send it to Customer Returns (address below right). They'll give you an estimate for inspection/repair.

Customer Service

(correspondence only)
Salton Europe Ltd
Failsworth
Manchester
M35 0HS

Customer Returns

Salton Europe Ltd
Heath Mill Road
Wombourne
Wolverhampton
WV5 8AQ

Customer Service (service@saltoneurope.com)
telephone 0845 658 9700 (local rate number)

guarantee

Defects affecting product functionality appearing within one year of purchase will be corrected by replacement or repair provided the product is used and maintained in accordance with the instructions. Your statutory rights are not affected. Documentation, packaging, and product specifications may change without notice.