



Russell Hobbs



instructions, troubleshooting guide, and guarantee

Problems?

Don't take it back to the shop,
they won't be able to fix it.

Ring the helpline

0845 658 9700

it's a local rate number

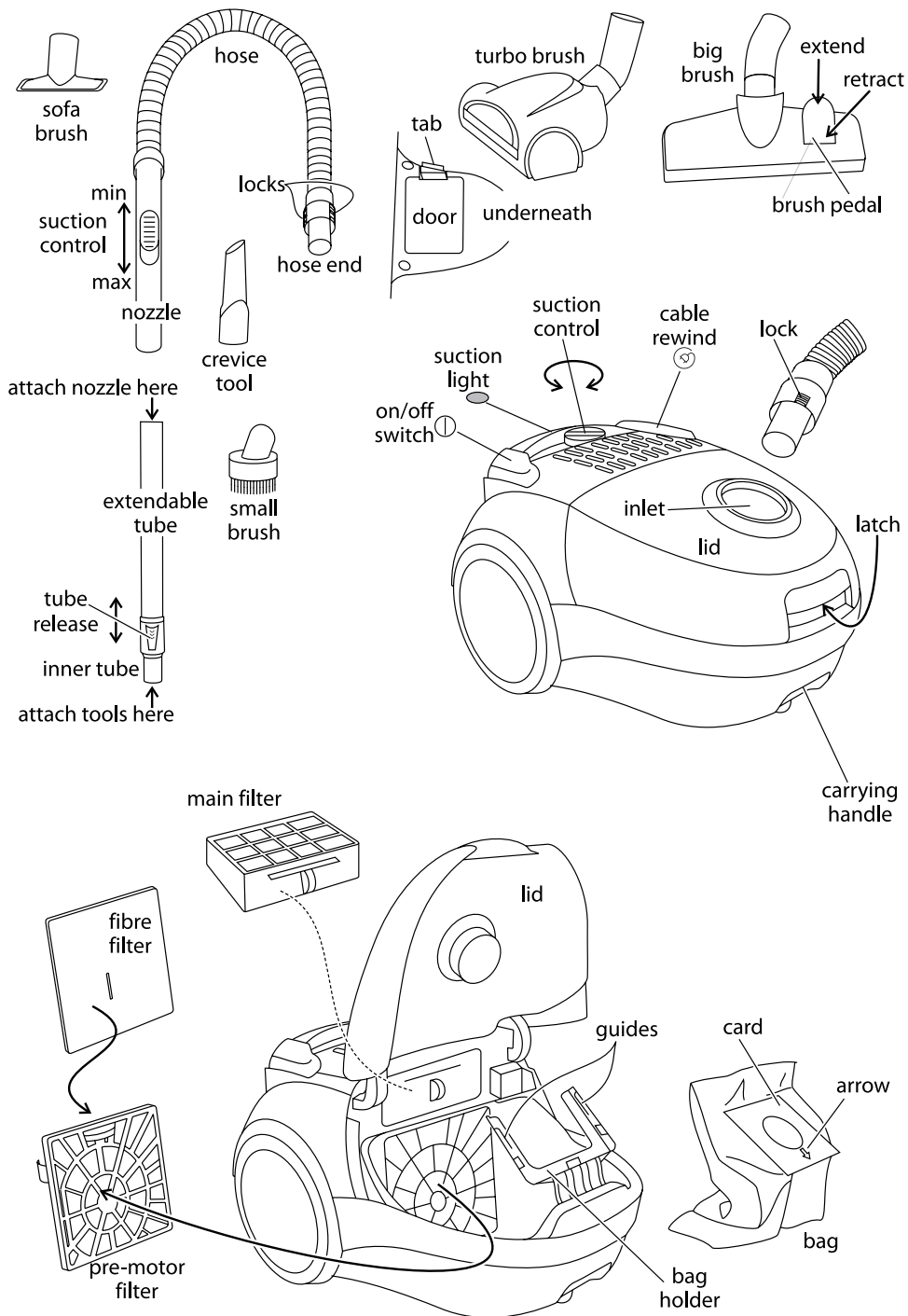

Read the instructions before using your vacuum cleaner, and keep them safe.

If you pass the cleaner on, pass on the instructions too.

important safeguards

Follow basic safety precautions, including the ones below. It's quite a list, but most of them are simple common sense.

- 1 The cleaner should only be used by or under the supervision of a responsible adult.
- 2 Don't put the cleaner in any liquid, and don't use it anywhere damp or wet.
- 3 Don't use the cleaner near a gas, oil (including paraffin), or open fire. The flame may be sucked towards the cleaner, causing a fire hazard.
- 4 Keep hair, clothing, fingers (and toes), away from the end doing the sucking, and from the brush. It won't drag you into the cleaner, but it may give you a bit of a start.
- 5 Stuff you mustn't pick up:
 - a) don't pick up any liquid – you'll short the motor
 - b) don't pick up stuff that may ignite spontaneously, like matches, bits of fire-lighter
 - c) don't pick up anything burning or smouldering, like cigarette ends, ashes, or embers – wait till they're extinguished and cold
 - d) don't pick up spillage from toner cartridges – the fine carbon particles may pass through the filter, short circuit the motor, and burn it out
 - e) don't pick up cement or plaster dust – they'll combine with moisture in the air, clog the filter, burst the bag, and maybe burn out the motor too
 - f) don't pick up anything sharp – you may puncture the filter and damage the motor
 - g) don't pick up anything biological – you'll eventually have to clean it off the filter, and there's always the possibility that viral particles may pass through the filter, reach the air outlet, and enter your air supply
- 6 If you use the cleaner outdoors (e.g. cleaning the car), connect it to the electricity supply via a residual current device (RCD), with a rated residual operating current not exceeding 30mA. Don't let the cleaner get wet.
- 7 Store and use the cleaner out of reach of children.
- 8 Don't leave it unattended when plugged in.
- 9 Keep an eye on the cable, so it doesn't catch on anything, or trip anyone up. Don't run the cleaner over the cable, you'll damage it.
- 10 If you're using the cleaner on stairs, sit it where it can't topple, and keep it below you, so if it does topple, it won't land on you.
- 11 Don't use the cleaner on people, animals, birds, or pets.
- 12 Unplug the cleaner and rewind the cable when not in use, before moving and before cleaning.
- 13 Don't use the cleaner if the bag is full – switch off, unplug, and replace it.
- 14 Don't use the cleaner for any purpose other than those described in these instructions.
- 15 Don't use accessories or attachments other than those we provide.
- 16 Don't leave the cleaner in sunlight, prolonged exposure to UV may damage plastics.
- 17 Don't use the cleaner if it's damaged or malfunctions.
- 18 If the cable or plug is damaged, return the cleaner, to avoid hazard.



household use only

before using for the first time

Remove the packaging, but keep it till you're sure the cleaner is working properly.

count the bits

In the box you'll find an extendable tube, a big brush, a turbo brush, a hose (with nozzle), a sofa brush, a crevice tool, a small brush, and spare bags. They may be packed separately, so check the packaging before you dispose of it.

fitting the hose

- 1 Push the hose end into the inlet. You'll hear a click as it locks into position.
- 2 Give it a gentle tug to check it's fitted properly.

cable

- 3 Pull as much cable as you need from the back of the cleaner.
- 4 There's a yellow band round the cable to show there's about a metre left.
- 5 There's a red band half a metre later. This means "Stop pulling, you've run out of cable!".
- 6 Keep an eye on the cable so it doesn't catch on anything, or trip anyone (including you).

carrying and moving the cleaner

- 7 Lift the cleaner only by the carrying handle.
- 8 When the cleaner is sitting on its wheels (normal position), you can move it around by pulling gently (that's gently), on the hose.
- 9 For stationary jobs like curtains, you may sit the cleaner upright, with the handle uppermost, but don't try to move it around like this, it'll fall over.



choose the tool for the job

- 10 The tools will fit on the nozzle, or on the narrow end of either tube.
- 11 You'll have your own preferences, but here are a few tips for the first time user.
 - big brush** normally used with the extendable tube, for floors and carpets:
Press the rear of the brush pedal to extend the bristles for floor coverings with little or no pile.
Press the front of the brush pedal to retract the bristles for use on rugs, carpets, and anything with pile.
 - turbo brush** normally used with the extendable tube for floors and carpets, this has a rotating brush, powered by suction, for deeper cleaning.
 - crevice tool** as the name implies, down the sides of upholstery, in awkward spaces, nooks, and crannies nothing else can reach.
 - small brush** use it to remove pet hair, lint, and dust from blinds, and curtains, and to brush/clean awkward corners.
 - sofa brush** use this to remove pet hair, lint, and dust from upholstery, and other small, flat areas – don't use it on hanging curtains, as it doesn't have the bristles necessary to let air flow freely, use the small brush instead.
- 12 We suggest the big brush for the daily clean, the turbo for the weekly deep clean.

extendable tube

- 13 Fit the extendable tube to the nozzle for floors, carpets, or hard to reach places:
 - a) push the tube release towards the narrow end of the tube, and keep it pressed
 - b) pull out as much of the inner tube as you need – if you're done, push it back
 - c) return the tube release to the locked position
- 14 Push the wide end of the extendable tube on to the nozzle.
- 15 Choose a tool, and push it onto the narrow end of the tube.

suction control

- 16 There are two ways to control the suction:
 - a) The suction control on the top rear of the cleaner – slide it towards max to increase the cleaning power, towards min to decrease the power.
 - b) The suction control on the nozzle – move it towards the nozzle for maximum suction, away from the nozzle, to reduce suction.

plug in

caution If you've accidentally pressed the on/off switch, the cleaner could come on when you plug it in. This could give you a bit of a start, so be careful.

- 17 Plug the cable into a socket near the area to be cleaned (switch the socket on, if it's switchable).

switching on

- 18 Press and release the on/off switch ①, to turn the cleaner on.

cleaning

- 19 Move the tool over the surface, cleaning a small area at a time.
20 When you move to a new area, overlap the previous area, to make sure none of the surface is missed.

switching off

- 21 If you've finished, if you want to change tools, or if you just want to stop, press and release the on/off switch ①, to turn the cleaner off.

finished cleaning?

- 22 Press and release the on/off switch ①, to turn the cleaner off.
23 Unplug the cleaner.
24 Stand clear of the cable, and press the cable rewind button ⑤, the cable will rewind.
25 Keep clear of the cable, as it rewinds at a fair lick. If it catches on anything, stop pressing, and it'll stop rewinding.
26 We've tried not to make it too powerful, to avoid wrecking your home, so you may need to push the plug end into the storage area manually.

suction light

- 27 The suction light on top of the cleaner, between the handle and the rear cover monitors the amount of suction available to the cleaner.
28 It glows when the cleaner is stressed, then goes out as the stress is removed.
a) unless it glows steadily, you needn't worry about it
b) it'll flicker while you're cleaning, as the load on the motor changes
c) it'll pulse when you're using the turbo brush, as the load varies more with this brush
d) it'll glow steadily if you block the end of the hose – moving the hose will cure this
e) it'll glow steadily if you let the bin get full – stop and empty it
f) it'll glow steadily if there's a blockage – stop and clear the blockage

remove the bag

- 29 You don't have to replace the bag after each use, but you do have to keep an eye on the suction light, and change the bag when it's full, otherwise you'll choke the cleaner.
30 Switch off, unplug, and leave the cleaner for a minute, to let the dust settle.
31 Squeeze the locks on either side of the hose end, and pull the hose out of the cleaner – this'll keep the hose out of your way.
32 Squeeze the latch towards the lid, then raise the lid, to expose the bag.
33 Grip the card part of the bag, slide it out of the bag holder, then lower the bag gently into the dustbin..
★ Try not to handle the bag itself – if you squeeze it, you'll eject the contents over your newly cleaned floor.
34 Don't try to empty the bag and reuse it. The bag takes quite a pounding from the suction of the cleaner, and from the dust and dirt hitting its walls. Oils from your skin will weaken it further, so it might burst inside the cleaner.

check the pre-motor filter

35 While the bag's out of the way, you should check the pre-motor filter.

36 Pull the filter away from the rear of the bag compartment.

37 If the filter looks a bit mucky, tap it over the dustbin, to dislodge the dirt.

38 If it's very dirty:

- a) gently pull the fibre filter out of the pre-motor filter
- b) soak it in warm soapy water
- c) swill it out under a running tap, to remove all trace of soap
- d) let it air dry, till it's completely dry, before replacing it in the pre-motor filter
- e) the slit in the fibre filter fits over the "C"-shaped grip on the rear of the pre-motor filter
- f) replace the pre-motor filter against the rear of the bag compartment, and push it till it clicks into place

check the main filter

39 the main filter is in a drawer above the pre-motor filter.

40 Pull it out of its drawer.

41 If the filter looks a bit mucky, tap it over the dustbin, to dislodge the dirt.

42 If it's very dirty:

- a) soak it in warm soapy water
- b) swill it out under a running tap, to remove all trace of soap
- c) let it air dry, till it's completely dry, before replacing it in the cleaner

43 Replace the filter in its drawer.

fit the new bag

44 Hold the new bag by the card.

45 Slide the card into the bag holder, under the guides.

46 Close the lid – you should hear the latch click into place, to secure it.

47 Push the hose end into the inlet. You'll hear a click as it locks into position.

48 Give it a gentle tug to check it's fitted properly.

cleaning the cleaner

49 Switch the cleaner off and unplug it before cleaning.

50 Don't put any part of the cleaner in a dishwasher.

51 Don't use harsh or abrasive cleaning agents or solvents.

52 Wipe external surfaces with a damp cloth. A dab of washing-up liquid will remove stubborn stains, but clean it off afterwards, or it may stain.

53 Wipe the tube, hose, and tools with a damp cloth.

turbo brush

54 Threads and hair may block the turbine.

55 Turn the turbo brush over, press the tab, and remove the door, to check the turbine.

56 Replace the door before using the turbo brush.

timing

57 Clean the cleaner frequently. Basically, the better you look after it, the longer it'll last. Keep an eye on it as you use it, and examine the filters when you replace the bag. If anything needs cleaning, do it there and then, don't put it off, in case you forget.

blockages

No matter how careful you are, sooner or later you'll block the cleaner.

don't panic!

If the cleaner starts to get noisy and you start to lose suction, don't worry, it's not the end of the world, you've probably just blocked it up.

- 1 Switch the cleaner off and unplug it.

- 2 Spread a newspaper on the floor, you're probably going to make a mess.
- 3 If you're using one of the tools, remove and check it first.
- 4 Remove the hose out and check it's clear.
- 5 If there is a blockage use a blunt object such as a finger, or blunt end of a ball-point pen to dislodge it, don't use anything sharp.
- 6 Open the lid, carefully remove the bag, and check the pre-motor filter.
- 7 Check the main filter.
- 8 If you haven't cleared the blockage by now, try again.
- 9 Still not clear? – Ring the helpline.

connection

The cleaner doesn't need an earth. It has a 13A BS1362 fuse in a 13A BS1363 plug. To replace the plug, fit the blue wire to N, and the brown wire to L. Fit the cord grip. If in doubt, call an electrician.

Don't use a non-rewireable/moulded plug unless the fuse cover is in place. If you remove the plug, dispose of it.

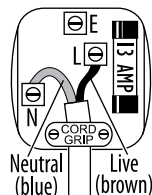

helpline – 0845 658 9700

If you need help, note the Model No (on the rating plate) and ring the helpline 0845 658 9700 (it's a local rate number).

spare parts

Note the Model No (on the rating plate) and the part(s) you need, then ring the helpline – 0845 658 9700, or email service@saltoneurope.com for price(s). You may then order spares with VISA or MASTERCARD.

service

If you ring Customer Service, please have the **Model No.** to hand, as we won't be able to help you without it. It's on the rating plate (usually underneath the product).

The cleaner isn't user-serviceable. If it's not working, read the instructions, check the plug fuse and main fuse/circuit breaker.

If that doesn't solve the problem, don't take the cleaner back to the place you bought it – they won't be able to fix it. Ring Customer Service.

If they advise you to return the product to us, pack it carefully, include a note with your name, address, day phone number, and what's wrong. If under guarantee, say where and when purchased, and include proof of purchase (till receipt). Send it to:

Customer Service, Russell Hobbs Ltd, Fir Street, Failsworth, Manchester M35 0HS

email: service@russellhobbs.com

telephone: 0845 658 9700 (local rate number)

guarantee

Defects affecting product functionality appearing within one year of purchase will be corrected by replacement or repair provided the product is used and maintained in accordance with the instructions. Your statutory rights are not affected. Documentation, packaging, and product specifications may change without notice.

wheelie bin symbol

To avoid environmental and health problems due to hazardous substances in electrical and electronic goods, appliances marked with this symbol mustn't be disposed of with unsorted municipal waste, but recovered, reused, or recycled.



online

www.russellhobbs.co.uk for more products