



Russell Hobbs



instructions, troubleshooting guide, and guarantee

Problems?

Don't take it back to the shop,
they won't be able to fix it.

Ring the helpline

0845 658 9700

it's a local rate number

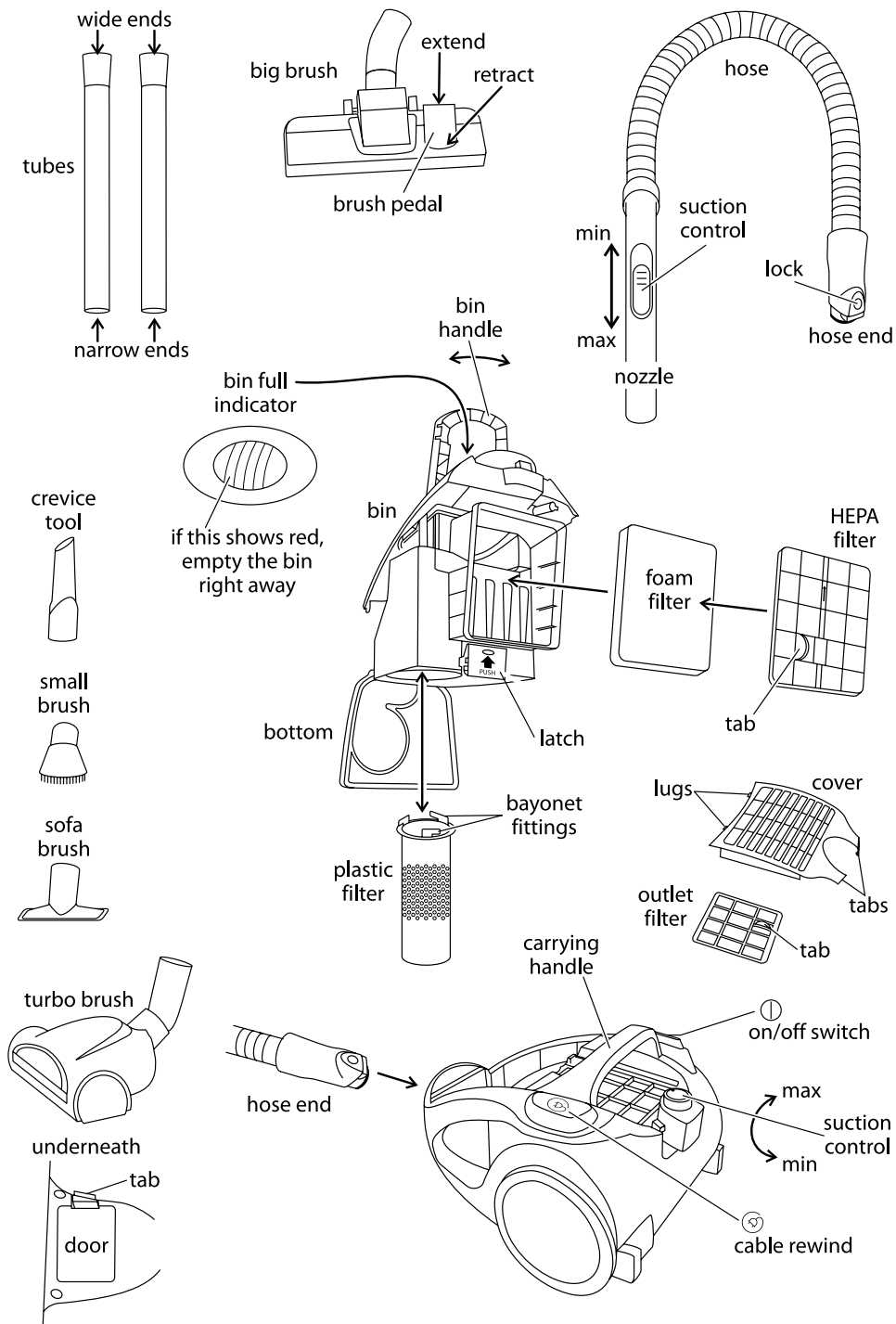

Read the instructions before using your vacuum cleaner, and keep them safe.

If you pass the cleaner on, pass on the instructions too.

important safeguards

Follow basic safety precautions, including the ones below. It's quite a list, but most of them are simple common sense.

- 1 The cleaner should only be used by or under the supervision of a responsible adult. It's not a toy – don't let children play with it.
- 2 Don't put the cleaner in any liquid, and don't use it anywhere damp or wet.
- 3 Don't use the cleaner near a gas, oil (including paraffin), or open fire. The flame may be sucked towards the cleaner, causing a fire hazard.
- 4 Keep hair, clothing, fingers (and toes), away from the end doing the sucking, and from the brush. It won't drag you into the bin, but it may give you a bit of a start.
- 5 Stuff you mustn't pick up:
 - a) don't pick up any liquid – you'll short the motor
 - b) don't pick up stuff that may ignite spontaneously, like matches, bits of fire-lighter
 - c) don't pick up anything burning or smouldering, like cigarette ends, ashes, or embers – wait till they're extinguished and cold
 - d) don't pick up spillage from toner cartridges – the fine carbon particles may pass through the filter, short circuit the motor, and burn it out
 - e) don't pick up cement or plaster dust – they'll combine with moisture in the air, clog the filter, scour the bin, and maybe burn out the motor too
 - f) don't pick up anything sharp – you may puncture the filter and damage the motor
 - g) don't pick up anything biological – you'll eventually have to clean it off the filter, and there's always the possibility that viral particles may pass through the filter, reach the air outlet, and enter your air supply
- 6 If you use the cleaner outdoors (e.g. cleaning the car), connect it to the electricity supply via a residual current device (RCD), with a rated residual operating current not exceeding 30mA. Don't let the cleaner get wet.
- 7 Don't leave it unattended when plugged in.
- 8 Keep an eye on the cable, so it doesn't catch on anything, or trip anyone up. Don't run the cleaner over the cable, you'll damage it.
- 9 If you're using the cleaner on stairs, sit it where it can't topple, and keep it below you, so if it does topple, it won't land on you.
- 10 Don't use the cleaner on people, animals, birds, or pets.
- 11 Unplug the cleaner and rewind the cable when not in use, before moving and before cleaning.
- 12 Don't use the cleaner if the bin is full – switch off, unplug, and empty it.
- 13 Don't use the cleaner for any purpose other than those described in these instructions.
- 14 Don't use accessories or attachments other than those we provide.
- 15 Don't leave the cleaner in sunlight, prolonged exposure to UV may damage plastics.
- 16 Don't use the cleaner if it's damaged or malfunctions. If the cable or plug is damaged, the cleaner must be returned in order to avoid hazard.



household use only

before using for the first time

Remove the packaging, but keep it till you're sure the cleaner is working properly.

count the bits

In the box you'll find two tubes, a turbo brush, a big brush, a crevice tool, a small brush, and a hose (with nozzle). They may be packed separately, so check all of the packaging before you dispose of it.

filters

Keep the filters clean – if they get blocked, you'll lose suction rapidly.

fitting the hose

- 1 Turn the hose end, to align the lock with the inlet in the front of the cleaner.
- 2 Push the hose end into the inlet. You'll hear a click as it locks into position.
- 3 Give it a gentle tug to check it's fitted properly.

cable

- 4 Pull as much cable as you need from the back of the cleaner.
- 5 There's a yellow band round the cable to show there's about a metre left.
- 6 There's a red band about half a metre later. This means "Stop pulling, you've run out of cable!".
- 7 Keep an eye on the cable so it doesn't catch on anything, and doesn't trip anyone (including you).

carrying and moving the cleaner

- 8 Lift the cleaner only by the carrying handle.
- 9 When you lower the cleaner, make sure it's sitting on the floor before you let the handle go – this might sound obvious, but with such a small cleaner you might be tempted to drop it a little, instead of bending down. Don't – you'll damage it.
- 10 When the cleaner is sitting on its wheels (normal position), you can move it around by pulling gently (that's gently), on the hose.
- 11 For stationary jobs like curtains, you may sit the cleaner up, with the hose at the top, but don't try to move it like this, or it'll fall over.

choose the tool for the job

- 12 The tools will fit on the nozzle, or on the narrow end of either tube.
- 13 You'll have your own preferences, but here are few tips for the first time user.
 - big brush** normally used with the extendable tube, for floors and carpets:
Press the rear of the brush pedal to extend the bristles for hard floors, or floor coverings without pile.
Press the front of the brush pedal to retract the bristles for use on rugs, carpets, and anything with pile.
 - turbo brush** normally used with the extendable tube, for floors and carpets, this has a rotating brush, powered by suction, for deeper cleaning.
Close the vent on top of the brush for use on floors without carpet, or carpet with short pile; open it for rugs and long pile carpets
 - crevice tool** as the name implies, down the sides of upholstery, in awkward spaces, nooks, and crannies nothing else can reach.
 - small brush** use it to remove pet hair, lint, and dust from blinds, and curtains, and to brush/clean awkward corners.
 - sofa brush** use this to remove pet hair, lint, and dust from upholstery, and other small, flat areas – don't use it on hanging curtains, as it doesn't have the bristles necessary to let air flow freely, use the small brush instead.
- 14 We suggest the big brush for the daily clean, the turbo for the weekly deep clean.

tubes

- 15 The tubes are identical. The narrow end of a tube will fit into the wide end of the other tube, or into to any of the tools, to provide extra length where needed, for floors, carpets, or hard to reach places:
- 16 Push the wide end of the tube on to the nozzle.
- 17 Choose a tool, and push it on the narrow end of the tube, or on the nozzle.

suction control

18 There are two ways to control the suction:

- a) The suction control on top of the cleaner – turn it clockwise to increase the cleaning power, anti-clockwise to decrease the power.
- b) The suction control on the nozzle – move it towards the nozzle for maximum suction, away from the nozzle, to reduce suction.

plug in

caution If you've accidentally pressed the on/off switch, the cleaner could come on when you plug it in. This could give you a bit of a start, so be careful.

19 Plug the cable into a socket near the area to be cleaned (switch the socket on, if it's switchable).

switching on

20 Press and release the on/off switch ①, to turn the cleaner on.

cleaning

21 Move the tool over the surface, cleaning a small area at a time.

22 When you move to a new area, overlap the previous area, to make sure none of the surface is missed.

switching off

23 If you've finished, if you want to change tools, or if you just want to stop for a rest, press and release the on/off switch ①, to turn the cleaner off.

finished cleaning?

24 Press and release the on/off switch ①, to turn the cleaner off.

25 Unplug the cleaner.

26 Stand clear of the cable, and press the cable rewind ⑤, the cable will rewind.

27 Keep clear of the cable, as it rewinds at a fair lick. If it catches on anything, stop pressing, and it'll stop rewinding.

28 We've tried not to make it too powerful, to avoid wrecking your home, so you may need to push the plug end into the storage area manually.

removing and emptying the bin

29 You don't have to empty the bin after each use, but it's a very good idea. Your cleaner will happily work till it's chock full, but you'll be wasting energy swirling yesterday's dust around. Energy that could be better used sucking up today's dust.

30 There's a "bin full indicator" on top of the bin. It's eye-shaped, and it's just below the bin handle.

31 If it shows red, when suction is at maximum, and the nozzle is off the floor, then you should empty the bin right away.

32 Switch off, unplug, and leave it for a minute, to let the dust settle.

33 Press in the lock on the hose end, and pull the hose out of the cleaner – this'll keep the hose out of your way.

34 Lift the bin handle till it stops (about 80 degrees). Then lift the bin up and out of the cleaner.

35 Lower the bin into your dustbin so the bottom of the bin is below the rim – this'll prevent the dust dispersing into your environment.

36 Press the top of the latch, to open the bottom of the bin, and dump its contents into the dustbin. Give the bin a couple of taps, to shake all the dirt loose.

37 Lift the bottom of the bin up to close it.

check the filters

38 While emptying the bin, check the filters. Blocked filters quickly reduce suction, and they're easy to clean.

precautions

39 Spread out some newspaper – you're likely to make a mess.

40 Wearing rubber gloves is a good idea – they'll protect your fingers from gunge on the filters.

HEPA filter

41 This filters the returning airflow. It's expensive to replace, so be gentle with it. With careful handling, it should last for years.

42 Grip the tab on the HEPA filter, and pull the filter gently out of the rear of the bin.

43 This will expose the foam filter.

44 Push the top of the foam filter, to get your fingers behind it, and pull it out.

45 Tap both filters gently over the newspaper, to dislodge any dirt.

46 If they're really dirty:

a) soak the HEPA filter in warm soapy water for a few minutes, rinse under a running tap, to remove all trace of soap, then let it air dry

b) wash the foam filter in warm soapy water, rinse it thoroughly, squeeze it out, then leave it to air dry

✱ Check that both filters are completely dry before replacing them in the bin.

47 Replace the foam filter in the rear of the bin, then replace the HEPA filter.

plastic filter

48 Grip the bottom of the plastic filter.

49 Turn it anti-clockwise to release the bayonet fittings on its top.

50 Bring it down and out of the bin.

51 Turn it upside down and tap it, to release any dust.

52 If the holes are blocked:

a) try brushing it with an old toothbrush, to clear the holes

b) wash it in warm soapy water, rinse under a running tap, to remove all trace of soap, then let it air dry

53 Replacing it is a bit fiddly:

a) push it up its tube till it stops

b) turn it anti-clockwise till you feel the bayonet fittings on the filter clear the fittings inside the tube

c) now turn it clockwise, to engage the bayonet fittings

54 Lift the bottom of the bin till the latch clicks into place, to secure it.

55 Lower the bin into the cleaner, then lower the bin handle on to the body of the bin, till it clicks into place.

outlet filter

56 Ease the tabs on the cover away from the cleaner, and lift the cover off.

57 Grip the tab on the outlet filter, and lift it out of the cleaner.

58 Give it a tap, to remove any dust, then replace it in the cleaner.

59 To replace the cover, locate the lugs on the front of the cover in the slots in the cleaner.

60 Lower the cover on top of the outlet filter.

61 Press the tabs down till they click into place.

cleaning the cleaner

62 Switch the cleaner off and unplug it before cleaning.

63 Don't put any part of the cleaner in a dishwasher.

64 Don't use harsh or abrasive cleaning agents or solvents.

65 Wipe external surfaces of the cleaner with a damp cloth.

66 Wipe the tools and tubes with a damp cloth.

67 A dab of washing-up liquid will remove stubborn stains, but clean it off afterwards, or it may stain.

timing

68 Clean the cleaner frequently. Basically, the better you look after it, the longer it'll last. Keep an eye on it as you use it, and examine the filters when you empty the bin. If anything needs cleaning, do it there and then, don't put it off, in case you forget.

blockages

69 No matter how careful you are, sooner or later you'll block the cleaner.

don't panic!

If the cleaner starts to get noisy and you start to lose suction, don't worry, it's not the end of the world, you've probably just blocked it up.

- 1 Switch the cleaner off and unplug it.
- 2 Spread a newspaper on the floor, you're going to make a mess.
- 3 If you're using one of the tools, remove and check it first.
- 4 Turn the turbo brush over, press the tab, and remove the door, to check the turbo.
- 5 Pull the hose out and check it.
- 6 Remove the bin, and check the HEPA filter, foam filter, and plastic filter.
- 7 Use something blunt, like the blunt end of a ball-point pen to dislodge any blockage.
- 8 If you haven't cleared the blockage by now, try again.
- 9 Still not clear? – Ring the helpline.

connection

The cleaner doesn't need an earth. It has a 13A BS1362 fuse in a 13A BS1363 plug. To replace the plug, fit the blue wire to N, and the brown wire to L. Fit the cord grip. If in doubt, call an electrician.

Don't use a non-rewireable/moulded plug unless the fuse cover is in place. If you remove the plug, dispose of it.

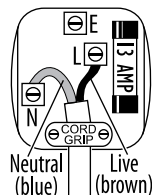

helpline – 0845 658 9700

If you need help, note the Model No (on the rating plate) and ring the helpline 0845 658 9700 (it's a local rate number).

spare parts

Note the Model No (on the rating plate) and the part(s) you need, then ring the helpline – 0845 658 9700, or email service@saltoneurope.com for price(s). You may then order spares with VISA or MASTERCARD.

service

If you ring Customer Service, please have the **Model No.** to hand, as we won't be able to help you without it. It's on the rating plate (usually underneath the product).

The cleaner isn't user-serviceable. If it's not working, read the instructions, check the plug fuse and main fuse/circuit breaker.

If that doesn't solve the problem, don't take the cleaner back to the place you bought it – they won't be able to fix it. Ring Customer Service.

If they advise you to return the product to us, pack it carefully, include a note with your name, address, day phone number, and what's wrong. If under guarantee, say where and when purchased, and include proof of purchase (till receipt). Send it to:

Customer Service, Salton Europe Ltd, Failsworth, Manchester M35 0HS

email: service@saltoneurope.com

telephone: 0845 658 9700 (local rate number)

guarantee

Defects affecting product functionality appearing within one year of purchase will be corrected by replacement or repair provided the product is used and maintained in accordance with the instructions. Your statutory rights are not affected. Documentation, packaging, and product specifications may change without notice.

wheelie bin symbol

To avoid environmental and health problems due to hazardous substances in electrical and electronic goods, appliances marked with this symbol mustn't be disposed of with unsorted municipal waste, but recovered, reused, or recycled.

