



Russell Hobbs



MULTI CYCLONIC ULTRA COMPACT

2 YEAR WARRANTY

19300AU

19300AU_IB_FA_250712

INSTRUCTIONS & WARRANTY

Spectrum Brands Australia Pty Ltd
Locked Bag 3004 Braeside
Victoria 3195 Australia
Customer Service in Australia
TollFree: 1800 623 118
Email: info@spectrumbrands.com.au
Website: www.spectrumbrands.com.au

Spectrum Brands New Zealand Ltd
PO Box 9817 Newmarket
Auckland 1149 New Zealand
Customer Service in New Zealand
TollFree: 0800 736 776
Email: service@spectrumbrands.co.nz
Website: www.spectrumbrands.co.nz

Spectrum Brands Australia Pty Ltd and Spectrum Brands New Zealand Ltd Warranty Against Defects



In this warranty:

Australian Consumer Law means the Australian consumer law set out in Schedule 2 to the Competition and Consumer Act 2010;

CGA means the New Zealand Consumer Guarantees Act 1993;

Goods means the product or equipment which was accompanied by this warranty and purchased in Australia or New Zealand, as the case may be;

Manufacturer, We or us means:

1. for Goods purchased in Australia, Spectrum Brands Australia Pty Ltd ABN, 78 007 070 573;
or
2. for Goods purchased in New Zealand, Spectrum Brands New Zealand Ltd, as the case may be,
contact details as set out at the end of this warranty;

Supplier means the authorised distributor or retailer of the Goods that sold you the Goods in Australia or in New Zealand; and

You means you, the original end-user purchaser of the Goods.

1. Our goods come with guarantees that cannot be excluded under the Australian Consumer Law, or the CGA. You are entitled to a replacement or refund for a major failure and compensation for any other reasonably foreseeable loss or damage. You are also entitled to have the goods repaired or replaced if the goods fail to be of acceptable quality and the failure does not amount to a major failure.
2. The benefits provided by this Warranty are in addition to all other rights and remedies in respect of the Goods which the consumer has under either the Australian Consumer Law or the CGA. The original purchaser of the Goods is provided with the following Warranty subject to the Warranty Conditions:
3. We warrant the Goods for all parts defective in workmanship or materials from the date of purchase (Warranty Period), for the period of:-
 - (a) Two (2) years for Russell Hobbs products (see product packaging for details)
 - (b) Two (2) years with five (5) year motor warranty for Russell Hobbs products (see product packaging for details)
 - (c) Limited Lifetime, Ten (10) years for Russell Hobbs cookware.
 - (d) One (1) year for George Foreman, iRobot, Westinghouse, Black & Decker and Spectrum Brands products.

If the Goods prove defective within the Warranty Period by reason of improper workmanship or material, we may, at our own discretion, repair or replace the Goods without charge.

Warranty Conditions

4. The Goods must be used in accordance with the manufacturer's instructions. This Warranty does not apply should the defect in or failure of the Goods be attributable to misuse, abuse, accident or non-observance of manufacturer's instructions on the part of the user. As far as the law permits, the manufacturer does not accept liability for any direct or consequential loss, damage or other expense caused by or arising out of any failure to use the Goods in accordance with the manufacturer's instructions.
5. Exhaustible components (such as batteries, filters and brushes) of the Goods are included under this Warranty only where there is a defect in workmanship or materials used.
6. The warranty granted under clause 3 is limited to repair or replacement only.
7. Any parts of the Goods replaced during repairs or any product replaced remain the property of the manufacturer. In the event of the Goods being replaced during the Warranty Period, the warranty on the replacement Goods will expire on the same date as for the Warranty Period on the original Goods which are replaced.
8. In order to claim under the warranty granted under clause 3 you must:
 - (a) Retain this warranty with your receipt/proof of purchase; and
 - (b) Return the Goods to us at the relevant address or to the Supplier by prepaid freight within the Warranty Period accompanied with (i) the legible and unmodified original proof of purchase, which clearly indicates the name and address of the Supplier, the date and place of purchase, the product name or other product serial number and (ii) this warranty.
9. This warranty is immediately void if:
 - (a) Any serial number or appliance plate is removed or defaced;
 - (b) The Goods have been serviced or otherwise repaired by a person not authorised to do so by us or where non approved replaced parts are used.
10. The Goods are designed for domestic use only. A limited 90-day Warranty applies to any industrial or commercial use of the Goods. The Goods must be connected to the electrical voltage requirements as specified in the ratings label located on the Goods.
11. This warranty does not cover the cost of claiming under the warranty or transport of the Goods to and from the Supplier or us.
12. This warranty is only valid and enforceable in Australia against Spectrum Brands Australia Pty Ltd and in New Zealand against Spectrum Brands New Zealand Ltd.

Contact us or the Supplier for further details.

Register your product online

If you live in Australia please visit: www.spectrumbrands.com.au/warranty

If you live in New Zealand Please visit: www.spectrumbrands.co.nz/warranty

Registration of your warranty is not compulsory, it gives us a record of your purchase AND entitles you to receive these benefits: Product information; Hints and tips; Recipes and news; Information on special price offers and promotions.

Any questions? Please contact Customer Service for advice.

IMPORTANT SAFETY INSTRUCTIONS

When using an electrical appliance, basic precaution should always be followed, including the following:

READ ALL INSTRUCTIONS BEFORE USING (THIS APPLIANCE)

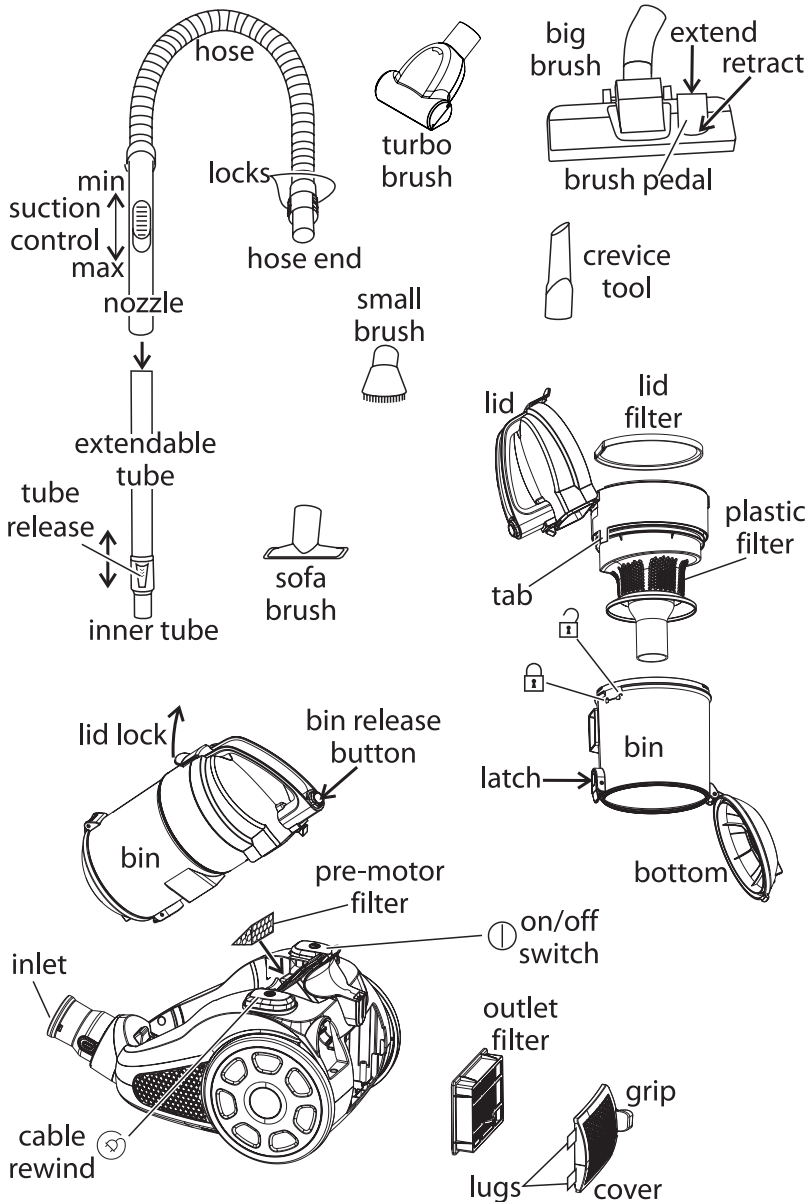

BEFORE USING FOR THE FIRST TIME

Carefully remove all contents from the box. As some parts may be packed separately, check all of the packaging before disposal.

FITTING THE HOSE

- Align the hose end with the inlet in the cleaner.
- Push the hose end into the inlet. It will click as it locks into position.

POWER CORD

- Pull as much cord as you need from the back of the cleaner.
- A yellow band around the cable will appear when there is approximately one metre of cable left.
- Stop pulling when the red band around the cable appears, this indicates there is only half a metre left.
- When vacuuming larger spaces and multiple rooms you may need to turn the vacuum off and select another power outlet. Never try to extend the power cord passed the red band around the power cord.
- Avoid tangling the power cord around furniture and other obstacles as it may become a tripping hazard to you and other people.

CARRYING AND MOVING THE CLEANER

- Lift the cleaner only by the carrying handle.
- Don't sit it upright, it will fall over.
- The vacuum cleaner should follow you as you vacuum. If you feel resistance check the wheels are moving and the vacuum isn't tangled or caught. Pulling the vacuum under stress by the hose will cause the hose to stretch and can damage the connection.

CHOOSE THE TOOL FOR THE JOB

The tools will fit on the nozzle or on the end of the inner tube. The extendable tube fits on the end of the nozzle.

Big Brush – used with the extendable tube, for floors and carpets: Press the rear of the pedal to extend the bristles for floors with little or no pile. Press the front to retract the bristles for rugs, carpets and anything else with pile.

Turbo Brush – used with the extendable tube, for floors and carpets, it has a rotating, suction-powered brush for deep cleaning.

Crevice tool – as the name implies, down the sides of upholstery and awkward spaces nothing else can reach.

Small brush – to remove dust from blinds and curtains, and to brush/clean awkward corners.

Sofa brush – to remove pet hair, lint, and dust from upholstery, and other small, flat areas - do not use it on hanging curtains as it doesn't have the bristles necessary to let air flow freely, use the small brush instead.

TUBES

- Fit the extendable tube to the nozzle for floors, carpets or hard to reach places:
 - a) Push the tube release towards the narrow end of the tube, and keep it pressed
 - b) Pull out as much of the inner tube as you need
 - c) If you have finished using it, push it back
 - d) Return the tube release to the locked position
- Fit the wide end of the extendable tube to the nozzle.
- Choose a tool, and fit it to the end of the inner tube.

SUCTION CONTROL

- The suction control is located on the hose near the nozzle.
- Move the suction control towards the nozzle for maximum suction, away from the nozzle to reduce suction.

PLUG IN

Caution: If you've accidentally pressed the power on/off button, the vacuum cleaner will come on when you plug it in.

- Plug the cable into a power socket near the area to be cleaned (switch the power socket on, if it's switchable).

SWITCHING ON

- Press and release the power on/off button to turn the cleaner on.

CLEANING

- Move the tool over the surface cleaning a small area at a time.
- When you move to a new area, overlap the previous area to make sure none of the surface is missed.

SWITCHING OFF

- If you want to change tools or if you've finished vacuuming, press and release the power on/off button to turn the cleaner off.

FINISHED CLEANING?

- Press and release the power on/off button to turn the cleaner off.
- Turn off the power socket (if it's switchable) and unplug the cleaner.
- Stand clear of the cable, press and hold the cable rewind button.
- Keep clear of the cable, it rewinds quite quickly and can flick up or catch on corners and furniture. If it catches on anything, stop pressing and it'll stop rewinding.
- If the power cord does not retract fully into the unit you may need to pull it out

a little then press and hold the cord retract button again. You may need to push the plug end into the storage area manually.

REMOVING AND EMPTYING THE BIN

- You don't have to empty the bin after each use but it's a very good idea.
- The cleaner will work until the bin is full but you may find a loss of performance as the bin nears capacity.
- Switch off, unplug and leave it for a minute to let the dust settle.
- Press the locks on the hose end, and pull the hose from the inlet.
- Hold the handle, press the bin release button and then lift the bin up and out of the cleaner.
- Lower the vacuum cleaner bin into your rubbish bin so the bottom of the bin is below the rim – this prevents dust dispersing into the air.
- Press the latch on the side to open the bottom of the bin and dump the contents into the rubbish bin.
- Don't bump the open vacuum bin on the sides of your rubbish bin as this could result in damage to the vacuum bin.
- Lift the bottom of the bin up to close it.

CHECK THE FILTERS

- While emptying the bin, check the filters – blocked filters quickly reduce suction.
- Spread out some newspaper and wear rubber gloves.

Note: filters must be completely dry before replacing in the cleaner.

PLASTIC FILTER

- Lift the bottom and close the bin.
- Grip the handle in one hand, grip the bottom of the bin with the other hand.
- Turn the handle until the tab moves from the closed padlock (insert closed padlock symbol) to the open one (insert image of open padlock).
- Lift the plastic filter out of the bin.
- Clean the outside of the plastic filter with a stiff brush, an old toothbrush is ideal.
- Replace the plastic filter in the bin, and move the tab from (insert unlock symbol) to (insert locked symbol) to lock it in place.

LID FILTER

- Pull the lid lock up to open the lid.
- Lift off the lid filter.
- Wash it in warm soapy water, rinse and then air dry.

- When it is completely dry, replace it and close the lid.

PRE-MOTOR FILTER

- Lift the pre-motor filter out of the cleaner.
- Soak it in warm soapy water for a few minutes, rinse under a running tap and then let it air dry.
- When it is completely dry, replace it in the cleaner.
- Lower the bottom of the bin into the cleaner and then push the handle forward and down to lock the bin into the cleaner.

OUTER CLEANER

- Press the grip towards the cover and lift the cover off the cleaner.
- Lift the outlet filter out of the cleaner.
- Tap it gently over the rubbish bin to dislodge any dirt.
- If it is really dirty soak it in warm soapy water for a few minutes, rinse under a running tap, then let it air dry.
- When it is completely dry, replace it in the cleaner.
- Fit the lugs on the cover into the cleaner, then press the grip home to lock the cover in place.
- Replace the hose end in the inlet.

CLEANING THE CLEANER

- Switch the cleaner off and unplug it.
- Wipe external surfaces of the cleaner with a damp cloth.
- Wipe the tools and tubes with a damp cloth.
- Wipe the inside of the bin and its bottom with a damp cloth.
- Don't put any part of the cleaner in the dishwasher.

TIMING

Clean the cleaner frequently. Basically, the better you look after it, the longer it will last. Keep an eye on it as you use it, and examine the filters when you empty the bin.

BLOCKAGES

- If the cleaner starts to get noisy and you start to lose suction there is probably a blockage.
- Switch the cleaner off and unplug it.
- Spread some newspaper or an old towel on the floor to avoid making a mess.
- If you're using one of the tools, remove and check it first.

- Pull the hose out and check it – leave it out until you have completed the next steps.
- Remove the bin and check both ends of the inlet.
- If there is a blockage, try and remove it with your hands. Don't use anything sharp.
- Check all the filters.
- Then reassemble.
- If you haven't cleared the blockage, following these steps, ring customer service.

IMPORTANT SAFEGUARDS

Read the instructions before use and keep them safe.

Pass them on if you pass the cleaner on.

When using electrical appliances, basic safety precautions should always be followed, including the following:

1. The cleaner must only be used by or under the supervision of a responsible adult. Use and store it out of reach of children.
2. This appliance is NOT a toy. Children should be supervised to ensure they do not play with this appliance.
3. This appliance is not intended for use by persons (including children) with reduced physical, sensory or mental capabilities, or lack of experience and knowledge, unless they have been given supervision or instruction concerning use of the appliance by a person responsible for their safety.
4. Do not immerse the cleaner in any liquid and don't use it anywhere damp or wet.
5. Don't use the cleaner near a gas, oil (including paraffin) or open fire. The flame may be drawn towards the cleaner causing a fire hazard.
6. To avoid personal injury, keep hair, clothing, fingers, face, etc. away from the brush/suction inlet of the cleaner.
7. Do not use the cleaner to pickup any of the following:
 - **do not attempt to pick up liquid** - this cleaner is designed for dry substances only.
 - **do not pick up items that may ignite spontaneously** - e.g. matches, pieces of firelighter.
 - **do not pick up anything burning or smouldering** - e.g. cigarette ends, ashes or embers.
 - **do not pick up spillage from toner cartridges** - the fine carbon particles may pass through the filter, short circuit the motor and burn it out.
 - **do not pick up cement or plaster dust** - these can combine with moisture in the air, clog the filter, scour the bin and possibly cause the motor to overheat and burn out.
 - **do not pick up sharp objects** - they may pierce the filter and damage the motor.
 - **do not pick up biological waste** - you will eventually have to clean it off the filter and there is a possibility of viral particles passing through the filter and entering your air supply.
8. If using the cleaner outdoors (e.g. cleaning the car), connect it to the electricity supply through a residual current device (RCD) with a rated residual operating current not exceeding 30mA.
9. Do not leave the cleaner unattended when plugged in.
10. To prevent damage to the power cable, avoid catching, stressing or running over the cable while vacuuming.
11. Be sure the power cable does not become a tripping hazard to yourself or others while vacuuming.
12. If using the cleaner to vacuum stairs, place the cleaner to avoid toppling and be sure to work above the cleaner to avoid injury should the unit topple.
13. Do not use the cleaner to vacuum people, pets or animals of any sort.
14. Unplug the cleaner and retract the cord when not in use.

15. Do not use the cleaner for any purpose other than those described in these instructions.
16. Use only the accessories supplied with the unit.
17. Do not leave the cleaner sitting in sunlight; prolonged exposure to UV rays may damage the plastic.
18. Do not use the cleaner if it is damaged or has malfunctioned in any way. Contact the customer service department.
19. There are no user serviceable parts other than the filters and external attachments/accessories. If the power cord is damaged, it must be replaced by the manufacturer or similarly qualified person in order to avoid hazard.

SAVE THESE INSTRUCTIONS

THIS APPLIANCE IS FOR HOUSEHOLD USE ONLY

www.russellhobbs.com.au

www.russellhobbs.co.nz

