



Russell Hobbs

instructions,
troubleshooting guide,
and guarantee

Problems?
Don't take it back
to the shop,
they won't be able
to fix it.



Ring the helpline

0845 658 9700

it's a local rate number

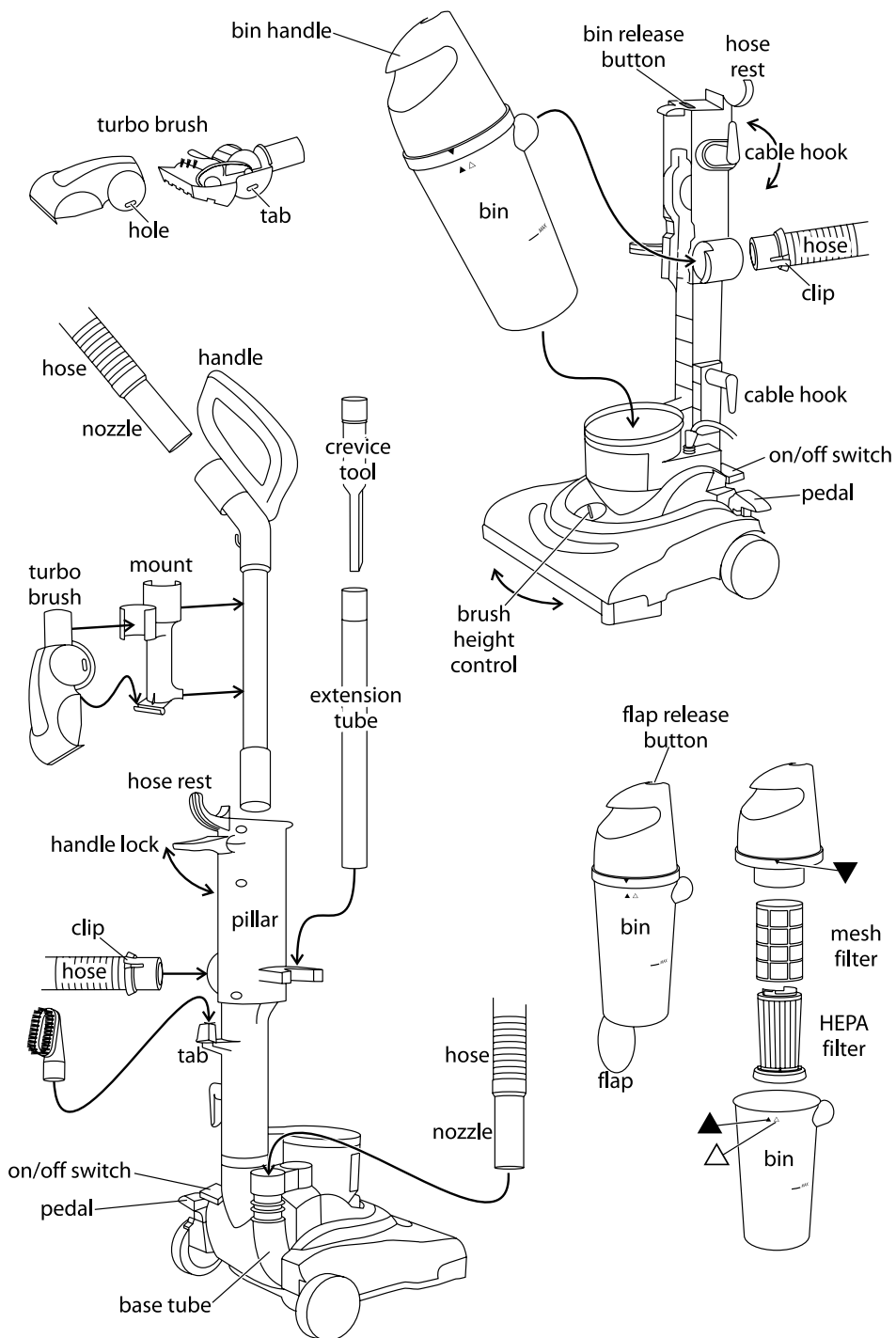

Read the instructions before using your vacuum cleaner, and keep them safe. If you pass the cleaner on, pass on the instructions too.

important safeguards

Follow basic safety precautions, including the ones below. It's quite a list, but most of them are simple common sense.

- 1 The cleaner must only be used by or under the supervision of a responsible adult. Use and store it out of reach of children.
- 2 Don't put the cleaner in water or any other liquid, and don't use it anywhere damp or wet.
- 3 Don't use the cleaner near a gas, oil (including paraffin), or open fire. The flame may be sucked towards the cleaner, causing a fire hazard.
- 4 Keep hair, clothing, fingers (and toes), away from the end doing the sucking, and from the brush roller. It won't drag you bodily into the bin, but it may give you a bit of a start.
- 5 Stuff you mustn't pick up:
 - a) don't pick up water or any other liquid – you'll short the motor.
 - b) don't pick up anything that may ignite spontaneously, like matches, or bits of fire-lighter.
 - c) don't pick up anything burning or smouldering, like cigarette ends, ashes, or embers. Wait till they're extinguished and cold.
 - d) don't pick up spillage from toner cartridges – the fine carbon particles may pass through the filter, short circuit the motor, and burn it out.
 - e) don't pick up cement or plaster dust – they'll combine with moisture in the air, clog the filter, scour the bin, and maybe burn out the motor too.
 - f) don't pick up anything sharp – you may puncture the filter and damage the motor.
 - g) don't pick up anything biological – you'll eventually have to clean it off the filter, and there's always the possibility that viral particles may pass through the filter, reach the air outlet, and enter your air supply.
- 6 If you use the cleaner outdoors (e.g. cleaning the car), connect it to the electricity supply via a residual current device (RCD), with a rated residual operating current not exceeding 30mA. Don't let the cleaner get wet.
- 7 Don't leave it unattended when plugged in.
- 8 Keep an eye on the cable, so it doesn't catch on anything, or trip anyone up. Don't run the cleaner over the cable, you'll damage it.
- 9 If you're using the cleaner on stairs, sit it where it can't topple, and keep it below you, so if it does fall, it doesn't land on you.
- 10 Don't use the cleaner on people, animals, birds, or pets.
- 11 Unplug the cleaner and wind the cable round the cable carriers when not in use, before moving and before cleaning.
- 12 Don't use the cleaner if the bin is full – switch off, unplug, empty.
- 13 Don't use the cleaner for any purpose other than those described in these instructions.
- 14 Don't use tools or attachments other than those we provide.
- 15 Don't leave the cleaner in direct sunlight.
- 16 Don't use the cleaner if it's damaged or malfunctions.
- 17 If the cable or plug is damaged, return the cleaner, to avoid hazard (back page).



household use only

before using for the first time

Remove the packaging, but keep it in case you ever need to return the cleaner.

filter

It's vital you keep the filter clean. If the filter is blocked, you'll lose suction rapidly. We've made it easy to remove, and easy to clean – the rest is down to you.

count the bits

The box should contain the cleaner itself, the handle, hose, extension tube, crevice tool, turbo brush, and small brush. Check that you've got them all before you dispose of the packaging.

fit the handle

- 1 Lift the handle lock, at the rear of the pillar.
- 2 Fit the end of the handle into the hole on top of the pillar.
- 3 Lower the handle lock to secure the handle

fit the extension tube

- 4 Slide the crevice tool into the extension tube.
- 5 Slide the extension tube down, parallel to the pillar, to rest in the clips at the side of the pillar.

fit the hose

- 6 From the rear of the cleaner, push the clip end of the hose into the short tube about half way up the pillar (behind the bin).
- 7 Bring the hose up, over the tube rear, and down the other side of the pillar.
- 8 Push the nozzle on the other end of the hose into the base tube, just above the wheel.

fit the small brush

- 9 Push the small brush over the tab on the rear of the pillar, just below the clip end of the hose.

fit the turbo brush

- 10 Push the mount on to the tube below the cleaner handle.
- 11 Hook the inside edge of the turbo brush over the bottom of the mount, then push the tube coming out of the turbo brush into the clip on the mount.

store the cable

- 12 Turn the top cable hook till it points up.
- 13 Wind the cable between the top and bottom cable hooks.

fingers crossed

- 14 With a bit of luck, all the parts should now be mounted on the cleaner.
- 15 Here's how to use it:

set the floor type

- 16 Tilt the handle back, to raise the cleaner slightly from the floor, to make moving the brush height control easier.
- 17 Set the brush height control to suit the floor covering:
- 18 Turn it fully clockwise for hard floors like vinyl, stone, or parquet, then anti-clockwise, for short pile, medium pile, or long pile carpet.
- 19 Use the long pile setting for tools, to prevent the brush continually hitting the surface it's sitting on.

plug in

caution If you've inadvertently kicked the switch, the cleaner may start up when you plug it in – press and release the switch with your toe to switch it off.

- 20 Turn the top cable hook down, to release the cable from the rear of the cleaner.
- 21 Put the plug into a socket near the area to be cleaned (switch the socket on, if it's switchable).

pedal

- 22 The pedal locks the pillar and base together, for storage, and when using the tools.
- 23 To use the cleaner as an upright cleaner, press the pedal down with your toe, ease the handle back, then take your toe off the pedal.
- 24 This lets you push the cleaner back and fore, to vacuum the floor.
- 25 To lock the cleaner and base together again, raise the handle to the vertical position, then push it forward.

switch on

26 Press the switch with your toe to switch the cleaner on.

cleaning

27 Move the cleaner over the floor, cleaning a small area at a time.

28 When you change areas, overlap the previous area, to avoid missing anything.

switch off

29 If you've finished, if you want to change the brush height for a different floor covering, if you want to change from using it upright to using the hose, or if you just want to stop for a cup of tea, press and release the switch with your toe, to turn the motor off, then push the handle forward till it's fully upright, to lock the base.

using tools

30 Raise the handle to the vertical position, then push it forward, to lock the pillar upright.

31 Turn the brush height control fully clockwise, to prevent the brush continually hitting the surface it's sitting on.

32 Raise the handle lock (at the rear of the pillar), and pull the handle out of the pillar.

33 Pull the nozzle out of the base tube, and push it into the rear of the handle.

34 Push the tool you're going to use into the other end of the handle.

35 Press and release the switch with your toe, to turn the motor on.

choose the tool for the job:

- | | |
|----------------|--|
| crevice tool | to reach down the sides of upholstery, and into awkward spaces, nooks, and crannies nothing else can reach |
| extension tube | to reach curtain rails, picture rails, and covings |
| small brush | to remove pet hair, lint, and dust from blinds, curtains, and upholstery; to brush/clean awkward corners |
| turbo brush | normally used with the extension tube, for floors and carpets, this has a rotating brush, powered by suction, for deeper cleaning. |

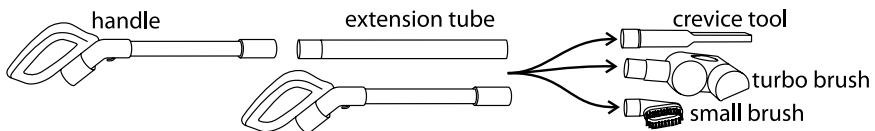

what fits to what?

36 The tools fit into the end of the handle.

37 If you fit the extension tube to the handle, then the remaining tools fit into the end of the extension tube.

finished cleaning?

38 Press and release the switch with a toe, to turn the motor off.

39 Raise the handle to the vertical position, then push it forward, to lock the pillar upright.

40 Unplug the cleaner (switch the socket off first, if it's switchable).

41 Turn the top cable hook up, and wind the cable round both cable hooks.

removing the bin

42 You don't have to empty the bin after each use, but it's a very good idea. You shouldn't let it get above the MAX mark.

43 Your cleaner will happily work till it's chock full, but you'll be wasting energy swirling yesterday's dust around. Energy that could be better used sucking up today's dust.

44 Switch off, unplug, put the handle in the upright position, and leave it for five to ten minutes, to let the dust settle.

45 Press the bin release button.

- 46 Use the bin lid handle to pull the top of the bin away from the pillar, then lift the bin up and away from the cleaner.
- 47 Lower the bin into your dustbin so the bottom of the bin is below the rim – this'll prevent the dust dispersing into your environment.
- 48 Press the flap release button, to open the bottom of the bin, and dump its contents into the dustbin.
- 48 Push the flap back up, to seal the bottom of the bin again.
- 50 Lower the bottom of the bin on to the cleaner.
- 51 Push the top of the bin against the pillar.
- 52 The short tube at the rear of the bin goes into the other end of the tube that the hose connects to.
- 53 You'll hear the bin release button click into place.

checking the HEPA filter

- 54 While you've got the bin off the cleaner, why not check the HEPA filter?
- 55 Turn the bin to align the ▼ on the lid with the △ on the bin.
- 56 Lift the lid and filters out of the bin.
- 57 Grip the bottom of the HEPA filter with one hand, and the bin handle with the other.
- 58 Turn the HEPA filter about a third of a turn anti-clockwise, to release it from the lid, and pull it away from the lid.
- 59 Slide the mesh filter up and off the HEPA filter.
- 60 Don't handle the paper part of the HEPA filter, oils from your skin can cause dust particles to adhere to it.

the mesh filter

- 61 Wash the filter assembly and mesh filter in warm soapy water.
- 62 Leave it to air dry – don't refit it till it's completely dry.
- 63 Unscrew the top of the filter unit from the HEPA filter.

the HEPA filter

- 64 This filters the returning airflow. It's expensive to replace, so be gentle with it. With careful handling, it should last for years.
- 65 If the filter looks a bit mucky, tap it over the newspaper, to dislodge the dirt.
- 66 If its very dirty, soak it in warm soapy water for a few minutes, rinse under a running tap, to remove all trace of soap, then let it air dry – don't refit till it's completely dry.

refitting the filters

- 67 Slide the mesh filter over the HEPA filter – it only fits one way, with the broader plastic band at the top.
- 68 Replace the HEPA filter in the bin lid, and turn it clockwise, to lock it in place..
- 69 Align the ▼ on the lid with the △ on the bin.
- 70 Fit the lid to the bin, then turn it to align the ▼ on the lid with the ▲ on the bin.
- 71 Replace the bin in the cleaner.

general cleaning

- 1 Switch the cleaner off and unplug it before cleaning.
- 2 Don't put any part of the cleaner in a dishwasher.
- 3 Don't use harsh or abrasive cleaning agents or solvents.

external surfaces

- 4 Wipe external surfaces with a damp cloth. A dab of washing-up liquid should remove stubborn stains, but clean it off afterwards, or it may itself cause staining.

tools

- 5 Wipe with a damp cloth, or hand wash in warm soapy water.

6 Rinse to remove the soap, and air dry before using them.

hose

7 Wipe with a damp cloth. You can use a dab of washing-up liquid to remove stubborn stains. Clean off all trace of the washing-up liquid, and check it's dry before refitting.

brush roller

8 String and the like may wind round the brush roller. Upend the cleaner, and snip any string, etc. carefully with scissors. Take care not to cut the bristles.

turbo brush

9 Threads and hair may block the turbine.

10 Gently prise the sides of the turbo brush apart with your fingers, to release the holes from the tabs in the body of the brush, and lift the top forwards.

11 Remove any threads from the belt or turbine.

12 Engage the front of the top part with the front of the bottom part, then push gently down to engage the tabs in the holes.

blockages

No matter how careful you are, sooner or later you're going to block the cleaner.

Don't worry, we thought of that, we've fitted the motor with a temperature cut-out. A blockage will trigger the cut-out, and the motor will stop.

don't panic!

If the motor cuts out while you're vacuuming, don't panic, it's not the end of the world, you've probably just blocked it up.

13 Switch off, unplug, and leave the cleaner for half an hour to cool down fully. This'll also reset the cut-out.

14 Spread a newspaper on the floor, you're going to make a mess.

suction blocked

15 If you're using one of the tools, remove and check it first.

16 Remove and check the hose.

17 Check the bin, bin lid, HEPA filter, and mesh filter.

18 Check the base tube – this runs down to the brush roller. Don't use anything sharp. The blunt end of a ball-point pen will do nicely.

19 If the blockage isn't clear by now, try again, as there's nowhere left to check.

20 Still not clear? – Ring the help line (back page).

connection

The product doesn't need an earth. It has a 13A BS1362 fuse in a 13A BS1363 plug. To replace the plug, fit the blue wire to N, and the brown wire to L. Fit the cord grip. If in doubt, call an electrician. Don't use a non-rewireable/moulded plug unless the fuse cover is in place. If you remove the plug, dispose of it.

wheelie bin symbol

To avoid environmental and health problems due to hazardous substances in electrical and electronic goods, appliances marked with this symbol mustn't be disposed of with unsorted municipal waste, but recovered, reused, or recycled.

helpline – 0845 658 9700

If you need help, note the **Model No** (on the rating plate) and ring the helpline 0845 658 9700 (it's a local rate number).

service

If you ring Customer Service, please have the **Model No** to hand, as we won't be able to help you without it. It's on the rating plate (usually underneath the product).

The cleaner isn't user-serviceable. If it's not working, read the instructions, check the plug fuse and main fuse/circuit breaker.

If that doesn't solve the problem, don't take the cleaner back to the place you bought it – they won't be able to fix it. Ring Customer Service.

If they advise you to return the product to us, pack it carefully, include a note with your name, address, day phone number, and what's wrong. If under guarantee, say where and when purchased, and include proof of purchase (till receipt). Send it to:

Customer Service, Russell Hobbs Ltd, Fir Street, Failsworth, Manchester M35 0HS

email: service@russellhobbs.com

telephone: 0845 658 9700 (local rate number)

guarantee

Defects affecting product functionality appearing within one year of purchase will be corrected by replacement or repair provided the product is used and maintained in accordance with the instructions. Your statutory rights are not affected. Documentation, packaging, and product specifications may change without notice.

wheelie bin symbol

To avoid environmental and health problems due to hazardous substances in electrical and electronic goods, appliances marked with this symbol mustn't be disposed of with unsorted municipal waste, but recovered, reused, or recycled.

online

www.russellhobbs.co.uk for more products

