

**REMINGTON®**  
EST. NEW YORK 1937

# **RAPID CUT ULTIMATE**

## **HAIR CLIPPER**

**USE & CARE  
MANUAL**

PLEASE READ  
PRIOR TO USE



To register your product go to  
[www.remington-products.com.au](http://www.remington-products.com.au)  
[www.remington.co.nz](http://www.remington.co.nz)

**3 YEAR WARRANTY**

**HC4400AU**

# IMPORTANT SAFETY INSTRUCTIONS

## READ ALL INSTRUCTIONS BEFORE USING

**When using electrical appliances, basic precautions should always be observed, including the following.**

**For additional protection, the installation of a residual current device (rCD) having a rated residual operating current not exceeding 30 mA is advisable in the electrical circuit supplying the bathroom. Ask your installer for advice**

**WARNING - TO REDUCE THE RISK OF BURNS, ELECTROCUTION AND FIRE OR INJURY TO PERSONS**

**DANGER - As with most electrical appliances, electrical parts are electrically live even when the switch is off.**

- Do not place or store the appliance or charging adaptor and cable where they can fall or be knocked into a sink or bath.
- Do not place in or drop into water or any other liquid with the charging adaptor and charging cable plugged in.
- If an appliance falls into water, "unplug it" immediately. Do not reach into the water.
- Unplug the charging adaptor from the electrical outlet immediately after fully charging.
- Unplug and switch off this appliance before cleaning it.
- Use this appliance only for its intended use as described in this manual.
- Do not use attachments not recommended by Remington.
- Never drop or insert any object into any opening of this appliance.
- Keep the cord away from heated surfaces.
- Do not use this appliance with a damaged or broken trimming unit as injury may occur.
- Always store the charging adaptor and charging cable in a moisture-free location.
- For household use only.
- This appliance is not intended for use by persons (including children) with reduced physical, sensory or mental capabilities, or lack of experience and knowledge, unless they have been given supervision or instruction concerning use of the appliance by a person responsible for their safety.

- Keep the appliance and the charging cable away from the edge of table or countertops and out of reach of children and persons with reduced physical, sensory or mental capabilities.
- This appliance is not a toy. Children shall be supervised to ensure they do not play with the appliance.
- Do not use on people who are asleep.
- Never operate this appliance if it has a damaged cord or plug, if it is not working correctly, if the charging adaptor or cable have been damaged or dropped into water.
- Do not use an extension cord or a voltage converter with this appliance.
- Do not wrap the cord around the appliance.
- This appliance should only be charged using the adaptor provided or using the provided USB cable connected to a USB port.

Remington strongly recommends that an approved Safety Switch (Residual current device) be installed to protect all bathroom power outlets. Ask an electrical contractor for advice.

## **SAVE THESE INSTRUCTIONS**

# HC4400AU RAPID CUT ULTIMATE HAIR CLIPPER

## Use & Care Instruction Manual

Thank you for purchasing your Remington® Rapid Cut Ultimate Hair Clipper. Inside this manual you will find instructions on using and caring for your new hair clipper.

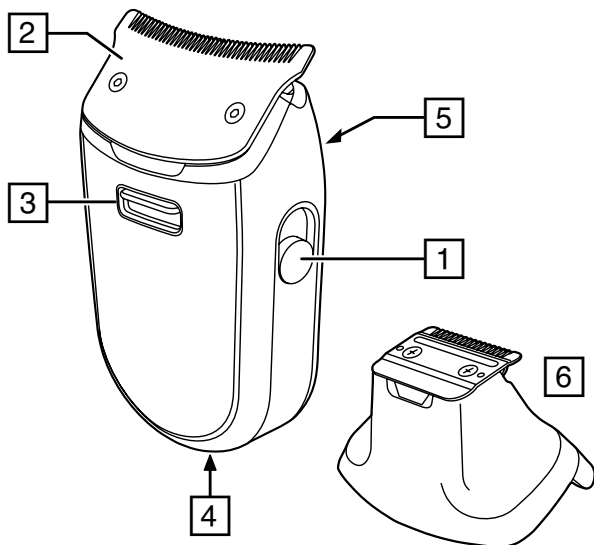

### KEY PARTS

1. On/off/turbo switch
2. Blade set
3. Blade release button
4. Charger connector
5. Charging indicator lights
6. Detail blade

#### Not shown:

- 8 detail blade combs
- 14 guide combs
- Cleaning brush
- Oil bottle
- Travel pouch
- Power Adapter
- USB Cable

## ABOUT YOUR HAIR CLIPPER

HC4400AU SPECIFICATIONS	
Power System	Cord/Cordless (Rechargeable)
Initial Charge Time	4 Hours
Full Charge Time	4 Hours
Run Time	80 Minutes
Quick Charge	5 Minutes
Indicators	3 LED lights
Voltage Type (adaptor voltage type)	Worldwide Voltage

## CHARGING

- Before using your hair clipper for the first time, charge it for 4 hours. This first charge is important to the hair clippers battery life.
- Charge via USB - Connect the product to the USB cable and then connect the USB end of the cable to a powered USB port. Check to ensure that the hair clipper Off/On/Turbo switch is OFF before charging.
- Charge via Adapter - Connect the product to the adapter cable, then connect the plug to the wall socket. Check to ensure that the hair clipper Off/On/Turbo switch is OFF before charging
- The batteries cannot be overcharged, but it is recommend that charging be discontinued and the hair clipper stored away if it will not be used for an extended period of time (2-3 months).

NOTE: The hair clipper is only to be operated in corded mode while using the adapter.

- Do not attempt to use the clipper in corded mode using the USB cable.
- The hair clipper will be fully charged in 4 hours.
- Use the hair clipper only with the charging cable supplied.

## CHARGING INDICATOR LIGHTS

● = on ○ = off ⊙ = flashing

### During Use

Lights	Charge remaining
● ● ●	67 - 100%
● ● ○	34 - 66%
● ○ ○	0 - 33%

After use, when you switch off your clipper, the charging indicator lights show the remaining charge for 3 seconds.

When there is less than 3 minutes of run time left, the left hand light will flash 3 times.

### During Charging

Lights	Charge level
⊙ ○ ○	0 - 33%
● ⊙ ○	33 - 67%
● ● ⊙	67 - 99%

Once fully charged, all 3 lights will stay on for 3 seconds and then go off.

- Run time from fully charged is up to 80 minutes.
- Charge time from empty is 4 hours.

## QUICK CHARGE FUNCTION

- 5 minutes charging will give an emergency burst of run time.
- USB cable or adapter can be used here.

## BEFORE CUTTING YOUR HAIR

### Corded use:

- For corded use connect the product to the adaptor, then to the mains power outlet.
- To use in corded mode, only use it with the adaptor and not the USB cable.

**CAUTION: Extended mains only use will result in the reduction of the battery life.**

- It is advisable not to use this hair clipper directly from the power outlet when it has been fully charged, but if while using the hair clipper in cordless mode there is a noticeable drop in power, you can use it directly from the power outlet.

### **Cordless use:**

- When the unit is switched on and fully charged, the product can be used in cordless mode for up to 80 minutes.
- Switch the product on by moving the Off/On/Turbo switch to the ON mode.

### **Turbo speed function**

- The Turbo Speed Function will provide a boost in motor speed to power through thick hair. To run in Turbo mode, slide the on/off switch to the turbo position.

### **Before starting the cut**

- Inspect the clipper making sure that it is free from hair and dirt.
- Before cutting, always comb the hair so it is tangle free and dry.

## **ATTACHING THE ATTACHMENTS**

### **To attach a comb**

- Hook the front edge of the comb to the front teeth of the blade. Then push the back of the comb down until it snaps in place.

### **To remove the comb**

- Push up the tab on the back of the comb until the comb disengages from the blade.

### **To fit/remove the blade**

- Pull the blade release button backwards (Fig A).
- Slide the blade off.
- Slide the desired blade on until it clicks into place (Fig B).

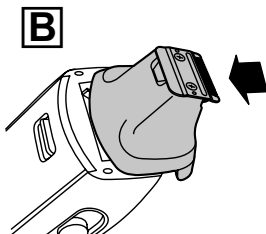
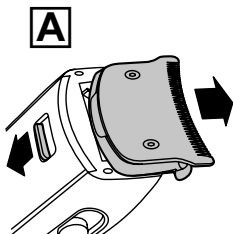

Your Rapid Cut Ultimate Hair Clipper comes with the following combs to help you create that perfect hair style: **(Please note the printed Grade Levels on the combs)**

GUIDE COMB	CUTTING LENGTH
1 (Grade 0)	1.5mm
2	2mm
3	2.5mm
4 (Grade 1)	3mm
5	4.5mm
6 (Grade 2)	6mm
7 (Grade 3)	9mm
8 (Grade 4)	12mm
9	15mm
10 (Grade 6)	18mm
11 (Grade 7)	22mm
12 (Grade 8)	25mm
Left Fade Comb	
Right Fade Comb	

- Use the clipper without any fixed combs for trimming hair close to the skin.
- This will trim hair to 1mm, holding the clipper so the blades are perpendicular to the skin will trim hair to 0.5mm

## INSTRUCTIONS FOR CUTTING YOUR HAIR

The Rapid Cut Ultimate Hair Clipper's ergonomic design provides many different ways of holding the clipper in use.

- For all over and even cutting, allow the comb attachment/blade to cut its way through the hair.
- Do not force it through quickly.
- If you are cutting for the first time, start with the maximum comb attachment.
- For one all over cut length, attach the desired guide comb and slowly guide the clipper through the hair against the direction the hair normally grows.



- To produce a clean straight line at the base of the neck, reverse the hair clipper. Place the reversed clipper at right angles to the head, tips of the blades lightly touching the skin and then work downwards.

The following instructions are for those users who want different trimming lengths on the sides, back and top of the head:

### **STEP 1 – Nape of the neck**

- Select the 3 or 6mm comb.
- Hold the clipper with the blade teeth pointing upwards. Begin starting at the centre of the head at the base of the neck.
- Slowly lift the clipper, working upwards and outwards through the hair, trimming just a little at a time.

### **STEP 2 – Back of the head**

- With the 9 or 12mm comb, cut the hair at the back of the head.

### **STEP 3 – Side of the head**

- With the 3 or 6mm comb, trim sideburns. Then change to the longer 9mm guide comb and continue to cut the top of the head.

### **STEP 4 – Top of the head**

- Use the longer length comb attachment and set it to 12mm to 25mm then cut hair on top of the head against the direction in which the hair normally grows.

### **STEP 5 – The finishing touches**

- Use the clipper without an attachment comb for close trimming around the base and sides of the neck and around the ears.
- To produce a clean straight line at the sideburns, attach the detail blade and turn the trimmer to face you.
- Place the reversed clipper at right angles to the head, tips of the blades lightly touching the skin and then work downwards.

### **TO SHAPE SIDEBURNS AND BEARD LINES**

- Fit the detail blade.
- Hold trimmer with detail trimmer blade facing you.
- Start with edge of beard/moustache line and gently lower the trimmer blade onto your skin. Use motions towards edge of beard/moustache line to trim to desired locations in facial area and away from beard in neck area.

## TO TRIM SIDEBURNS AND FACIAL HAIR

- Fit the detail blade.
- Fit the desired detail blade comb over the detail blade.
- Place the flat top of the comb against the skin and slowly slide the trimmer through the hair.
- Work upwards towards the ear and upper beard line.
- Repeat from different directions as necessary.
- Alternatively, hold the trimmer with the cutting blade facing you.
- Use a small comb to lift the hairs.
- Move the trimmer along the comb to cut the hairs. Use light pressure and well controlled movements to trim hair.

## CLEANING AND MAINTENANCE

- To ensure long lasting performance of your hair clipper, clean the blades and unit regularly.
- Always keep the hair clipper in the provided storage pouch to avoid damage to the blades.
- Ensure the appliance is switched off and unplugged from the mains before cleaning.
- Do not use harsh or corrosive cleaners on the unit or blades.
- Cleaning should be done with the cleaning brush provided.
- After each use - brush the accumulated hair from the blades.

## WASHABLE CLEANING

**Note:** Never rinse, wash or otherwise subject this product to liquid whilst the power cord is connected.

- The Rapid Cut Ultimate Hair Clipper is fully washable for easy cleaning, the entire clipper may be held under running water.
- Ensure the appliance is unplugged from the mains.
- It is recommended that you rinse the hair off the blades after each use. For best results, keep the clipper running while running it under the tap.
- Ensure the clipper is dry after cleaning.
- For more thorough cleaning, the blade set can be easily removed to wash any hair trimmings from the blades. To release the blade set, push the removable blade cartridge outward and away from the clipper by pushing on the thumb pad.

- Ensure the blades are dry after rinsing under the tap. To reattach, align the blade set onto the clipper and push the blade set towards the clipper body until it clicks into place.
- Place a small drop of cutter or sewing machine oil onto the blades at each end and at the middle point of the blades. Turn the unit on for a few seconds to distribute the oil then turn off and wipe off excess oil.

**NOTE: Keep the blades lubricated after contact with water.**

**WARNING: DETACH THE HAND-HELD PART FROM THE SUPPLY CORD BEFORE CLEANING IT IN WATER.**

## **BATTERY REMOVAL**

We strongly recommend that a professional removes the rechargeable battery. Parts of the shaver case, and tools have sharp edges and may cause injury if not handled correctly.

- The rechargeable battery must be removed from the appliance before it is scrapped.
  - Disconnect the charging adapter before removing the battery.
1. To do this, operate the device until it stops.
  2. Remove the blade set.
  3. Pry the top panel apart following the seam on either side.
  4. Remove the 6 screws from the housing.
  5. Remove the top and bottom housing.
  6. Pry the inner housing apart and remove the inner housing.
  7. Take out circuit board and battery
  8. Cut the battery connector.
- The battery is to be disposed of safely.

Legislation in some localities mandates that e-waste (anything with a plug, battery or cord) is disposed of through controlled recycling facilities and must not be disposed of in general household waste. For more information about recycling of electrical and battery operated appliances, please contact your local council or your local household waste disposal service.



**Suitable for cleaning under an open water tap.**

This appliance conforms to radio interference requirements.

Any product purchased and used commercially carries a limited 90 day warranty.

# Spectrum Brands Australia Pty Ltd and Spectrum Brands New Zealand Limited

## WARRANTY AGAINST DEFECTS

In this warranty:

**Australian Consumer Law** means the Australian consumer law set out in Schedule 2 to the Competition and Consumer Act 2010;

**CGA** means the New Zealand Consumer Guarantees Act 1993;

**Goods** means the product or equipment which was accompanied by this warranty and purchased in Australia or New Zealand, as the case may be;

**Manufacturer, We or us** means:

1. for Goods purchased in Australia, Spectrum Brands Australia Pty Ltd ACN, 007 070 573; or
2. for Goods purchased in New Zealand, Spectrum Brands New Zealand Limited, as the case may be, contact details as set out at the end of this warranty;

**Supplier** means the authorised distributor or retailer of the Goods that sold you the Goods in Australia or in New Zealand; and

**You** means you, the original end-user purchaser of the Goods.

1. Our goods come with guarantees that cannot be excluded under the Australian Consumer Law, or the CGA. You are entitled to a replacement or refund for a major failure and compensation for any other reasonably foreseeable loss or damage. You are also entitled to have the goods repaired or replaced if the goods fail to be of acceptable quality and the failure does not amount to a major failure.
2. The benefits provided by this Warranty are in addition to all other rights and remedies in respect of the Goods which the consumer has under either the Australian Consumer Law or the CGA. The original purchaser of the Goods is provided with the following Warranty subject to the Warranty Conditions:
3. We warrant the Goods for all parts defective in workmanship or materials for the period of three (3) years from the date of purchase (**Warranty Period**). If the Goods prove defective within the Warranty Period by reason of improper workmanship or material, we may, at our own discretion, repair or replace the Goods without charge.

### Warranty Conditions

4. The Goods must be used in accordance with the manufacturer's instructions. This Warranty does not apply should the defect in or failure of the Goods be attributable to misuse, abuse, accident or non-observance of manufacturer's instructions on the part of the user. As far as the law permits, the manufacturer does not accept liability for any direct or consequential loss, damage or other expense caused by or arising out of any failure to use the Goods in accordance with the manufacturer's instructions.
5. Consumable parts (such as shaver heads, cutters and foils) of the Goods are included under this Warranty only where there is a defect in workmanship or materials used.
6. The warranty granted under clause 3 is limited to repair or replacement only.
7. Any parts of the Goods replaced during repairs or any product replaced remain the property of the manufacturer. In the event of the Goods being replaced during the Warranty Period, the warranty on the replacement Goods will expire on the same date as for the Warranty Period on the original Goods which are replaced.

8. In order to claim under the warranty granted under clause 3 you must:
  - (a) Retain this warranty with your receipt/proof of purchase; and
  - (b) Return the Goods to us at the relevant address below or to the Supplier by prepaid freight within the Warranty Period accompanied with (i) the legible and unmodified original proof of purchase, which clearly indicates the name and address of the Supplier, the date and place of purchase, the product name or other product serial number and (ii) this warranty.
9. This warranty is immediately void if:
  - (a) Any serial number or appliance plate is removed or defaced;
  - (b) The Goods have been serviced or otherwise repaired by a person not authorised to do so by us or where non approved replaced parts are used.
10. The Goods are designed for domestic use only. A limited 90-day Warranty applies to any industrial or commercial use of the Goods. The Goods must be connected to the electrical voltage requirements as specified in the ratings label located on the Goods.
11. This warranty does not cover the cost of claiming under the warranty or transport of the Goods to and from the Supplier or us.
12. This warranty is only valid and enforceable in Australia against Spectrum Brands Australia Pty Ltd and in New Zealand against Spectrum Brands New Zealand Limited.

Contact us or the Supplier for further details.

#### **Spectrum Brands Australia Pty Ltd**

Locked Bag 3004

Braeside, VIC 3195

AUSTRALIA

Customer service in Australia: 1800 623 118

E-mail: [consumer.enquiry@remington-products.com.au](mailto:consumer.enquiry@remington-products.com.au)

Website: [www.remington-products.com.au](http://www.remington-products.com.au)

#### **Spectrum Brands New Zealand Limited**

PO Box 9817

Newmarket, Auckland 1149

NEW ZEALAND

Customer service in New Zealand: 0800 736 776

E-mail: [info@remington.co.nz](mailto:info@remington.co.nz)

Website: [www.remington.co.nz](http://www.remington.co.nz)

**REMINGTON®**  
EST. NEW YORK 1937

#### **REMINGTON SERVICE HOTLINE**

①Australia 1800 623 118 (toll free)

②New Zealand 0800 736 776 (toll free)

® Registered Trade Mark of Spectrum Brands Inc., or one of its subsidiaries

Made in China to the Specifications of Spectrum Brands, Inc.

©2022 Spectrum Brands Inc.

Rev. 06/22

Part No. T22-7002633

Type: RG035A

