

REMINGTON

REMINGTON

360 ROTARY SHAVER FLEX AND PIVOT TECHNOLOGY



**R4130/R5130
R6130/R7130**

REMINGTON

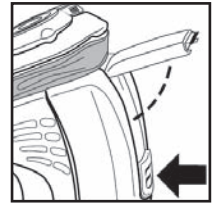

Model No. R4130/R5130/R6130/R7130

10/UK/R4130/R5130/R6130/R7130 Version 06/10 Part No. T22-29885
Remington® Registered Trade Mark of Spectrum Brands, Inc., or one
of its subsidiaries
VARTA Consumer Batteries GmbH & Co. KGaA
Alfred-Krupp-Str. 9
73479 Ellwangen
Germany
www.remington-europe.com
© 2010 SBI



➔ REMINGTON® SERVICE HOTLINES

United Kingdom

☎ +44 0800 212 438 (free call)

UK Rayovac Europe Ltd
Watermans House, Kingsbury Crescent,
The Causeway, Staines, Middlesex,
TW18 3BA, UNITED KINGDOM

www.remington.co.uk

For details of local Distributors in countries not listed above
call the German office on +49 (0) 7961 83 784

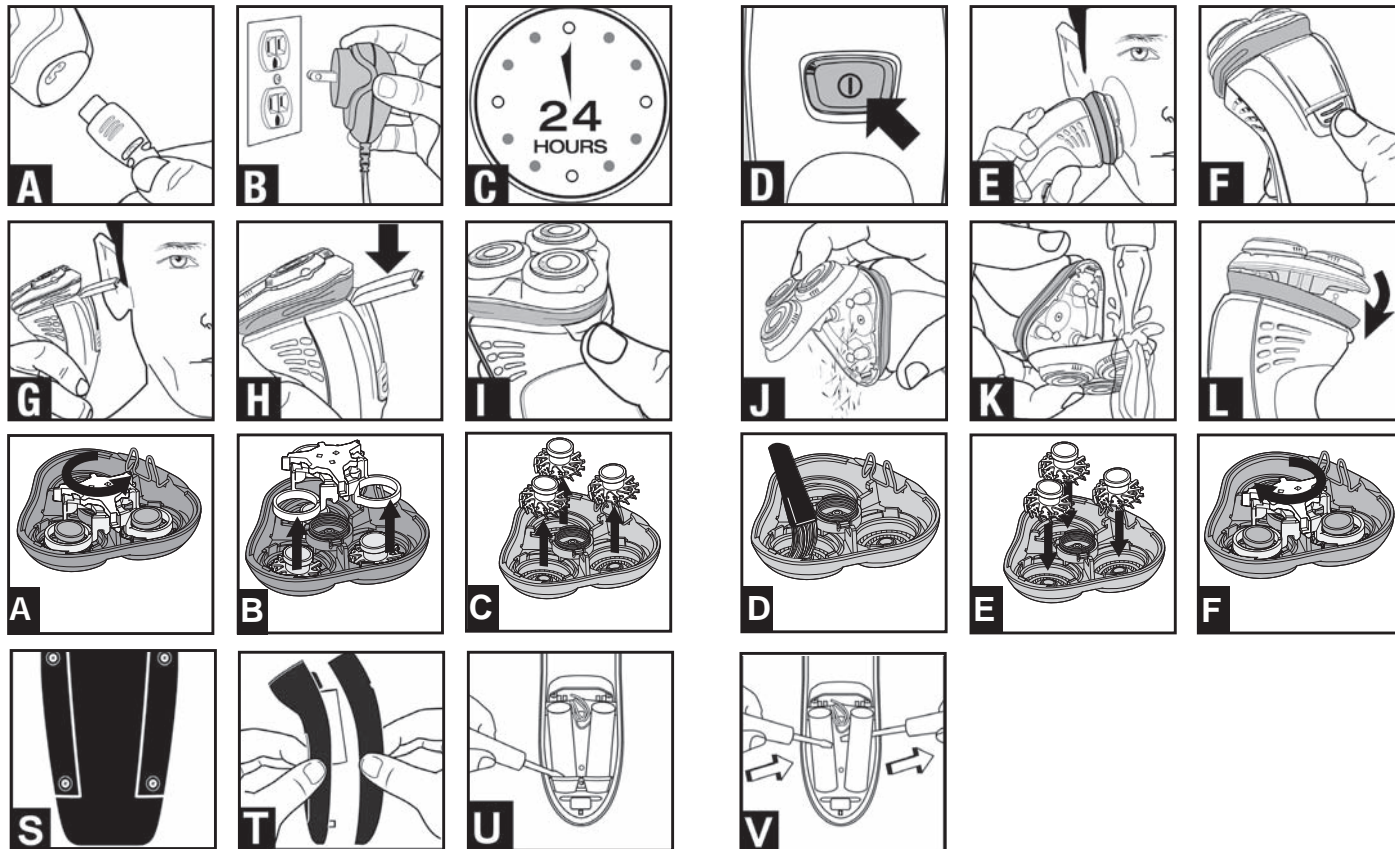



ENGLISH

Thank you for choosing Remington®. Our products are designed to meet the highest standard of quality, functionality and design. We hope you enjoy using your new Remington® appliance. Please read the instructions for use carefully and keep in a safe place for future reference.



CAUTION

- ◆ Use this appliance only for its intended use as described in this manual. Do not use attachments not recommended by Remington®.
- ◆ Do not use this product if it is not working correctly, if it has been dropped or damaged, or dropped into water.



DESCRIPTION

- 1 Pivoting Head & cutter assembly
- 2 Head release button
- 3 Individual flexing heads
- 4 On/Off Push button
- 5 Power port
- 6 LED light (R4130):
 - Green charging indicatorLED light (R5130):
 - Green charging indicator
 - Red low battery indicatorLCD Display (R6130/R7130):
 - Minutes remaining
 - Recharge warning
- 7 Trimmer button
- 8 Head guard
- 9 Power plug
- 10 Cleaning brush

ENGLISH

Feature	R4130	R5130	R6130	R7130
Power System	Cordless	Cord/ Cordless	Cord/ Cordless	Cord/ Cordless
Full Charge Time	16 hours	90 minutes	90 minutes	90 minutes
Cordless Shave Time	30 minutes	30 minutes	60 minutes	60 minutes
Quick Charge	No	Yes	Yes	Yes
Indicators	Single green LED for charging	Fuel gauge	LCD	LCD
Voltage Type	Worldwide	Worldwide	Worldwide	Worldwide
Replacement Part No.	SP-SFD2	SP-TF2	SP-DF2	SP-DF2

GETTING STARTED

For best shaving performance, it is recommended that you use your new shaver daily for up to four weeks to allow time for your beard and skin to become accustomed to the new shaving system.

CHARGING YOUR SHAYER

Always ensure that your hands, shaver and power cord are dry before charging your shaver.

- ▶ Ensure the shaver is switched off. Connect the shaver to the adapter (Fig. A), then to the mains (Fig. B) and charge for at least 24 hours when using for the first time (Fig. C).
- ▶ R7130 – Place your shaver in the charging stand, connect the charging adaptor to the stand and then to the mains.
- ▶ Charge for at least 24 hours when using for the first time.
- ▶ After the shaver batteries are fully charged, the green indicator light will blink (R4130), the fuel gauge (R5130) or the LCD display (R6130/R7130) will indicate the shaver is fully charged.
- ▶ Use product until the battery is low. This is indicated by illuminated red light or the LCD display.
- ▶ Fully recharge for 24 hours every 6 months to maintain battery condition.
- ▶ When empty, the battery will be fully charged around 90 minutes for the R5130, R6130, R7130, and around 16 hours for the R4130.
- ▶ The shaver adapts automatically to a mains voltage between 100V and 240V.

ENGLISH

CORDED USE (R5130, R6130, R7130)

- ▶ Connect the shaver to the adapter, then to the mains and recharge for 5 min. before using.

CAUTION:

Extended mains only use will result in the reduction of the battery life.

HOW TO USE

SHAVING

- ▶ Switch the shaver on (Fig. D).
- ▶ Use the trimmer to remove long hair first (see below).
- ▶ Hold the shaving head so all three heads touch your face simultaneously (Fig.E). The independently floating heads will automatically adjust to the contours of your face.
- ▶ Stretch the skin with your free hand so the hairs stand upright.
- ▶ Only apply light pressure on the shaving head while shaving (pressing too hard can damage the heads and make them vulnerable to breakage).
- ▶ Use short, circular strokes.

TRIMMING

- ▶ Push the trimmer button down (Fig. F). Place trimmer at desired trim line for a quick, easy, professional trim. Hold the shaver as shown in the illustration (Fig. G). To retract and switch off the trimmer, push the trimmer lock button in and downwards (Fig. H).

TIPS FOR BEST RESULTS

Ensure your skin is dry. Always hold the shaver at right angles to the skin so that all three heads are touching the skin with equal pressure. Use moderate to slow stroking movements. The use of short circular motions in stubborn areas may obtain a closer shave, especially along the neck and chin line.

DO NOT press hard against the skin in order to avoid damage to the rotary heads.

CARE FOR YOUR SHAVER

Care for your product to ensure a long lasting performance. We recommend you clean your shaver after each use. Using the brush supplied clean the internal parts of the head assembly and shaver body. The easiest and the most hygienic way to clean the shaver is by rinsing the product head after use with warm water. Always keep the protective cap on the shaving head and keep the trimmer in the "off" position when the shaver is not in use.

■ CLEANING DAILY

- ▶ Ensure the shaver is switched off and unplugged from the mains.
- ▶ Open the shaver head by pressing the release button on the front of the shaver (Fig. I) and flipping open the head away from the body of the shaver (Fig. J).
- ▶ Rinse the shaver head with warm water (Fig. K).
- ▶ Close head assembly (Fig. L).

■ CLEANING WEEKLY

- ▶ Perform the daily cleaning steps first.
- ▶ Open the shaver head by pressing the release button on the front of the shaver (Fig. I) and flipping open the head away from the body of the shaver (Fig. J).
- ▶ Release the inner cutter carrier by rotating the locking arms counter-clockwise (Fig. M)
- ▶ Pull the inner cutter carrier away from the inner cutters (Fig. N).
- ▶ Thoroughly brush hairs from the inner and outer cutters (Fig. P) and rinse out remaining debris .
- ▶ Replace inner cutter (Fig.O).
- ▶ Place the inner cutter carrier back onto the upper hairpocket and lock in place by rotating the locking arms clockwise until the arms 'click' into place (Fig. Q - R)

◆ CAUTION:

Never submerge your shaver in water. The shaver can be rinsed with water. The water temperature should not exceed 70 degrees. Attention. Unplug the shaver before cleaning with water. Keep the adaptor and cable dry.

■ CLEANING TRIMMER

Lubricate the teeth of the trimmer every six months with one drop of sewing machine oil.



ENGLISH



IMPORTANT SAFETY INSTRUCTIONS

WARNING – TO REDUCE THE RISK OF BURNS, ELECTROCUTION, FIRE, OR INJURY TO PERSONS:

- ▶ An appliance should never be left unattended when plugged in to a power outlet, except when charging. Keep the power adaptor and cord away from heated surfaces.
- ▶ Make sure the power adaptor and cord do not get wet.
- ▶ Do not plug or unplug the shaver with wet hands.
- ▶ Do not use the product with a damaged cord. A replacement can be obtained via the Remington® Service Center.
- ▶ Charge, use and store the product at a temperature between 15°C and 35°C.
- ▶ Always unplug from the mains when cleaning or when being used under running water. Only use parts supplied or recommended by Remington®.
- ▶ Do not submerge.
- ▶ Keep this product out of reach of children. The use of this appliance by persons with reduced physical, sensory or mental capabilities or lack of experience and knowledge can give cause to hazards. Persons responsible for their safety should give explicit instructions or supervise the use of the appliance.



TROUBLESHOOTING

- ▶ If your shaver battery is completely empty or the shaver has not been used for an extended period of time, the shaver may not start when operated using the cord. If this occurs, charge the shaver for approximately 15 sec. before shaving.
- ▶ Your shaver should be mainly used in cordless mode and only recharged when battery charge is low. Extended mains only use or continuous connection to the mains will result in the reduction of the battery life.



BATTERY REMOVAL

⚠ DANGER:

Once the shaver has been dismantled for disposal, do not attempt to reassemble and/or use.

- ▶ Unplug the shaver.
- ▶ Remove the head from the shaver (Press release button and pull head straight away from the shaver body)
- ▶ Using a small screwdriver, pry front cover from the shaver.
- ▶ Remove the 4 screws located on the front of shaver. (Fig. S)
- ▶ Remove rear cover from inner housing to expose batteries (Fig. T)
- ▶ Pry batteries free from circuit board and cut wires (Fig. U – V)
- ▶ Dispose of batteries



PROTECT THE ENVIRONMENT

This appliance contains an environmental friendly rechargeable Nickel Metal Hydride battery. Do not dispose the appliance or the battery in the household waste as restrictions exist in most countries. Adhere to the national or local regulations for collection and disposal that apply for your specific location. In case you are required to remove the battery from the appliance for separate disposal see instructions in the 'Battery Removal' section on how to open the housing. For further information on recycling see www.remington-europe.com

⚠ CAUTION:

Do not put in fire or mutilate your battery packs as they may burst or release toxic materials.



For further information on recycling see www.remington-europe.com



ENGLISH



SERVICE AND WARRANTY

This product has been checked and is free of defects. We warrant this product against any defects that are due to faulty material or workmanship for a 2 year period from the original date of consumer purchase. If the product should become defective within the warranty period, we will repair any such defect or elect to replace the product or any part of it without charge provided there is proof of purchase. This does not mean an extension of the warranty period.

In the case of a warranty simply call the Remington® Service Center in your region.

This warranty is offered over and above your normal statutory rights.

The warranty shall apply in all countries in which our product was sold via an authorised dealer.

This warranty does not include shaving heads / foils and cutters which are consumable parts. Also not covered is damage to the product by accident or misuse, abuse, alteration to the product or use inconsistent with the technical and/or safety instructions required. This warranty shall not apply if the product has been dismantled or repaired by a person not authorised by us.



