

REMINGTON

# REMINGTON

## BATTERY OPERATED GROOMING KIT



Model No. PG155

09/UK/ PG155 Version 02/09 Part No. T22-28164  
REMINGTON® is a Registered Trade Mark of Spectrum Brands, Inc., or one of its subsidiaries  
VARTA Consumer Batteries GmbH & Co. KGaA  
Alfred-Krupp-Str.9  
73479 Ellwangen  
Germany  
www.remington-europe.com  
© 2009 SBI



PG155

REMINGTON



3.

1.

2.

7.

4.

5.

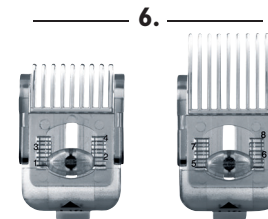

6.





## REMINGTON® SERVICE HOTLINE

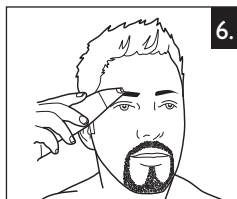
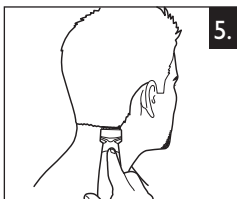
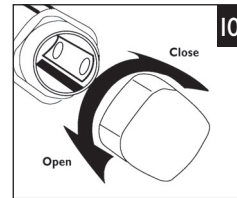
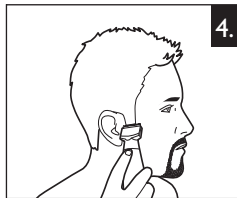
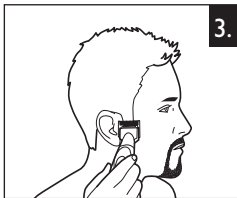
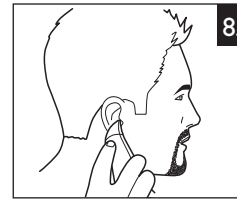

### United Kingdom

**+44 0800 212 438 (free call)**

Rayovac Europe Ltd,  
Watermans House, Kingsbury Crescent,  
The Causeway, Staines, Middlesex,  
TW18 3BA, UNITED KINGDOM

[www.remington.co.uk](http://www.remington.co.uk)

# ENGLISH

Thank you for choosing Remington®. Our products are designed to meet the highest standard of quality, functionality and design. We hope you enjoy using your new Remington® product. Please read the instructions for use carefully and keep in a safe place for future reference.



## CAUTION

- ◆ Use this appliance only for its intended use as described in this manual. Do not use attachments not recommended by Remington®.
- ◆ Do not use this product if it is not working correctly, if it has been dropped or damaged, or dropped into water.



## DESCRIPTION

1. On/Off Switch
2. Groomer
3. Trimmer attachment (17mm)
4. MiniScreen shaver attachment
5. Fine trimmer attachment
6. 2 adjustable guide combs (for 17mm trimmer)
7. Storage stand



## GETTING STARTED

Be patient when first using your Battery Operated Personal Groomer. As with any new product, it may take a little while to familiarise yourself with the product. Take the time to acquaint yourself with your groomer, as we are confident you will receive years of enjoyable use and complete satisfaction.

# ENGLISH

## ■ INSERTING BATTERIES

Your battery operated personal groomer requires 2 'AAA' Alkaline batteries (first set included). We recommend that you use VARTA® batteries.

- ▶ Make sure the product is turned off.
- ▶ Rotate the battery compartment cap approximately  $\frac{1}{4}$  turn anti-clockwise then pull off (Diagram 10 ).
- ▶ Insert 2 'AAA' alkaline batteries, so that the (+) and (-) marks on the battery face the same mark in the battery compartment.
- ▶ Place cap back on unit using the alignment marks and rotate clockwise until the cap snaps into place.

NOTE: Your battery operated personal groomer will not work if the batteries are inserted incorrectly.

NOTE: Remove batteries if the unit is not in use for long periods.



## HOW TO USE

## ■ ADJUSTABLE GUIDE COMBS

The adjustable guide combs give 8 different trim lengths. To fasten the guide combs, place the front hooks of the guide comb over the front of the groomer's trimmer head and pivot onto backside of the trimmer head to lock into place. To remove, push up on tab on back of hair length attachment.

Small guide comb	Large guide comb
No guide comb = 0,5 mm	No guide comb = 0,5 mm
1 = 4 mm	5 = 12 mm
2 = 6 mm	6 = 14 mm
3 = 8 mm	7 = 16 mm
4 = 10 mm	8 = 18 mm

If you are trimming for the first time, start with the maximum trimming length setting.

Always ensure the groomer is off before changing the guide combs.

# ENGLISH

## BEFORE YOU BEGIN

Always comb facial hair with a fine comb before you start trimming. Hairs should be dry and without any waxes or lotions before using the groomer.

### ■ TO THIN AND TAPER BEARDS OR MOUSTACHES (Diagram 1)

- ▶ Attach the trimmer blade.
- ▶ Place the guide comb on the trimmer blade and select the desired length.
- ▶ Start trimming under your chin, following your jawline. Work toward your ear and upper beard line using an upward motion.

### ■ TO TRIM EDGE OF BEARD OR MOUSTACHE (Diagram 2)

- ▶ Attach the trimmer blade.
- ▶ Hold groomer with cutting blade facing you.
- ▶ Start with edge of beard/moustache line, and with the cutting blades resting lightly against your skin, use slow movements to create a beard/moustache line.

### ■ TO TRIM SIDEBURNS (Diagram 3)

- ▶ Attach the trimmer blade.
- ▶ Comb sideburns in the direction of your hair growth.
- ▶ Place the guide combs on the trimmer blade and select the desired length
- ▶ Trim sideburns using a downward motion.

### ■ TO TRIM EDGE OF SIDEBURNS (Diagram 4)

- ▶ Attach the trimmer blade.
- ▶ Hold groomer with cutting blade facing you.
- ▶ Trim hairs around the edge of your sideburns using well-controlled movements to trim hair.

### ■ TRIMMING THE NAPE OF YOUR NECK (Diagram 5)

- ▶ Attach the trimmer blade.
- ▶ Use your fingers to lift the hair at the base of your head up off the neck. Your index finger should be covering the roots of the hairs you are lifting to prevent accidental removal by groomer.
- ▶ Using your other hand, hold the groomer to the base of your neck with the cutting unit facing up, and move the groomer up the length of the neck until the unit touches your finger covering the hair roots at the base of your head. Move the unit slowly when performing this operation and to keep the hair roots at the base of your head out of the way of the groomer.

### ■ TO REMOVE HAIR FROM EYEBROWS (Diagram 6)

- ▶ Attach fine trimmer attachment.
- ▶ Gently guide cutting unit to stray, unwanted hairs along the eyebrow line or protruding from the eyebrow itself.
- ▶ To remove the hairs completely lower onto the skin and move over desired area.
- ▶ Use slow and well-controlled movements.

## ENGLISH

### ■ TO REMOVE HAIR FROM NOSE AND EAR (Diagram 7 & 8)

- ▶ Attach fine trimmer attachment.
- ▶ Insert the personal groomer gently into nostril or ear.
- ▶ Gently move the groomer in and out of the nostril or ear and at the same time rotate.
- ▶ Avoid inserting the cutting unit more than 6mm into your nostril or ear.

### ■ USING YOUR MINISCREEN SHAVER (Diagram 9)

- ▶ Attach the MiniScreen shaver.
- ▶ Hold the groomer so the MiniScreen gently touches your face in a 45 degree angle.
- ▶ Use short, and well-controlled movements to shave around your beard/moustache. Use your free hand to stretch your skin. This encourages the hair to stand upright, making it easier to shave.

Note: The MiniScreen shaver was designed to shave the detail areas around your beard/moustache/sideburns. It was not designed to shave your entire face. For a close comfortable shave, guaranteed, use one of Remington®'s electric shavers.

### Tips for best results

- ▶ Comb your hair in the direction that it grows so that the hairs are at their maximum height and facing in the same direction.
- ▶ After trimming, lightly go over the trimmed areas with the foil to get a smooth clean finish.
- ▶ Since all hairs do not grow in the same direction, you may want to try different trimming positions (i.e. upwards, downwards or across) for better results.



## CARE FOR YOUR GROOMER

Care for your product to ensure a long lasting performance. We recommend that you clean your groomer after each use. Always keep the protective cap on the shaving head and keep the groomer in the "off" position when the shaver is not in use.

### ■ REMOVING THE FOIL

1. Ensure the groomer is off.
2. Hold the groomer in one hand, with the other gently pull the foil casing off the groomer.
3. Remove head and tap on a flat surface to remove the hair particles. Do not touch the foil while cleaning. Use a small soft brush to remove remaining hairs from the cutters.
4. To replace, push the foil casing down until you hear a click and it is firmly attached.

### ◆ CAUTION

Do not clean the shaving foil with the brush.

## ENGLISH

### AFTER EACH USE

- ▶ Gently tap on a flat surface to remove hair particles, and brush the remaining hairs away.
- ▶ Wipe the main unit with a damp cloth and dry immediately.

### STORAGE

- ▶ Always store this appliance in a moisture-free area.



## IMPORTANT SAFETY INSTRUCTIONS

### WARNING – TO REDUCE THE RISK OF BURNS, ELECTROCUTION, FIRE, OR INJURY TO PERSONS:

- ▶ Only use the parts supplied with the appliance.
- ▶ Always remember to turn on the groomer before you insert it into your nose or ear to avoid injury.
- ▶ Do not disassemble cutter assembly.
- ▶ Keep this product out of reach of children. The use of this appliance by persons with reduced physical, sensory or mental capabilities or lack of experience and knowledge can give cause to hazards. Persons responsible for their safety should give explicit instructions or supervise the use of the appliance.



## PROTECT THE ENVIRONMENT

The appliance contains Alkaline batteries. Do not dispose the appliance or the batteries in the household waste as restrictions exist in most countries. Adhere to the national or local regulations for collection and disposal that apply for your specific location.



For further information on recycling see [www.remington-europe.com](http://www.remington-europe.com)

### CAUTION:

Do not put in fire or mutilate your battery packs as they may burst or release toxic materials.



**ENGLISH**



## **SERVICE & WARRANTY**

This product has been checked and is free of defects. We warrant this product against any defects that are due to the faulty material or workmanship for a 2 year period from the original date of consumer purchase. If the product should become defective within the warranty period, we will repair any such defect or elect to replace the product or any part of it without charge provided there is proof of purchase. This does not mean an extension of the warranty period.

In the case of a warranty simply call the Remington® Service Centre in your region.

This warranty is offered over and above your normal statutory rights.

The warranty shall apply in all countries in which our product was sold via an authorised dealer.

This warranty does not include shaving heads / foils and the cutters which are consumable parts. Also, not covered is damage to the product by accident or misuse, abuse, alteration to the product or use inconsistent with the technical and/or safety instructions required. This warranty shall not apply if the product has been dismantled or repaired by a person not authorised by us.

