

REMINGTON®
style inspirations

Multi Style



S8670

5in1



REMINGTON

Glamour Multi Styler Kit



Fig 1

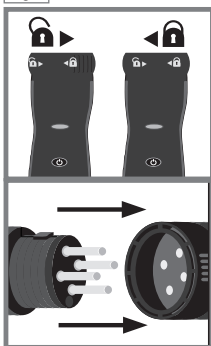

Fig 2

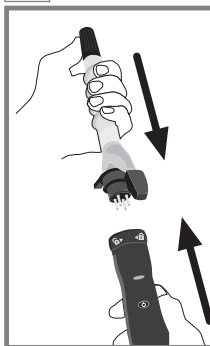
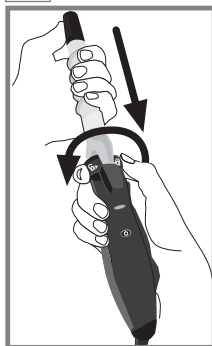

Fig 3



ENGLISH

Thank you for buying your new Remington® product.

Before use, please read the instructions carefully, and keep them in a safe place for future reference.



PRODUCT FEATURES

- A** Advanced ceramic coating
- B** Ready to use in 60 secs
- C** On/Off button
- D** Adjustable +/- temperature buttons
- E** LED temperature indicator lights – flashes when unit is heating up, and stops flashing once the desired temperature has been reached.
- F** Cool tips for easy styling
- G** 19mm tong to create curls
- H** Spiral sleeve to create loose curls
- I** Brush sleeve to create waves and volume
- J** Interchangeable straightening and crimping plates – Double sided attachment – simply slide attachment out, turn over and slide back in to switch between plates.
- K** 4 Sectioning clips
- L** Locking ring
- M** Heat protection stand
- N** Automatic Safety shut off in one hour
- O** Stylish storage bag – please wait until attachments are cool before putting them in the storage bag.

3 year guarantee



INSTRUCTIONS FOR USE

- ▶ Before use, make sure hair is clean, dry and tangle-free.
- ▶ Section hair using sectioning clips and style the lower layers first.



ENGLISH

■ TO CHANGE THE STRAIGHTENING/CRIMPING PLATES

- Ensure the unit is switched off and cool.
- Slide the plates out holding the plastic edges.
- Turn the plates over and slot back into place.

■ TO SECURE ATTACHMENT TO HANDLE

- Ensure the locking ring is in the unlocked position, ready to insert the attachment. Locate the pins on the attachment and holes on the handle. (DIAGRAM 1)
 - Firmly push together. (DIAGRAM 2)
 - Turn the locking ring anti-clockwise to secure the handle and the attachment together, while still pressing down on the attachment (DIAGRAM 3).
-
- ▶ Plug in the unit and switch on, the first green LED indicator light will start flashing.
 - ▶ NOTE: The unit will not turn on unless the attachment is inserted correctly.
 - ▶ Select the desired temperature. To change the temperature, use the '+' or '-' buttons to increase or decrease the temperature. The LED lights will flash until your desired temperature has been reached. After use switch the unit off.
 - ▶ For finer hair types a lower temperature is recommended.



IMPORTANT INSTRUCTIONS

- ▶ Due to the extreme heat capabilities of this styler, extra care should be taken when using.
- ▶ While heating, during use and cooling, place on flat, smooth, heat-resistant surface. Only hold unit at the end of the handle.
- ▶ Please note regular use of styling products may deteriorate the coating.
- ▶ Do not scratch the surface, as this will deteriorate the effectiveness of the coating.



CLEANING AND MAINTENANCE

Ensure the unit is unplugged and cool. Wipe clean any build up of styling products with a damp cloth. Do not use an abrasive cleaning fluid to clean, as damage will occur.



SAFETY CAUTIONS

WARNING – FOR ADDITIONAL PROTECTION THE INSTALLATION OF A RESIDUAL CURRENT DEVICE (RCD) WITH A RATED RESIDUAL OPERATING CURRENT NOT EXCEEDING 30mA IS ADVISABLE. ASK AN ELECTRICIAN FOR ADVICE.



ENGLISH

WARNING – THIS APPLIANCE MUST NOT BE TAKEN INTO A BATHROOM. IT SHOULD NOT BE USED NEAR BATHTUBS, SHOWERS, BASINS OR OTHER VESSELS CONTAINING WATER OR OTHER LIQUIDS.



This product is not suitable for use in bath or shower.

THE STYLER SHOULD BE UNPLUGGED FROM MAINS SUPPLY WHEN NOT IN USE.

- ▶ Do not leave the styler unattended when switched on.
- ▶ Allow the styler to cool down before storage.
- ▶ Do not immerse in water or other liquids.
- ▶ Do not place styler on soft material e.g. carpet, bedding, towels, rugs etc.
- ▶ Always ensure the voltage to be used corresponds to the voltage stated on the unit.
- ▶ Keep this product out of reach of children. The use of this appliance by persons with reduced physical, sensory or mental capabilities or lack of experience and knowledge can give cause to hazards. Persons responsible for their safety should give explicit instructions or supervise the use of the appliance.
- ▶ Do not use any attachments with this styler, other than those supplied by Remington®.
- ▶ Avoid allowing any part of the hot plates to contact the face, neck or scalp.
- ▶ Do not wrap the cord around the unit. Check cord regularly for any sign of damage.
- ▶ Damaged cords can be dangerous. If the supply cord of this unit becomes damaged, discontinue use immediately and return the appliance to your nearest authorised Remington® service dealer for repair or replacement in order to avoid a hazard.
- ▶ Special tools are required for any examination, adjustment or repair. Unqualified repair work could lead to hazardous conditions for the user.
- ▶ We do not accept responsibility for damage to the product, persons or other items(s), caused by misuse, abuse or non-compliance with these instructions.
- ▶ This appliance is not intended for commercial or salon use.



WIRING INSTRUCTIONS UK Plugs Only

This product is fitted with a BS1363 plug fused at 13A. If the plug is unsuitable, it should be disconnected and an appropriate plug fitted as detailed below. If it is necessary to replace the plug fuse, use only fuses that are approved to BS1362, rated at 13A. If in doubt consult a qualified electrician.

The wires in the mains lead are coloured in accordance with following code:

BLUE - NEUTRAL
BROWN - LIVE



ENGLISH

As the colours of the wires in the mains lead of this appliance may not correspond with the coloured markings identifying the terminals in your plug, proceed as follows:
The wire which is coloured BLUE must be connected to the terminal which is marked 'N' or coloured BLACK. The wire which is coloured BROWN must be connected to the terminal which is marked 'L' or coloured RED. Never connect either of the wires to the big EARTH terminal marked 'E' or coloured GREEN or GREEN AND YELLOW.



PROTECT THE ENVIRONMENT

Do not dispose the product in household waste at the end of its useful life. Disposal can take place at the Remington® Service Centre or appropriate collection sites.



For further information on recycling see www.remington-europe.com



SERVICE AND WARRANTY

This product has been checked and is free of defects. We warrant this product against any defects that are due to faulty material or workmanship for the warranty period from the original date of consumer purchase. If the product should become defective within the warranty period, we will repair any such defect or elect to replace the product or any part of it without charge provided there is proof of purchase. This does not mean an extension of the warranty period.

In the case of a warranty simply call the Remington® Service Center in your region.

This warranty is offered over and above your normal statutory rights.

The warranty shall apply in all countries in which our product was sold via an authorised dealer.

This warranty does not include damage to the product by accident or misuse, abuse, alteration to the product or use inconsistent with the technical and/or safety instructions required. This warranty shall not apply if the product has been dismantled or repaired by a person not authorised by us.



REMINGTON® SERVICE HOTLINE

United Kingdom

 **+44 0800 212 438 (free call)**

Rayovac Europe Ltd,
Watermans House, Kingsbury Crescent,
The Causeway, Staines, Middlesex,
TW18 3BA, UNITED KINGDOM

www.remington.co.uk



Model No. S8670

10/UK /S8670 Version 06/10 Part No. T22-30827

REMINGTON® is a Registered Trade Mark of Spectrum Brands, Inc., or one of its subsidiaries

VARTA® Consumer Batteries GmbH & Co. KGaA

Alfred-Krupp-Str.9

73479 Ellwangen

Germany

www.remington-europe.com

© 2010 SBI

