

REMINGTON

REMINGTON®

ALL IN ONE GROOMING KIT FOR PRECISE STYLING AND FINISH

All technical modifications reserved 09/08 TSC 080633



Model No. PG520

11/UK/PG520 Version 08/11 Part No. T22-32270
REMINGTON® is a Registered Trade Mark of Spectrum Brands, Inc., or one of its subsidiaries
VARTA Consumer Batteries GmbH & Co. KGaA
Alfred-Krupp-Str.9
73479 Ellwangen
Germany
www.remington-europe.com



PG520

REMINGTON

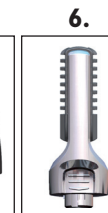



REMINGTON

REMINGTON® SERVICE HOTLINE

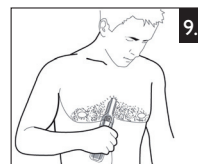
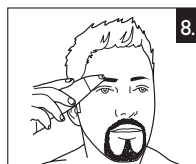
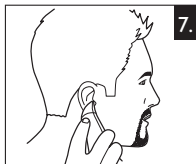
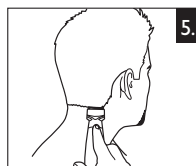
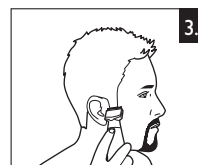
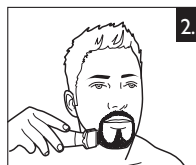

United Kingdom

 **+44 0800 212 438 (free call)**

Spectrum Brands (UK) Limited,
Fir Street, Failsworth,
Manchester,
M35 0HS, UNITED KINGDOM

www.remington.co.uk



ENGLISH

REMINGTON

Thank you for choosing Remington®. Our products are designed to meet the highest standard of quality, functionality and design. We hope you enjoy using your new Remington® appliance. Please read the instructions for use carefully and keep in a safe place for future reference.



CAUTION

- ◆ Use this appliance only for its intended use as described in this manual. Do not use attachments not recommended by Remington®.
- ◆ Do not use this product if it is not working correctly, if it has been dropped or damaged, or dropped into water.



DESCRIPTION

1. On/Off Switch
2. 30mm trimmer attachment
3. 17mm trimmer attachment
4. Nose & Ear trimmer attachment
5. MiniScreen shaver attachment
6. Body Hair trimmer attachment
7. 2 guide combs
8. Charging indicator light
9. Charging adaptor
10. Charging stand

ENGLISH



GETTING STARTED

■ CHARGING YOUR PERSONAL GROOMER

Before using your personal groomer for the first time, charge for 14-16 hours.

- ▶ Ensure the product is switched off.
- ▶ Place your personal groomer into the charging stand, connect the charging adaptor to the product and then to the mains. The charging indicator will light up.

Your personal groomer cannot be overcharged. However, if the product is not going to be used for an extended period time (2-3 months), unplug it from the mains and store. Fully recharge your personal groomer when you would like to use it again.

To preserve the life of your batteries, let them run out every six months then recharge for 14-16 hours.

◆ CAUTION:

Extended mains only use will result in the reduction of the battery life.



HOW TO USE

■ BEFORE YOU BEGIN

Always comb your beard or moustache with a fine comb before you start trimming.

■ ATTACHING AND REMOVING THE GUIDE COMBS

- ▶ With the trimmer blade facing away from you, slide the guide comb on top of the clipper blade and click into position.
- ▶ With the trimmer blade facing away from you, carefully push the guide comb away from the trimmer blade.

■ TO THIN AND TAPER THE BEARD/MOUSTACHE (Diagram 1)

- ▶ Attach a guide comb to the 30mm Trimmer Blade. If you are trimming for the first time start with the maximum trimming length setting.
- ▶ Turn the unit on.
- ▶ Place the flat top of the trimmer comb against the skin.
- ▶ Slowly slide the personal groomer through the hair. Repeat from different directions as necessary.
- ▶ If hair builds up in the trimmer comb during the trimming process, switch the unit off, pull off the comb and brush/rinse off.

■ TO DEFINE THE BEARD/MOUSTACHE LINE (Diagram 2)

- ▶ Hold the personal groomer with 17mm Trimmer Blade facing you.
- ▶ Start with edge of beard/moustache line and gently lower the trimmer blade onto your skin. Use motions towards edge of beard/moustache line to trim to desired locations in facial area and away from beard in neck area.

■ TRIMMING EDGE OF SIDEBURNS (Diagram 3)

- ▶ Hold the personal groomer with 17mm Trimmer Blade facing you.
- ▶ Start with edge of sideburn, and with the trimmer blades resting lightly against your skin, use motions towards edge of sideburn line to trim to desired locations in facial area.

■ USING THE MINISCREEN SHAVER (Diagram 4)

- ▶ Attach the MiniScreen shaver
- ▶ Hold the groomer so the MiniScreen gently touches your face in a 45 degree angle.
- ▶ Use short, well-controlled movements to shave around your Beard/Moustache. Use your free hand to stretch your skin. This encourages the hair to stand upright, making it easier to shave.

Note: The MiniScreen shaver was designed to shave the detail areas around your beard/moustache/sideburns. It was not designed to shave your entire face. For a close comfortable shave, guaranteed, use one of Remington®'s electric shavers.

■ TRIMMING THE NAPE OF YOUR NECK (Diagram 5)

Note: You will need a hand mirror for this operation if performing it alone.

- ▶ Before you begin, attach the 30mm Trimmer Blade.
- ▶ Use your fingers to lift the hair at the base of your head up off the neck. Your index finger should be covering the roots of the hairs you are lifting to prevent accidental removal by the personal groomer.
- ▶ Using your other hand, hold the personal groomer to the base of your neck with the cutting unit facing up, and move the personal groomer up the length of the neck until it touches your finger covering the hair roots at the base of your head.
- ▶ Be sure to move the unit slowly when performing this operation and to keep the hair roots at the base of your head out of the way of the trimmer.

■ TO REMOVE HAIR FROM NOSE AND EAR (Diagram 6 & 7)

- ▶ Attach Nose & Ear trimmer attachment.
- ▶ Insert the personal groomer gently into nostril or ear.
- ▶ Gently move the groomer in and out of the nostril or ear and at the same time rotate.
- ▶ Avoid inserting the cutting unit more than 6mm into your nostril or ear.

■ TO REMOVE HAIR FROM EYEBROWS (Diagram 8)

- ▶ Attach 17mm trimmer attachment.
- ▶ Gently guide cutting unit to stray, unwanted hairs along the eyebrow line or protruding from the eyebrow itself.
- ▶ To remove the hairs completely lower onto the skin and move over desired area.
- ▶ Use slow and well-controlled movements.

ENGLISH

■ ATTACHING AND REMOVING THE TRIMMER COMB ATTACHMENT

Note: Always ensure the personal groomer is switched off before changing any attachments.

- ▶ To remove, hold the personal groomer with one hand and turn the trimmer head anti-clockwise with the other.
- ▶ To attach, hold the personal groomer with one hand and turn the trimmer head clockwise with the other.

Tips for best results

- ▶ Beard, moustache and sideburn hairs should be dry.
- ▶ Avoid using lotions before using your personal groomer. Comb your hair in the direction that it grows.
- ▶ Remove trimmer comb attachment if you are: defining hairline edges such as sideburns, trimming the nape of your neck, trimming your beard line on front of neck.

■ TO REMOVE OR TRIM HAIR ON BODY (Diagram 9)

TRIMMING BODY HAIR

- ▶ Attach Body Hair trimmer attachment head.
- ▶ To achieve the desired hair length, change the guide comb by easily sliding it onto one of the three slots on the attachment head. The different slots represent 2.8mm, 5.6mm & 9.6mm hair lengths.
- ▶ Place the flat top of the trimmer comb against the skin.
- ▶ Slowly slide the trimmer through the hair, in the direction of hair growth.
- ▶ Use slow and well-controlled movements.
- ▶ If hair builds up in the guide comb during the trimming process, switch the unit off, pull off the guide comb. Brush trimmer / rinse comb.

REMOVING BODY HAIR

- ▶ To remove the hairs completely, trim the hair down to 1.2mm without attaching the guide comb and then change to the Mini Screen attachment head.
- ▶ Hold the shaving head to your skin.
- ▶ Stretch your skin with your free hand so hairs stand upright.
- ▶ Only apply light pressure on the shaving head whilst shaving.
- ▶ Shave against hair growth.

ENGLISH

REMINGTON



CARE FOR YOUR PERSONAL GROOMER



CLEANING AND MAINTAINING YOUR PERSONAL GROOMER

AFTER EACH USE

1. Turn the personal groomer off.
2. Gently brush the remaining hairs away/rinse under warm water from the guide comb and trimmer blade.

CLEANING CAUTIONS

- ▶ Only the guide comb attachment and trimmer blade may be removed from the product for cleaning.
- ▶ Cleaning should only be done with a soft brush, such as the brush supplied with the product. If rinsing under water, rinse only the attachments under warm running water. Do not use hot water as this might cause damage.
- ▶ Only use the light-grade oil supplied or sewing machine oil on the blades.
- ▶ Do not use harsh or corrosive cleaners on the units or their blades.
- ▶ Do not submerge in water as damage will occur.
- ▶ Never use the cleaning brush on the foils as damage may occur.
- ▶ At regular intervals, put a drop of lubricant onto the shaving frame/head.

STORAGE

- ▶ Always store this appliance and cord in a moisture-free area. Do not store it in temperatures exceeding 140°F (60°C).
- ▶ Do not wrap the cord of the charging adaptor around the appliance.



IMPORTANT SAFETY INSTRUCTIONS

WARNING – TO REDUCE THE RISK OF BURNS, ELECTROCUTION, FIRE, OR INJURY TO PERSONS:

- ▶ An appliance should never be left unattended when plugged into a power outlet.
- ▶ Keep the power plug and cord away from heated surfaces.
- ▶ Make sure the power plug and cord do not get wet.
- ▶ Do not plug or unplug the shaver with wet hands.
- ▶ Do not use the product with a damaged cord. A replacement can be obtained via the Remington® Service Center.
- ▶ Charge, use and store the product at a temperature between 15°C and 35°C
- ▶ Always unplug from the mains when cleaning.
- ▶ Only use the parts supplied with the appliance.
- ▶ Keep this product out of reach of children. The use of this appliance by persons with

ENGLISH

reduced physical, sensory or mental capabilities or lack of experience and knowledge can give cause to hazards. Persons responsible for their safety should give explicit instructions or supervise the use of the appliance.



PROTECT THE ENVIRONMENT

This appliance contains an environmentally friendly rechargeable Nickel Metal Hydride battery. Do not dispose of the appliance or the battery in the household waste as restrictions exist in most countries. Adhere to national or local regulations for collection and disposal that apply to your specific location. In case you are required to remove the battery from the appliance for separate disposal see the instructions in the 'Battery Removal' section on how to open the housing.

⚠ CAUTION:

Do not put in fire or mutilate your battery packs as they may burst or release toxic materials.

For further information on recycling see www.remington-europe.com



BATTERY REMOVAL

The battery must be removed from the appliance before it is scrapped. The battery is to be disposed of safely.

1. Remove rear groomer cover by first prying the rubber panel from the product with a flat head screwdriver. Pry the on/off switch from the product with a flat head screwdriver. Unscrew the front cover from the product by Philips head screwdriver. Unscrew the upper housing by Philips head screwdriver and pry the upper housing from the product with a flat head screwdriver. This will expose the batteries.
2. With wire cutters, clip the wires leading to the batteries.
3. Remove the batteries from the product. Contact your local authorities for proper disposal.



SERVICE AND WARRANTY

This product has been checked and is free of defects. We warrant this product against any defects that are due to the faulty material or workmanship for a 2 year period from the



ENGLISH

REMINGTON

2 years
From the original date of consumer purchase. If the product should become defective within the warranty period, we will repair any such defect or elect to replace the product or any part of it without charge provided there is proof of purchase. This does not mean an extension of the warranty period.

In the case of a warranty simply call the Remington® Service Centre in your region.

This warranty is offered over and above your normal statutory rights.

The warranty shall apply in all countries in which our product was sold via an authorised dealer.

This warranty does not include shaving heads / foils and the cutters which are consumable parts. Also, not covered is damage to the product by accident or misuse, abuse, alteration to the product or use inconsistent with the technical and/or safety instructions required. This warranty shall not apply if the product has been dismantled or repaired by a person not authorised by us.