

# REMINGTON REVEAL

BEAUTY TRIMMER



MPT4000C

Register online for  
£10,000 prize draw  
EXTRA year guarantee  
FREE rewards gallery



Visit [www.remington.co.uk/product/register](http://www.remington.co.uk/product/register)  
You must register within 28 days  
of purchase.

Thank you for buying your new Remington® product.  
Please read these instructions carefully and keep them safe.  
Remove all packaging before use.

### ⚠ IMPORTANT SAFEGUARDS

- 1 This appliance can be used by children aged from 8 years and above and persons with reduced physical, sensory or mental capabilities or lack of experience and knowledge if they have been supervised/instructed and understand the hazards involved. Children shall not play with the appliance. Cleaning and user maintenance shall not be done by children unless they are older than 8 and supervised. Keep the appliance and cable out of reach of children under 8 years.
- 2 Do not use attachments other than those we supply.
- 3 Do not use the appliance if it is damaged or malfunctions.
- 4 Store the product at a temperature between 15°C and 35°C.
- 5 This appliance is battery operated only.
- 6 This product uses alkaline batteries. At the end of their life the batteries must be removed from the appliance and be recycled or disposed of properly in accordance with your state and local requirements.
- 7 Do not put in fire or mutilate your batteries when disposing as they may burst and release toxic materials.
- 8 Do not short circuit as it may cause burns.
- 9 Turn off when cleaning.
- 10 Do not immerse the appliance in liquid; do not use it near water in a bath-tub, basin or other vessel; and don't use it outdoors. 
- 11 This appliance is not intended for commercial or salon use.



## 👁 KEY FEATURES

### ✦ Trimmer:

- 1 Dual Blade Trimmer
- 2 Flexing Head
- 3 Eyebrow Comb
- 4 Protective Cap
- 5 On/Off Switch
- 6 Battery Compartment
- 7 Detail Light
- 8 Cleaning Brush (not shown)

### ✦ Tweezers:

- 9 LED On/Off Switch
- 10 Battery Compartment

## 👁 GETTING STARTED

### ✦ Inserting Batteries: Trimmer

- Your appliance requires 1 'AAA' alkaline battery (first one included). We recommend that you use VARTA® batteries.
- Ensure the product is switched off.

- Hold the upper part of the trimmer and gently slide the lower part off.
- Insert 1 alkaline 'AAA' battery positive end down.
- Slide the bottom part back onto the unit, ensuring the notch slides over the On/Off switch.

#### ✦ **Inserting Batteries: Tweezers**

- Your tweezers come with 3 x cell batteries (included).

#### ✦ **To Change the Batteries:**

- Unscrew the battery compartment (anticlockwise) (fig. 1).
- Remove the old batteries from the battery compartment.
- Replace with new batteries with the positive end facing up (fig. 2).
- Screw the battery compartment back together (clockwise) (fig. 3).

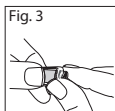
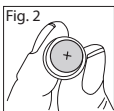
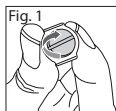

### ◆ **INSTRUCTIONS FOR USE**

- ✦ The beauty trimmer gently removes unwanted hair and is ideal for use on the face, neckline, nose, ears and other small areas.

- ✦ The small trimmer and eyebrow comb are also ideal for shaping and styling the eyebrows.

- Turn the trimmer on by using the on/off switch.
- Push the switch up to the first groove to turn the trimmer on.
- Push the switch up to the second groove to turn the trimmer and detail light on.

#### ✦ **To Trim Unwanted Hair**

- Use the larger trimmer.
- Hold the trimmer against the skin and apply gentle pressure.
- Trim against the direction of hair growth.

#### ✦ **To Trim the Length of Eyebrows**

- The detail trimmer has an eyebrow comb that has two length options.
- Choose length setting; LONG or SHORT (we recommend starting with long).
- Ensure the trimmer is OFF and slide the comb over the trimmer blades.
- Make sure that the teeth of the comb are facing the same direction as the larger trimming blade.

- To turn the trimmer on, slide the ON switch towards the trimming blades.
- To turn on the detail light, push the ON switch up again in the same direction.
- With the comb at a 45° angle to your skin, gently move the trimmer in the direction of hair growth.

### ✦ To Shape the Eyebrows

- Remove the eyebrow comb.
- Hold the detail trimmer at a right angle to your skin and press down gently.
- Edge and shape the area as desired.
- The small trimmer blade is ideal for precision trimming and small areas.

### ✦ CREATE THE PERFECT BROW

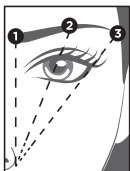

1 Begin Brow

2 Arch (Highest Point)

3 End Brow

### ✦ CAUTION

- Do not apply excessive pressure, doing so may damage the trimmer head or result in skin injury.
- Never insert the trimmer more than ¼" (6mm) into nose or ear. Foreign objects should not come into contact with the eardrum.

### 👁️ CLEANING AND MAINTENANCE

- Use the cleaning brush provided to brush any hairs from the trimmer. You could also wipe the handle with a damp cloth.
- ✦ Note: Ensure the trimmer is turned off before cleaning.

### ✦ Tweezers

- The tweezers can be used for precision finishing and to remove stubborn or shorter hairs.
- The tweezers are also ideal for shaping the eyebrows.
- The built in light reveals even the shortest hairs.
- To switch on the light press the on/off switch.

### ➡ Tips

- Use the tweezers after a warm shower or bath when your skin is relaxed and soft so hairs can be removed easily.

- Use one hand to stretch the skin and use the tweezers to grip the hair, then pull gently in the direction of the hair growth.



### **ENVIRONMENTAL PROTECTION**

To avoid environmental and health problems due to hazardous substances in electrical and electronic goods, appliances marked with this symbol must not be disposed of with unsorted municipal waste, but recovered, reused or recycled.



### **➡ SERVICE AND GUARANTEE**

Defects affecting product functionality appearing within the guarantee period will be corrected by replacement or repair at our option provided the product is used and maintained in accordance with the instructions.

Your statutory rights are not affected.

Consumables are excluded.

Defects from repair by an unauthorized dealer are not covered.

If you call the Service Centre, please have the Model No. to hand, as we won't be able to help you without it. The Model No. can be found on the rating plate of the appliance.

Replacement parts and accessories are available to buy at [www.remington.co.uk/parts-accessories](http://www.remington.co.uk/parts-accessories)

### **➡ SERVICE CENTRE**

#### **United Kingdom**



Tel 0800 212 438 (free call mainland UK)



+44 161 947 3111 (call outside the UK)

Spectrum Brands (UK) Ltd

Fir Street, Failsworth, Manchester

M35 0HS, UK

[www.remington.co.uk](http://www.remington.co.uk)

#### **Ireland**



Tel 142 951 40

Remington Consumer Products,

Unit B12, Ballymount Corporate Park,

Ballymount, Dublin 12.

[www.remington.co.uk](http://www.remington.co.uk)



### **REGISTER ONLINE FOR**

£10,000 prize draw, EXTRA year guarantee, FREE rewards gallery.

Visit [www.remington.co.uk/productregister](http://www.remington.co.uk/productregister). You must register within 28 days of purchase.



**Model No. MPT4000C**

15/UK/ MPT4000C T22-0003724 Version 10 /15

Remington® is a Registered Trade Mark of Spectrum Brands, Inc., or one of its subsidiaries.

Spectrum Brands (UK) Ltd

Fir Street,

Failsworth,

Manchester

M35 0HS

[www.remington.co.uk](http://www.remington.co.uk)

© 2015 SBI