

REMINGTON

PROFESSIONAL

Silk Rollers



H9096

Register online for
£10,000 prize draw
EXTRA year guarantee
FREE rewards gallery



Visit www.productregister.co.uk/remington.
You must register within 28 days
of purchase.

Thank you for buying your new Remington® product. Please read these instructions carefully and keep them safe.
Remove all packaging before use.

IMPORTANT SAFETY INSTRUCTIONS

- 1 This appliance can be used by children aged from 8 years and above and persons with reduced physical, sensory or mental capabilities or lack of experience and knowledge if they have been supervised/instructed and understand the hazards involved. Children shall not play with the appliance. Cleaning and user maintenance shall not be done by children unless they are older than 8 and supervised. Keep the appliance and cable out of reach of children under 8 years.
- 2 Always ensure the voltage to be used corresponds to the voltage stated on the unit before plugging the appliance into the mains socket.
- 3 Warning: Do not use this appliance near bathtubs, showers, basins or other vessels containing water. 
- 4 When the appliance is used in a bathroom, unplug it after use since the proximity of water presents a hazard even when the appliance is switched off.
- 5 Do not wrap the cord around the unit. Check the cord regularly for any sign damage.
- 6 If the supply cord of this unit becomes damaged, discontinue use immediately and return the appliance to your nearest authorised Remington® service dealer for repair or replacement in order to avoid a hazard.
- 7 Do not use the appliance if it is damaged or malfunctions.
- 8 Do not allow any part of the appliance touch the face, neck or scalp.
- 9 Do not leave the appliance unattended while plugged in.
- 10 Only set the appliance down on a heat-proof surface.
- 11 Do not place the appliance on any soft furnishings.
- 12 Do not use attachments other than those we supply.
- 13 This appliance is not intended for commercial or salon use.
- 14 Let the appliance cool down before cleaning and storing away.
- 15 Ensure rollers and heated clips are correctly placed on the heated rails not against the heated rail.
- 16 Always keep the lid closed while the rollers are heating.
- 17 Do not use on artificial hairpieces or wigs.

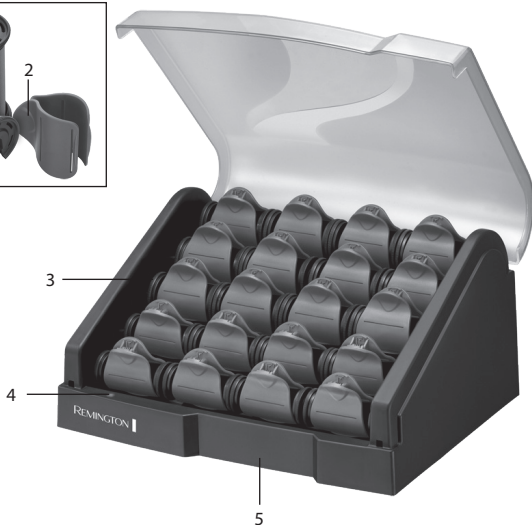
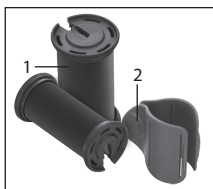

KEY FEATURES

- 1 Velvety flocked rollers:
8 x medium 25mm
12 x large 32mm
- 2 Silk ceramic heated hinged clips
- 3 Cool touch ends
- 4 On indicator light
- 5 Base unit

PRODUCT FEATURES

- 1 Silk ceramic with ionic conditioning for silky smooth, professional results.
- 2 Dual Heating Technology heats rollers and clips.
- 3 Sets curls in 5 minutes with long lasting results.
- 4 Fast heat up - ready in 90 seconds.

INSTRUCTIONS FOR USE

- 1 Before use, ensure the hair is clean, dry and tangle-free.
- 2 For extra protection use a heat protection spray.
- ★ Hairsprays contain flammable material – do not use while using this product.
- 3 Section the hair prior to styling. Style the lower layers first.
- 4 Plug the product into the mains power supply.
- ★ CAUTION : the appliance will begin to heat-up as soon as the power supply is switched on.
- 5 The lid should be in the down position until the rollers are ready to use.
- 6 Rollers will be ready in 90 seconds. Allow 3 to 5 minutes for best results.
- 7 For the most efficient heating, place the large rollers on the first 3 heated bars.
- 8 When you feel your setters are ready, open the lid for 1 minute and begin use.

★ TO CURL

- 9 Select the desired size of roller. Use the medium rollers for tighter curls; the larger rollers give looser curls and waves.
- 10 Take a section of hair, about the width of the roller.
- 11 Wrap the ends of the hair around the roller, keeping the hair at right angles to the scalp.
- 12 Wind the roller right down to the roots.
- 13 Secure the roller firmly in place with the clips as near to the scalp as possible.
- 14 Repeat with the next section of hair.
- 15 Leave all the rollers in the hair until the rollers and hair have fully cooled down and set the style.
- ★ Note: Use fixing spray to help set and keep your style for longer
- 16 For a soft, wavy curl, use the rollers for only a couple of minutes. For a tighter curl, leave the rollers in the hair for 5-10 minutes.
- 17 Rollers will remain actively curling for approximately 15 minutes.
- 18 Remove the rollers from your hair by removing each clip and gently unwinding.
- 19 Let the curl spring back into place and leave the hair to cool fully before styling to ensure the optimum set.

★ FOR VOLUME

- 20 Use the large rollers provided.
- 21 Roll the top, front layer of the hair back to your crown, using one roller.

- 22 Next, use three other rollers to roll the remaining hair in three equal sections on the back and sides of the head.
- 23 Roll the hair under, up the nape of the neck.

FLICKED OUT

- 24 Use the large rollers provided.
- 25 Roll the hair back and under to the crown to give height.
- 26 Take large sections all around the sides of your head and roll up so the hair will flip out.
- 27 You should roll the rollers up to the level of the top of your ear. Leave the rollers in place for approximately ten minutes.
- 28 Unroll the rollers in the order that you put them in, let the curl cool for a minute to set.
- 29 Next, brush your hair out, using your hands to shape the flip outward.
- 30 Unplug the unit after you have used all the rollers you need.
- 31 Let the appliance cool down before cleaning and storing away.

CLEANING AND MAINTENANCE

- Unplug the appliance and allow to cool.
- Wipe all the surfaces with a damp cloth.
- Don't use harsh or abrasive cleaning agents or solvents.

ENVIRONMENTAL PROTECTION

To avoid environmental and health problems due to hazardous substances in electrical and electronic goods, appliances marked with this symbol must not be disposed of with unsorted municipal waste, but recovered, reused or recycled.



SERVICE AND GUARANTEE

Defects affecting product functionality appearing within the guarantee period will be corrected by replacement or repair at our option provided the product is used and maintained in accordance with the instructions.

Your statutory rights are not affected.

Consumables are excluded.

Defects from repair by an unauthorized dealer are not covered.

If you call the Service Centre, please have the Model No. to hand, as we won't be able to help you without it. The Model No. can be found on the rating plate of the appliance.

Replacement parts and accessories are available to buy at
www.remington.co.uk/parts-accessories

➡ SERVICE CENTRE

United Kingdom

 Tel 0800 212 438 (free call mainland UK)

 +44 161 947 3111 (call outside the UK)

Spectrum Brands (UK) Ltd

Fir Street, Failsworth, Manchester

M35 0HS, UK

www.remington.co.uk

Ireland

 Tel 142 951 40

Remington Consumer Products,

Unit B12, Ballymount Corporate Park,

Ballymount, Dublin 12.

www.remington.co.uk

REGISTER ONLINE FOR

£10,000 prize draw, EXTRA year guarantee, FREE rewards gallery.

Visit www.productregister.co.uk/remington. You must register within 28 days of purchase.

Model No. H9096

14/UK/ H9096 T22-0002024 Version 01 / 14

Remington® is a Registered Trade Mark of Spectrum Brands, Inc., or one of its subsidiaries.

Spectrum Brands (UK) Ltd

Fir Street,

Failsworth,

Manchester

M35 0HS

www.remington.co.uk

© 2014 SBI