



Russell Hobbs



instructions

£10,000 prize draw
EXTRA year guarantee
FREE rewards gallery
www.productregister.co.uk/rhobbs
Register online now!
See back for details

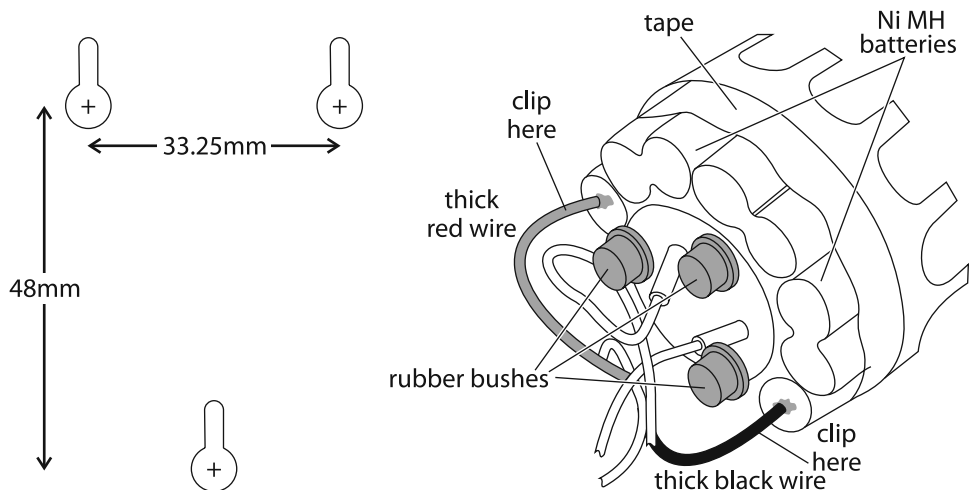
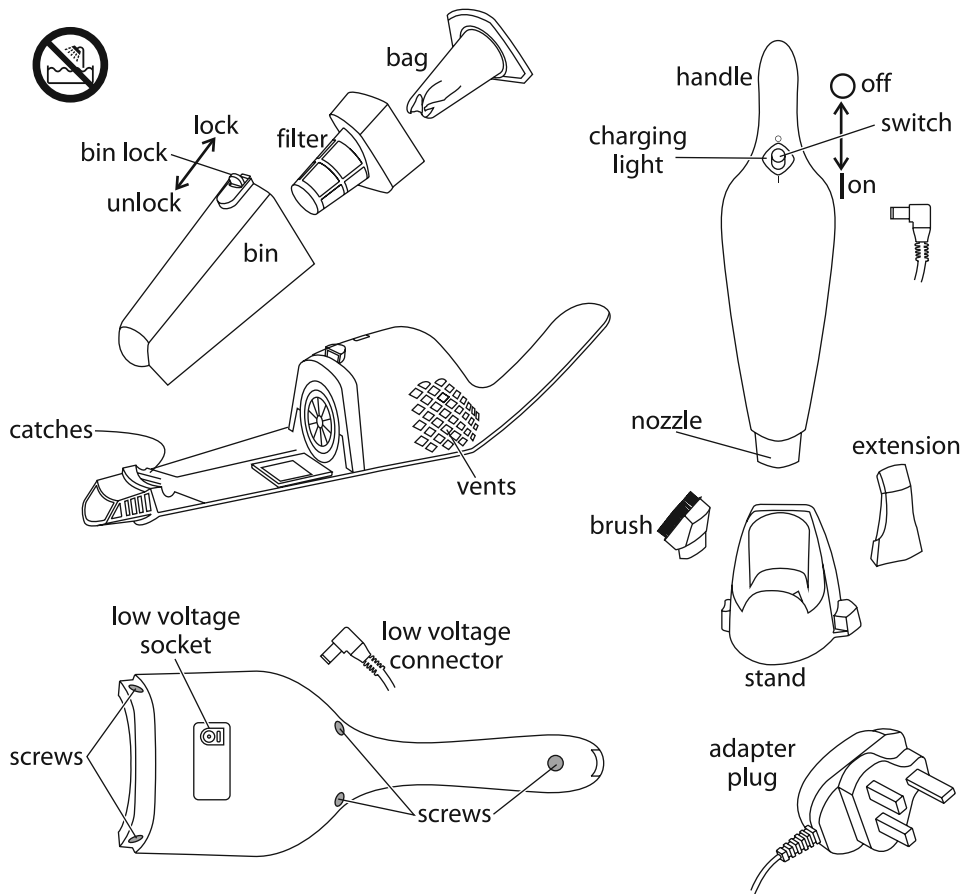

Read the instructions, keep them safe, pass them on if you pass the appliance on.
Remove all packaging before use.



IMPORTANT SAFEGUARDS

Follow basic safety precautions, including:

- 1 The cleaner must only be used by or under the supervision of a responsible adult.
It's not a toy – don't let children play with it.
- 2 Don't put the cleaner in liquid; don't use it anywhere damp.
- 3 Don't use the cleaner near a gas, oil, or open fire. The flame may be sucked towards the cleaner, causing a fire hazard.
- 4 Don't use the cleaner in the presence of combustible liquids, gases, or vapours.
Sparks from the motor may cause ignition.
- 5 Stuff you mustn't pick up:
 - a) liquids – you'll short the motor
 - b) stuff that may ignite, like matches, bits of fire-lighter
 - c) anything burning or smouldering (cigarette ends, ashes, embers) – wait till they're extinguished and cold
 - d) spillage from toner cartridges – the fine particles may pass through the filter, and short circuit the motor
 - e) cement or plaster dust – they'll combine with moisture in the air, clog the filter, scour the bin, and may burn out the motor
 - f) anything sharp – you may puncture the filter
 - g) anything biological – you'll have to clean the filter eventually, and viral particles will go through the filter, into your air supply
- 6 Don't use the cleaner on living creatures of any description.
- 7 Don't use the cleaner if the bin is full – switch off, unplug, empty.
- 8 Don't use the cleaner for any purpose other than those described in these instructions.
- 9 Don't use accessories or attachments unless we provide them.
- 10 Don't leave the cleaner in sunlight, UV can damage plastics.
- 11 Don't use the cleaner if it's damaged or malfunctions.
- 12 The adapter plug, flex, and connector can't be repaired. If damaged, they must be scrapped.
- 13 The cleaner must only be used with the adapter plug supplied, and vice versa.

household use only



WALL MOUNTING

- Your cleaner can be wall mounted, using the three "keyhole" slots on the back of the stand. This can be done by any competent DIY enthusiast. We won't accept responsibility for damage or loss of any nature arising out of this operation. If you've any doubts, get a joiner or builder to do it.
- The top holes are 33.25mm apart.
- The bottom hole is centred laterally between the top holes.
- The vertical distance between top and bottom holes is 48mm.

CHARGING

- 1 The product has 8 Nickel Metal Hydride (Ni MH) batteries, don't short-circuit, burn, mutilate, or immerse them.
- 2 Switch the cleaner off.
- 3 Push the low voltage connector into the low voltage socket in the rear of the cleaner.
- 4 Put the adapter plug into a mains socket (switch the socket on, if it's switchable).
- 5 The light will glow.
- 6 Leave it for 14 hours to charge fully.
- 7 Don't use the adapter plug or low voltage connector outdoors.

OPTIMISE BATTERY LIFE

- 8 Unplug the charger every 6 months, use the cleaner till the battery goes flat, then charge it for 14 hours before using it again.

IN USE

- 9 Slide the switch towards the nozzle to turn the cleaner on, slide it towards the handle to turn it off. It'll run for up to 15 minutes.
- 10 Attach the extension to the nozzle for nooks and crannies.
- 11 You may attach the brush to the nozzle, or the extension.
- ★ Don't let the bin fill above the MAX mark – you'll lose suction, you may damage the cleaner
- 12 To remove the bin:
 - a) slide the bin lock towards the nozzle
 - b) lift the wide end of the bin away from the cleaner
 - c) move the bin towards the handle, to free it from the catches
- 13 To empty the bin:
 - a) lift out the bag
 - b) lift out the filter
 - c) tip the contents of the bin into your waste bin
 - d) wipe the bin, inside and out, with a damp cloth
 - e) hold the filter over the waste bin, and brush any dust off it
 - f) tap the bag against the side of the waste bin, to shake off dust
 - g) replace the filter in the bin
 - h) replace the bag in the bin
- 14 To replace the bin:
 - a) fit the front of the bin to the catches at the front of the cleaner
 - b) lower the rear of the bin till the lock clicks into place

AFTER USE

- 15 Store the cleaner on the stand, whether wall mounted or not.
- 16 If you leave it on charge, it'll always be charged up ready for use.
 - a) If you don't intend to use it for a month or so, unplug it, then charge it for 14 hours before you next use it.
 - b) see point 8

CARE AND MAINTENANCE

- 17 Wipe external surfaces with a damp cloth.
- 18 Don't let moisture get into the vents.

BLOCKAGES

19 If the cleaner sounds laboured, or loses suction, don't worry, you've probably just picked up something odd, or you've discharged the battery by using it too much.

20 First, try charging it for 14 hours.

21 If that doesn't make a difference:

- a) switch the cleaner off
- b) spread a newspaper out, you're likely to make a mess
- c) if you're using the brush or extension, check these first
- d) remove and empty the bin
- e) check the filter and bag for blockages
- f) still not fixed? – ring the helpline 0845 658 9700 (local rate number)



AFTER USING FOR THE LAST TIME

Sadly, nothing lasts forever, and there will come a day when your cleaner cleans no more. It contains Nickel Metal Hydride (Ni MH) batteries, so you can't just throw it out. Instead, you must open it up, remove the batteries, and dispose of them at an authorised recycling plant. Your local authority should have a centre which accepts such waste for recycling.

To remove the batteries:

- 1 Unplug the adapter plug from the power socket.
- 2 Remove the cleaner from the stand.
- 3 Unscrew the 5 screws holding the cleaner together, and split the casing.
- 4 Pull off the three rubber bushes.
- 5 Clip the thick red wire close to the batteries.
- 6 Clip the thick back wire close to the batteries.
- 7 Cut the tape between each pair of batteries.
- 8 Remove the tape and prise the batteries out.



ENVIRONMENTAL PROTECTION

To avoid environmental and health problems due to hazardous substances in electrical and electronic goods, appliances marked with this symbol mustn't be disposed of with unsorted municipal waste, but recovered, reused, or recycled.

SERVICE

If you ring Customer Service, please have the **Model No.** to hand, as we won't be able to help you without it. It's on the rating plate (usually underneath the product).

The product isn't user-serviceable. If it's not working, read the instructions, check the plug fuse and main fuse/circuit breaker. If it's still not working, consult your retailer.

If that doesn't solve the problem – ring Customer Service – they may be able to offer technical advice.

If they advise you to return the product to us, pack it carefully, include a note with your name, address, day phone number, and what's wrong. If under guarantee, say where and when purchased, and include proof of purchase (till receipt). Send it to:

Customer Service

Spectrum Brands (UK) Ltd

Fir Street, Failsworth, Manchester M35 0HS

email: support@russellhobbs.com

telephone: 0845 658 9700 (local rate number)

➡ GUARANTEE

Defects affecting product functionality appearing within two years of first retail purchase will be corrected by replacement or repair provided the product is used and maintained in accordance with the instructions. Your statutory rights are not affected. Documentation, packaging, and product specifications may change without notice.



ONLINE

www.russellhobbs.co.uk for more products



REGISTER ONLINE FOR –



£10,000 prize draw,

EXTRA year guarantee,

FREE rewards gallery

Visit www.productregister.co.uk/rhobbs

You must register within 28 days of purchase.