



Russell Hobbs



ROSETTA

MILKSHAKE MAKER

2 YEAR WARRANTY

RHMS1

RHMS1_IB_RB_FA_121115
Part No. T225002773

INSTRUCTIONS & WARRANTY

Spectrum Brands Australia Pty Ltd

Locked Bag 3004 Braeside
Victoria 3195 Australia

Customer Service in Australia

TollFree: 1800 623 118

Email: info@spectrumbrands.com.au

Website: www.spectrumbrands.com.au

Spectrum Brands New Zealand Ltd

PO Box 9817 Newmarket
Auckland 1149 New Zealand

Customer Service in New Zealand

TollFree: 0800 736 776

Email: service@spectrumbrands.co.nz

Website: www.spectrumbrands.co.nz

Spectrum Brands Australia Pty Ltd and Spectrum Brands New Zealand Ltd Warranty Against Defects

In this warranty:

Australian Consumer Law means the Australian consumer law set out in Schedule 2 to the Competition and Consumer Act 2010;

CGA means the New Zealand Consumer Guarantees Act 1993;

Goods means the product or equipment which was accompanied by this warranty and purchased in Australia or New Zealand, as the case may be;

Manufacturer, We or us means:

1. for Goods purchased in Australia, Spectrum Brands Australia Pty Ltd ABN, 78 007 070 573; or
2. for Goods purchased in New Zealand, Spectrum Brands New Zealand Ltd, as the case may be, contact details as set out at the end of this warranty;

Supplier means the authorised distributor or retailer of the Goods that sold you the Goods in Australia or in New Zealand; and

You means you, the original end-user purchaser of the Goods.

1. Our goods come with guarantees that cannot be excluded under the Australian Consumer Law, or the CGA. You are entitled to a replacement or refund for a major failure and compensation for any other reasonably foreseeable loss or damage. You are also entitled to have the goods repaired or replaced if the goods fail to be of acceptable quality and the failure does not amount to a major failure.
2. The benefits provided by this Warranty are in addition to all other rights and remedies in respect of the Goods which the consumer has under either the Australian Consumer Law or the CGA. The original purchaser of the Goods is provided with the following Warranty subject to the Warranty Conditions:
3. We warrant the Goods for all parts defective in workmanship or materials from the date of purchase (**Warranty Period**), for the period of 2 years from the date of purchase (**Warranty Period**).

If the Goods prove defective within the Warranty Period by reason of improper workmanship or material, we may, at our own discretion, repair or replace the Goods without charge.

Warranty Conditions

4. The Goods must be used in accordance with the manufacturer's instructions. This Warranty does not apply should the defect in or failure of the Goods be attributable to misuse, abuse, accident or non-observance of manufacturer's instructions on the part of the user. As far as the law permits, the manufacturer does not accept liability for any direct or consequential loss, damage or other expense caused by or arising out of any failure to use the Goods in accordance with the manufacturer's instructions.
5. Exhaustible components (such as batteries, filters and brushes) of the Goods are included under this Warranty only where there is a defect in workmanship or materials used.
6. The warranty granted under clause 3 is limited to repair or replacement only.
7. Any parts of the Goods replaced during repairs or any product replaced remain the property of the manufacturer. In the event of the Goods being replaced during the Warranty Period, the warranty on the replacement Goods will expire on the same date as for the Warranty Period on the original Goods which are replaced.
8. In order to claim under the warranty granted under clause 3 you must:
 - (a) Retain this warranty with your receipt/proof of purchase; and
 - (b) Return the Goods to us at the relevant address or to the Supplier by prepaid freight within the Warranty Period accompanied with (i) the legible and unmodified original proof of purchase, which clearly indicates the name and address of the Supplier, the date and place of purchase, the product name or other product serial number and (ii) this warranty.
9. This warranty is immediately void if:
 - (a) Any serial number or appliance plate is removed or defaced;
 - (b) The Goods have been serviced or otherwise repaired by a person not authorised to do so by us or where non approved replaced parts are used.
10. The Goods are designed for domestic use only. The Goods must be connected to the electrical voltage requirements as specified in the ratings label located on the Goods.
11. This warranty does not cover the cost of claiming under the warranty or transport of the Goods to and from the Supplier or us.
12. This warranty is only valid and enforceable in Australia against Spectrum Brands Australia Pty Ltd and in New Zealand against Spectrum Brands New Zealand Ltd.

Contact us or the Supplier for further details.

Register your product online

If you live in Australia please visit: www.spectrumbrands.com.au/warranty

If you live in New Zealand Please visit: www.spectrumbrands.co.nz/warranty

Registration of your warranty is not compulsory, it gives us a record of your purchase AND entitles you to receive these benefits: Product information; Hints and tips; Recipes and news; Information on special price offers and promotions.

Any questions? Please contact Customer Service for advice.

Congratulations on the purchase of your Russell Hobbs appliance. Each unit is manufactured to ensure safety and reliability. **Before using the appliance for the first time, please read the instruction booklet carefully and keep it for future reference.** Pass it on if you pass on the appliance.

When using electrical appliances, basic safety precautions should always be followed.

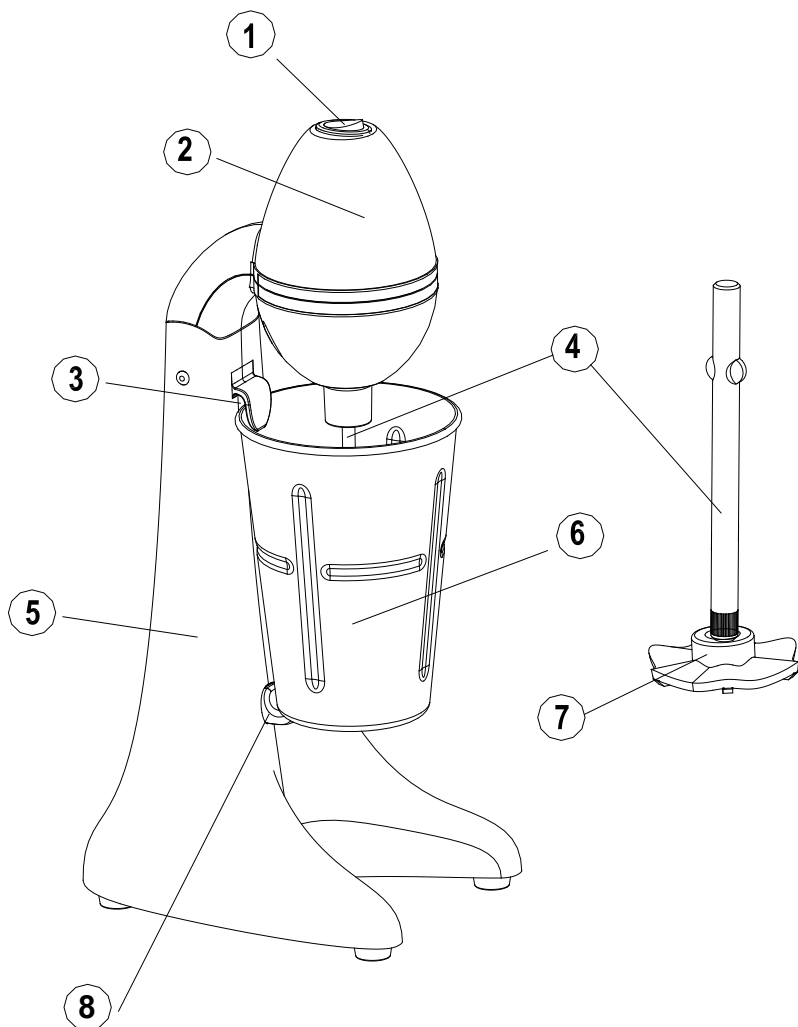

- | | |
|---------------------------------|-------------|
| 1. Switch (I-high/0-Off/II-low) | 5. Stand |
| 2. Motor Housing | 6. Cup |
| 3. Cup retainer | 7. Aerator |
| 4. Aerator shaft | 8. Cup Rest |

BEFORE USING THE MILKSHAKE MAKER FOR THE FIRST TIME

- Ensure all packaging, swing tags and promotional labelling has been removed from the milkshake maker.
- Position your milkshake maker on a firm, level, heat-resistant surface.
- Ensure the Switch on the top of the motor unit is set to position '0'.
- Plug the power cord into the wall power outlet

OPERATING THE MILKSHAKE MAKER

- Position your milkshake maker on a firm and level surface.
- Ensure the Switch on the top of the motor unit is set to position '0'.
- Plug the power cord into the wall power outlet and switch it on.
- Combine ingredients for milkshake or fruit drink in the milkshake cup. Do not fill beyond the maximum fill line.
- Place the cup in your milkshake maker ensuring the top of the cup is fixed firmly behind the cup retainer. The base of the cup should sit on the cup rest.

NOTE: This appliance incorporates a safety inhibitor switch that prevents the motor from running if the cup is not correctly placed behind the cup retainer.

- To switch on the motor, set the switch to the desired speed (I-high or II-low).

CAUTION: Avoid contacting moving parts. Keep hands, hair, clothing, as well as spatulas and other utensils away from aerator during operation to reduce the risk of injury to persons, and/or damage to the mixer.

- When the milkshake has reached your desired consistency set the switch to 0 to turn the milkshake maker off.
- Do not operate the milkshake maker for more than 45 seconds continuously. Always allow a 2 minute break in between uses.

NOTE: Always switch the appliance to the off position '0' and wait for the aerator to completely stop before removing the cup.

- Remove the milkshake cup and serve.

NOTE: When removing the cup hold on to the stand.

CARE AND CLEANING

- To clean the aerator, fill the cup to the maximum fill line with warm soapy water. Fit the cup to the stand and set the switch to the desired speed (I-high or II-low).
- Always switch the appliance to the off position '0' and wait for the aerator to completely stop before removing the cup.
- Switch the power off at the power outlet and then remove the plug before cleaning the motor housing.
- Wipe the outer surfaces with a soft damp cloth. If necessary, use a little dish washing detergent.
- Wash the milkshake cup in warm soapy water or alternatively place in the dishwasher.
- Do not use harsh or abrasive cleaning agents or solvents.
- Do not use alkaline cleaning agents when cleaning this appliance.
- Do not immerse the milkshake maker in water or any other liquid.

IMPORTANT SAFEGUARDS

When using electrical appliances, basic safety precautions should always be followed, including:

1. To protect against electrical hazards, do not immerse the power cord, plug or milkshake maker in water or any other liquid.
2. Do not use in the bathroom or near any source of water.
3. Do not use outdoors.
4. Do not touch the aerator with your hand, a spatula, spoon or the like during operation.
5. Misuse of the appliance may cause injury.
6. This appliance is not intended for use by persons (including children) with reduced physical, sensory or mental capabilities, or lack of experience and knowledge, unless they have been given supervision or instruction concerning use of the appliance by a person responsible for their safety.
7. This appliance must be attended whilst plugged in.
8. Always turn off and unplug from the wall power outlet when not in use and before cleaning the appliance.
9. To disconnect, turn off the wall power outlet, then grasp and pull the plug from the wall outlet. Never pull by the cord.
10. Do not operate this appliance with a damaged cord/plug or after the appliance has been dropped, damaged or has malfunctioned in any manner. Contact Customer Service for examination, adjustment, repair or replacement.
11. There are no user serviceable parts. If the power cord is damaged, it must be replaced by the manufacturer or similarly qualified person in order to avoid a hazard.
12. Do not use on an inclined plane or unstable surface.
13. Do not move the milkshake maker while it is switched on.
14. Do not cover the milkshake maker when in use.
15. Do not use the aerator to mix hard ingredients such as frozen butter or dough.
16. Do not run for longer than 3 minutes to avoid overheating the motor. If the motor has been run for 3 minutes, allow 30 minutes to cool before using again.
17. Do not use the milkshake maker for purposes other than mixing.
18. Keep the milkshake maker and the power cord away from the edge of tables or countertops and out of reach of children and persons with reduced physical, sensory and mental capacities.
19. Ensure the milkshake maker has switched off before removing the cup.
20. Do not place on or near any heat sources.
21. Follow the instructions when cleaning this appliance.
22. Do not use this appliance for other than its intended purpose.
23. Do not leave the milkshake maker unattended when in use or where it may be touched by children.
24. Avoid contacting moving parts. Keep hands, hair, clothing, as well as spatulas and other utensils away from aerator during operation to reduce the risk of injury to persons, and/or damage to the mixer.
25. This appliance is not a toy. Children should be supervised to ensure they do not play with the appliance. Cleaning and user maintenance shall not be made by children without supervision.
26. This appliance is not intended to be operated by means of an external timer or separate remote control system.
27. For added safety, electrical appliances should be connected to a power outlet that is protected by a residual current device (RCD), also often referred to as a 'Safety Switch'. Your switchboard may already incorporate an RCD. If unsure, call an electrician for verification and fitting if necessary.



SAVE THESE INSTRUCTIONS.

THIS APPLIANCE IS FOR HOUSEHOLD USE ONLY.

[illegible]

This image shows a full page of a handwriting practice worksheet. It consists of approximately 20 horizontal rows. Each row is defined by two parallel dashed lines, creating a series of uniform gaps for letter height. The lines are evenly spaced across the entire page, providing a guide for consistent letter formation. There is no text or other markings on the page.

[illegible]



Russell Hobbs



RECIPE BOOK

ROSETTA

MILKSHAKE MAKER

RHMS1

RECIPES

NOTE: THE VOLUME OF YOUR MILKSHAKE WILL VARY DEPENDING ON THE TYPE OF MILK USED. FOR EXAMPLE, FULL CREAM MILK DOES NOT FROTH AS MUCH AS SKIM OR LOW FAT MILK.

ALWAYS REMEMBER THAT SOLIDS, SUCH AS ICE CREAM OR FRUIT, WILL INCREASE THE VOLUME OF THE MILKSHAKE.

ENSURE THAT THE LIQUID COMPONENT OF THE MILKSHAKE DOES NOT EXCEED THE MAXIMUM LINE ON THE SIDE OF THE MILK SHAKE CUP.

EXTRA VOLUME MAY BE ACHIEVED IF THE INGREDIENTS ARE CHILLED.

VERY BERRY MILKSHAKE

Makes approx. 1 milkshake

- 1 cup reduced-fat milk
- 1 large scoop vanilla ice-cream
- 1 tablespoon strawberry topping
- 1/4 cup fresh or frozen raspberries
- 1 teaspoon vanilla extract

1. Blend milk, ice-cream, topping, raspberries and vanilla together until smooth.
2. Pour into chilled glass. Serve.

CHOCK MALT MILKSHAKE

Makes approx. 1 milkshake

- 1 scoop vanilla ice-cream
- 1 tablespoon malted milk powder
- 3/4 cup milk
- chocolate topping

1. Blend ice-cream, malt powder, milk and 2 tablespoons chocolate topping until smooth.
2. Drizzle 1 tablespoon chocolate topping around the inside of each chilled glass. Pour ice-cream mixture into glasses. Serve.

ICED COFFE MILKSHAKE

Makes approx. 1 milkshake

3/4 teaspoon instant espresso coffee powder

1 teaspoon hot water

1/2 cup milk

1 scoop vanilla ice-cream

Grated dark chocolate, to serve

1. Combine coffee powder and hot water until powder is dissolved. Blend milk, icecream and three-quarters of the coffee mixture.
2. Pour into a serving glass. Stir in remaining coffee mixture. Serve topped with chocolate.

www.russellhobbs.com.au

www.russellhobbs.co.nz

Russell Hobbs® and Russell Hobbs logo are the registered trademarks of Spectrum Brands, Inc. or one of its subsidiaries.
© 2015 SBL.

Recipes are to be used in conjunction with the (RHMS1) Russell Hobbs® Milkshake Maker.
All rights reserved. No part of this publication may be reproduced, stored in a retrieval system or transmitted in any form or by any means, electronic, mechanical, photocopying, recording or otherwise, without prior permission of the copyright owner.