



Russell Hobbs

instructions,
troubleshooting guide,
and guarantee

Problems?
Don't take it back
to the shop,
they won't be able
to fix it.



Ring the helpline

0845 658 9700

it's a local rate number

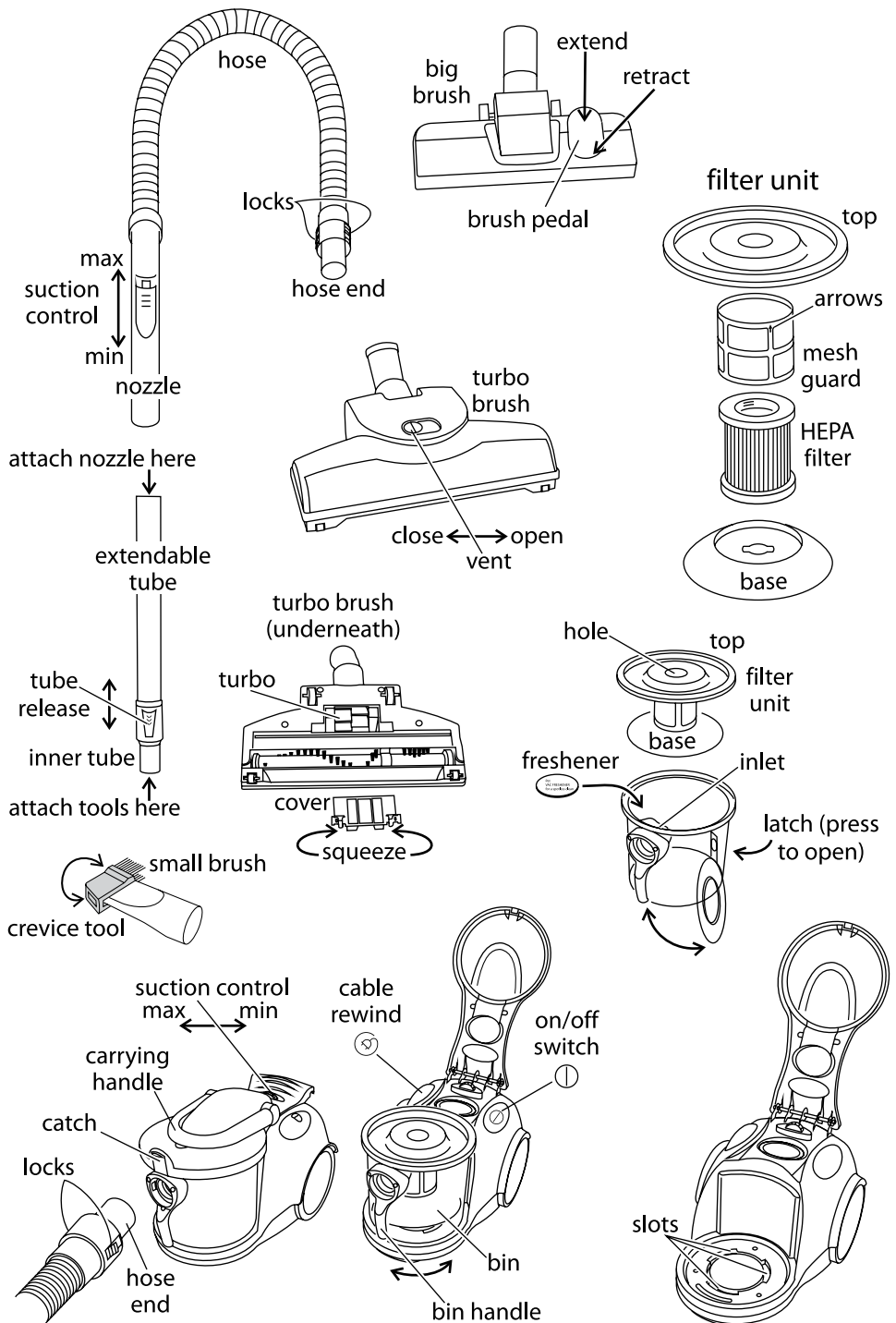

Read the instructions before using your vacuum cleaner, and keep them safe.
If you pass the cleaner on, pass on the instructions too.

important safeguards

Follow basic safety precautions, including the ones below. It's quite a list, but most of them are simple common sense.

- 1 The cleaner should only be used by or under the supervision of a responsible adult.
- 2 Don't put the cleaner in any liquid, and don't use it anywhere damp or wet.
- 3 Don't use the cleaner near a gas, oil (including paraffin), or open fire. The flame may be sucked towards the cleaner, causing a fire hazard. 
- 4 Keep hair, clothing, fingers (and toes), away from the end doing the sucking, and from the brush. It won't drag you into the bin, but it may give you a bit of a start.
- 5 Stuff you mustn't pick up:
 - a) don't pick up any liquid – you'll short the motor
 - b) don't pick up stuff that may ignite spontaneously, like matches, bits of fire-lighter
 - c) don't pick up anything burning or smouldering, like cigarette ends, ashes, or embers – wait till they're extinguished and cold
 - d) don't pick up spillage from toner cartridges – the fine carbon particles may pass through the filter, short circuit the motor, and burn it out
 - e) don't pick up cement or plaster dust – they'll combine with moisture in the air, clog the filter, scour the bin, and maybe burn out the motor too
 - f) don't pick up anything sharp – you may puncture the filter and damage the motor
 - g) don't pick up anything biological – you'll eventually have to clean it off the filter, and there's always the possibility that viral particles may pass through the filter, reach the air outlet, and enter your air supply
- 6 If you use the cleaner outdoors (e.g. cleaning the car), connect it to the electricity supply via a residual current device (RCD), with a rated residual operating current not exceeding 30mA. Don't let the cleaner get wet.
- 7 Store and use the cleaner out of reach of children.
- 8 Don't leave it unattended when plugged in.
- 9 Keep an eye on the cable, so it doesn't catch on anything, or trip anyone up. Don't run the cleaner over the cable, you'll damage it.
- 10 If you're using the cleaner on stairs, sit it where it can't topple, and keep it below you, so if it does topple, it won't land on you.
- 11 Don't use the cleaner on people, animals, birds, or pets.
- 12 Unplug the cleaner and rewind the cable when not in use, before moving and before cleaning.
- 13 Don't use the cleaner if the bin is full – switch off, unplug, and empty it.
- 14 Don't use the cleaner for any purpose other than those described in these instructions.
- 15 Don't use accessories or attachments other than those we provide.
- 16 Don't leave the cleaner in sunlight, prolonged exposure to UV may damage plastics.
- 17 Don't use the cleaner if it's damaged or malfunctions. If the cable or plug is damaged, the cleaner must be returned in order to avoid hazard.

household use only

before using for the first time

Remove the packaging, but keep it till you're sure the cleaner is working properly.

filters

Keep the filters clean – if they get blocked, you'll lose suction rapidly.

count the bits

In the box you'll find a turbo brush, big brush, hose (with nozzle), extendable tube, crevice tool/small brush, a spare HEPA filter, and a small bag of vac fresheners. These may be packed separately, so check all of the packaging before you dispose of it. The crevice tool/small brush may be mounted in its slot between the wheels.

fitting the hose

- 1 Turn the hose end, to align the locks on either side with the notches in the inlet.
- 2 Push the hose end into the inlet. You'll hear a click as it locks into position.
- 3 Give it a gentle tug to check it's fitted properly.

cable

- 4 Pull as much cable as you need from the back of the cleaner.
- 5 There's a yellow band round the cable to show there's about a metre left.
- 6 There's a red band about half a metre later. This means "Stop pulling, you've run out of cable!".
- 7 Keep an eye on the cable so it doesn't catch on anything, and doesn't trip anyone (including you).

carrying and moving the cleaner

- 8 Lift the cleaner only by the carrying handle.
- 9 When you lower the cleaner, make sure it's sitting on the floor before you let the handle go – this might sound obvious, but with such a small cleaner you might be tempted to drop it a little, instead of bending down. Don't – you'll damage it.
- 10 When the cleaner is sitting on its wheels (normal position), you can move it around by pulling gently (that's gently), on the hose.
- 11 For stationary jobs like curtains, you may sit the cleaner up, with the hose at the top, as it's shown on the front page, but don't try to move it like this, or it'll fall over.

choose the tool for the job

- 12 The big brush and crevice tool/small brush will fit on the main nozzle, or on the end of the extendable tube. The extendable tube fits on the end of the main nozzle.
- 13 You'll have your own preferences, but here are few tips for the first time user.

big brush normally used with the extendable tube, for floors and carpets:
Press the rear of the brush pedal to extend the bristles for hard floors, or floor coverings without pile.
Press the front of the brush pedal to retract the bristles for use on rugs, carpets, and anything with pile.

turbo brush normally used with the extendable tube, for floors and carpets, this has a rotating brush, powered by suction, for deeper cleaning.
Close the vent on top of the brush for use on floors without carpet, or carpet with short pile; open it for rugs and long pile carpets

crevice tool as the name implies, down the sides of upholstery, in awkward spaces, nooks, and crannies nothing else can reach.

small brush use it to remove pet hair, lint, and dust from blinds, curtains, and upholstery; to brush/clean awkward corners.

14 We suggest the big brush for the daily clean, the turbo for the weekly deep clean.

15 The small brush is part of the crevice tool. To use, turn it a bit more than 90° from the crevice tool, to store, turn it back, parallel to the crevice tool. It can be stored in a niche at the rear of the cleaner.

tubes

16 Fit the extendable tube to the nozzle for floors, carpets, or hard to reach places:

- a) push the tube release towards the narrow end of the tube, and keep it pressed
- b) pull out as much of the inner tube as you need – if you're done, push it back
- c) return the tube release to the locked position

17 Push the wide end of the extendable tube on to the main nozzle.

18 Choose a tool, and push it onto the narrow end of the tube.

suction control

19 There are two ways to control the suction:

- a) The suction control on top of the cleaner – turn it towards max to increase the cleaning power, towards min to decrease the power.
- b) The suction control on the main nozzle – move it back from the main nozzle for maximum suction, forward, towards the main nozzle, to reduce suction.

plug in

caution If you've accidentally pressed the on/off switch, the cleaner could come on when you plug it in. This could give you a bit of a start, so be careful.

20 Plug the cable into a socket near the area to be cleaned (switch the socket on, if it's switchable).

switching on

21 Press and release the on/off switch ①, to turn the cleaner on.

cleaning

22 Move the tool over the surface, cleaning a small area at a time.

23 When you move to a new area, overlap the previous area, to make sure none of the surface is missed.

switching off

24 If you've finished, if you want to change tools, or if you just want to stop, press and release the on/off switch ①, to turn the cleaner off.

finished cleaning?

25 Press and release the on/off switch ①, to turn the cleaner off.

26 Unplug the cleaner.

27 Stand clear of the cable, and press the cable rewind ②, the cable will rewind.

28 Keep clear of the cable, as it rewinds at a fair lick. If it catches on anything, stop pressing, and it'll stop rewinding.

29 We've tried not to make it too powerful, to avoid wrecking your home, so you may need to push the plug end into the storage area manually.

removing and emptying the bin

- 30 You don't have to empty the bin after each use, but it's a very good idea. Your cleaner will happily work till it's chock full, but you'll be wasting energy swirling yesterday's dust around. Energy that could be better used sucking up today's dust.
- 31 Switch off, unplug, and leave it for a minute, to let the dust settle.
- 32 Squeeze the locks on the hose end, and pull the hose out of the cleaner – this'll keep the hose out of your way.
- 33 Press the top of the catch to unlock it, then use it to lift the top of the cleaner up and back (about 110 degrees).
- 34 Use the bin handle to turn the bin anti-clockwise till it stops (about 45 degrees). Then lift the bin up and out of the cleaner.
- 35 Lower the bin into your dustbin so the bottom of the bin is below the rim – this'll prevent the dust dispersing into your environment.
- 36 Press the latch on the opposite side of the bin to the inlet, to open the bottom of the bin, and dump its contents into the dustbin.
- 37 Lift the bottom of the bin up to close it.

check the filters

- 38 While emptying the bin, check the filters. Blocked filters quickly reduce suction, and they're easy to clean.
- 39 Put two fingers into the hole in the centre of the HEPA filter unit, and lift the filter unit out of the bin – you'll have to tilt it a bit to get the base past the inlet.

disassemble the HEPA filter unit

- 40 Spread out some newspaper – you're going to make a mess.
- 41 Unscrew the top of the filter unit from the HEPA filter.
- 42 Lift the mesh guard from the HEPA filter, and tap it gently over the newspaper, to dislodge any dirt.
- 43 If it's really dirty, rinse it gently under a running tap.
- ✳ You must ensure it's completely dry before reassembling the filter unit.
- 44 Hold the base, and turn the HEPA filter about a quarter of a turn anti-clockwise, to separate them (it's a bayonet fitting).

clean the HEPA filter

- 45 This filters the returning airflow. It's expensive to replace, so be gentle with it. With careful handling, it should last for years. We've given you a spare, so you don't have to stop cleaning while you wash and dry the HEPA filter – simply fit the spare.
- 46 If the filter looks a bit mucky, tap it over the newspaper, to dislodge the dirt.
- 47 If it's very dirty, soak it in warm soapy water for a few minutes, rinse under a running tap, to remove all trace of soap, then let it air dry – don't refit till it's completely dry.

reassemble the HEPA filter unit

- 48 Put the bayonet fitting on the bottom of the HEPA filter into the centre of the base, and turn it about quarter of a turn clockwise.
- 49 Hold the mesh guard with the arrows pointing upwards, and lower it over the HEPA filter.
- 50 Fit the top of the filter unit to the top of the HEPA filter, and turn it clockwise – don't overtighten it.

- ★ Put a freshener on the bottom of the bin – these are small cards impregnated with perfume, to modify any odours coming from the dust and dirt.
- 51 Replace the HEPA filter unit in the bin – you'll have to tilt it a bit to get the base past the inlet.
- 52 To replace the bin, turn it anti- clockwise about 45 degrees, to align the tabs on the bottom of the bin with the slots in the cleaner.
- 53 Now lower the bin on to the cleaner, and turn the handle to the front, to lock the bin in place.
- 54 Don't close the cleaner, you're not finished yet!

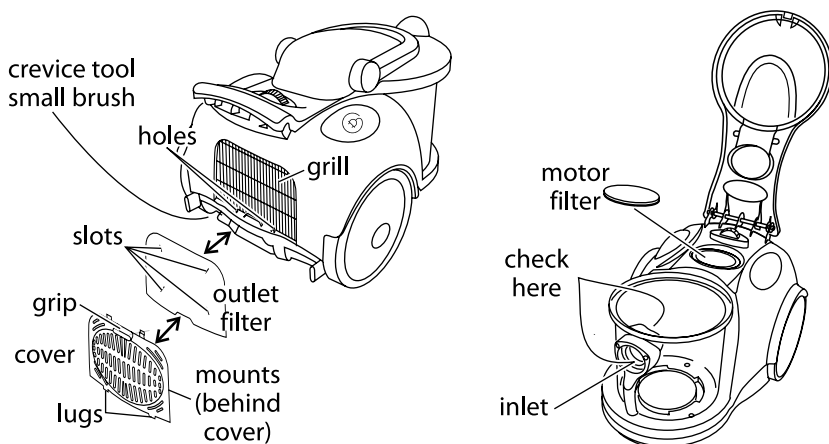

check the motor filter

- 55 Pick the motor filter out of its niche in front of the suction control
- 56 If it looks a bit mucky, tap it over the newspaper, to dislodge the dirt.
- 57 If it's very dirty, soak it in warm soapy water, swill it out under a running tap, to remove all trace of soap, then let it air dry, till it's completely dry.
- 58 When it's dry, replace it in its niche, soft side up.
- 59 Lower the top of the cleaner, and press the end down to engage the catch.
- 60 Attach the hose to the cleaner.

check the outlet filter

- 61 Turn the cleaner round and check the outlet filter.
- 62 Press the grip down, pull the top of the cover away from the cleaner, and lift the cover up and off the cleaner.
- 63 Ease the filter off the inside of the cover.
- 64 If the filter looks a bit mucky, tap it over the newspaper, to dislodge the dirt.
- 65 If its very dirty, soak it in warm soapy water, swill it out under a running tap, to remove all trace of soap, then let it air dry, till it's completely dry.
- 66 Put the filter into the rear of the cover – the soft side of the filter should be towards the cleaner.
- 67 The slots in the cover fit over the mounts on the inside of the cover.
- 68 Fit the lugs in the bottom of the cover into the slots in the cleaner, and push the top of the cover into the cleaner, till it clicks into place.

cleaning the cleaner

- 69 Switch the cleaner off and unplug it before cleaning.
- 70 Don't put any part of the cleaner in a dishwasher.
- 71 Don't use harsh or abrasive cleaning agents or solvents.
- 72 Wipe external surfaces with a damp cloth. A dab of washing-up liquid will remove stubborn stains, but clean it off afterwards, or it may stain.
- 73 Wipe the tools with a damp cloth, or hand wash in warm soapy water. Rinse to remove any trace of soap, and air dry before using.
- 74 Wipe the extendable tube and hose with a damp cloth. Use a dab of washing-up liquid to remove any stubborn marks. Remove all trace of the washing-up liquid, and check they're dry before refitting. Don't put them in water, you'll damage them.
- 75 Wash the bin in warm soapy water. Use a soft cloth or sponge, nothing harsh. Rinse to remove all trace of soap and air dry. Don't replace it till it's fully dry.

timing

- 76 Clean the cleaner frequently. Basically, the better you look after it, the longer it'll last. Keep an eye on it as you use it, and examine the filters when you empty the bin. If anything needs cleaning, do it there and then, don't put it off, in case you forget.

blockages

No matter how careful you are, sooner or later you'll block the cleaner.

don't panic!

If the cleaner starts to get noisy and you start to lose suction, don't worry, it's not the end of the world, you've probably just blocked it up.

- 1 Switch the cleaner off and unplug it.
- 2 Spread a newspaper on the floor, you're going to make a mess.
- 3 If you're using one of the tools, remove and check it first.
- 4 Pull the hose out and check it – leave it out for the next bit.
- 5 Open the lid, remove the bin, and check the inlet (see the drawing on page 7).
- 6 If there is a blockage use a blunt object such as a finger, or blunt end of a ball-point pen to dislodge it, don't use anything sharp.
- 7 Check all the filters.
- 8 If you haven't cleared the blockage by now, try again.
- 9 Still not clear? – Ring the helpline.

connection

The cleaner doesn't need an earth. It has a 13A BS1362 fuse in a 13A BS1363 plug. To replace the plug, fit the blue wire to N, and the brown wire to L. Fit the cord grip. If in doubt, call an electrician.

Don't use a non-rewireable/moulded plug unless the fuse cover is in place. If you remove the plug, dispose of it.

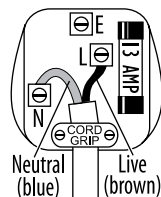

helpline – 0845 658 9700

If you need help, note the Model No (on the rating plate) and ring the helpline 0845 658 9700 (it's a local rate number).

spare parts

Note the Model No (on the rating plate) and the part(s) you need, then ring the helpline – 0845 658 9700, or email service@saltoneurope.com for price(s). You may then order spares with VISA or MASTERCARD.

service

The cleaner isn't user-serviceable. If it's not working, read the instructions, check the plug fuse and main fuse/circuit breaker.

If that doesn't solve the problem, don't take the cleaner back to the place you bought it – they won't be able to fix it. Ring Customer Service.

If you have to return the cleaner to us, pack carefully, with a note of your name, address, day phone number, and what's wrong. If under guarantee, say where and when purchased, and include proof of purchase (till receipt). Send it to Customer Returns (address below right).

Customer Service

(correspondence only)
Salton Europe Ltd
Failsworth
Manchester
M35 0HS

Customer Returns

Salton Europe Ltd
Heath Mill Road
Wombourne
Wolverhampton
WV5 8AQ

Customer Service (service@saltoneurope.com)
telephone 0845 658 9700 (local rate number)

guarantee

Defects affecting product functionality appearing within one year of purchase will be corrected by replacement or repair provided the product is used and maintained in accordance with the instructions. Your statutory rights are not affected. Documentation, packaging, and product specifications may change without notice. www.russellhobbs.co.uk for more products.