



Russell Hobbs



instructions, troubleshooting guide, and guarantee
Problems?

Don't take it back to the shop,
they won't be able to fix it.

Ring the helpline

0845 658 9700

it's a local rate number

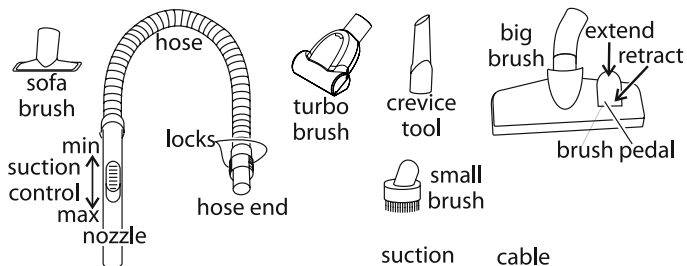

attach nozzle here

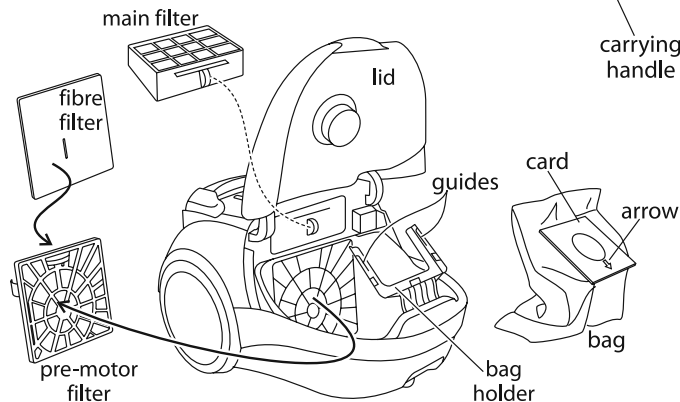
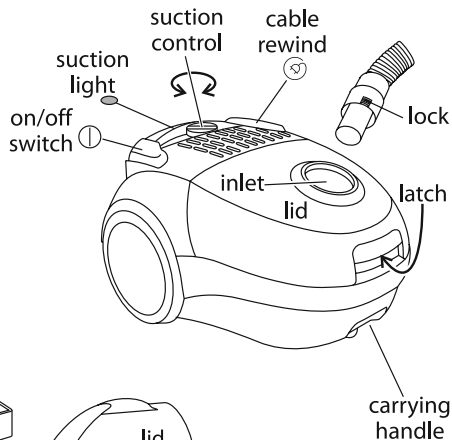
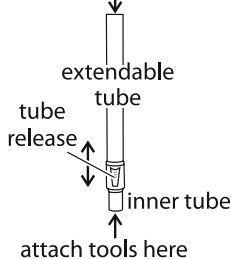

Read the instructions, keep them safe, pass them on if you pass the appliance on. Remove all packaging before use.



IMPORTANT SAFEGUARDS

Follow basic safety precautions, including:

- 1 The cleaner should only be used by or under the supervision of a responsible adult. It's not a toy – don't let children play with it.
- 2 Don't put the cleaner in liquid; don't use it anywhere damp or wet.
- 3 Don't use the cleaner near a gas, oil, or open fire. The flame may be sucked towards the cleaner, causing a fire hazard.
- 4 Keep hair, clothing, fingers, toes, and pets away from the end doing the sucking, and from the brush.
- 5 Stuff you mustn't pick up:
 - a) liquids – you'll short the motor
 - b) stuff that may ignite, like matches, bits of fire-lighter
 - c) anything burning or smouldering (cigarette ends, ashes, embers) – wait till they're extinguished and cold
 - d) spillage from toner cartridges – the fine particles may pass through the filter, and short circuit the motor
 - e) cement or plaster dust – they'll combine with moisture in the air, clog the filter, scour the bin, and may burn out the motor
 - f) anything sharp – you may puncture the filter
 - g) anything biological – you'll eventually have to clean it off the filter, and viral particles may pass through the filter, reach the air outlet, and enter your air supply
- 6 If you use the cleaner outdoors (e.g. cleaning the car), connect it to the electricity supply via a residual current device (RCD), with a rated residual operating current not exceeding 30mA.
- 7 Don't leave the cleaner unattended when plugged in.
- 8 Unplug the cleaner and rewind the cable when not in use.
- 9 Keep an eye on the cable, so it doesn't catch on anything, or trip anyone up. Don't run the cleaner over the cable, you'll damage it.
- 10 If you're using the cleaner on stairs, sit it where it can't fall, and keep it below you, so if it does fall, it won't land on you.
- 11 Don't use the cleaner if the bin is full – switch off, unplug, empty.



- 12 Don't use the cleaner for any purpose other than those described in these instructions.
- 13 Don't use accessories or attachments unless we provide them.
- 14 Don't leave the cleaner in sunlight, UV can damage plastics.
- 15 Don't use the cleaner if it's damaged or malfunctions.
- 16 If the cable or plug is damaged, return the cleaner to avoid hazard.

household use only



COUNT THE BITS

You should have an extendable tube, a turbo brush, a big brush, a crevice tool, a small brush, a sofa brush, a hose, and spare bags – check all the packaging before you dispose of it.



FITTING THE HOSE

- 1 Push the hose end into the inlet.
 - 2 You'll hear a click as it locks into position.
-



CABLE

- 3 Pull as much cable as you need from the back of the cleaner.
 - 4 The yellow band round the cable tells you there's a metre left.
 - 5 The red band tells you "Stop pulling, you've run out of cable!".
 - 6 Watch the cable so it doesn't catch on anything, or trip anyone.
-



CARRYING AND MOVING THE CLEANER

- 7 Lift the cleaner only by the carrying handle.
- 8 When the cleaner is sitting on its wheels (normal position), you can move it around by pulling gently (that's gently), on the hose.
- 9 For stationary jobs like curtains, you may sit the cleaner upright, with the handle uppermost, but don't try to move it around like this, it'll fall over.



CHOOSE THE TOOL FOR THE JOB

- 10 The tools will fit on the nozzle, or the end of the inner tube.
 - big brush** used with the tubes, for floors and carpets:
Press the rear of the pedal to extend the bristles for floors with little or no pile. Press the front to retract the bristles for rugs, carpets, and anything with pile.

- turbo brush** used with the tubes, for floors and carpets, it has a rotating, suction powered brush, for deep cleaning.
- crevice tool** as the name implies, down the sides of upholstery, in awkward spaces nothing else can reach.
- small brush** to remove dust from blinds and curtains, and to brush/clean awkward corners.
- sofa brush** to remove pet hair, lint, and dust from upholstery, and other small, flat areas – don't use it on hanging curtains, as it doesn't have the bristles necessary to let air flow freely, use the small brush instead.
-

EXTENDABLE TUBE

- 11 Use the extendable tube to the nozzle for floors, carpets, or hard to reach places:
- a) push the tube release towards the narrow end of the tube, and keep it pressed
 - b) pull out as much of the inner tube as you need
 - c) if you've finished using it, push it back
 - d) return the tube release to the locked position
- 12 Fit the wide end of the extendable tube to the nozzle.
- 13 Choose a tool, and fit it to the narrow end of the tube.
-

SUCTION CONTROL

- 14 There are two ways to control the suction:
- a) The suction control on top of the cleaner – move it towards max to increase suction, towards min to reduce suction.
 - b) The suction control on the nozzle – move it towards the nozzle for maximum suction, away from the nozzle, to reduce suction.
-

POWER UP



caution If you've accidentally pressed the on/off switch ①, the cleaner may start up when you plug it in.

- 15 Plug the cable into a power socket (switch the socket on).
- 16 Press and release the on/off switch ①, to turn the cleaner on.

CLEANING

- 17 Move the tool over the surface, cleaning a small area at a time.
- 18 When you move to a new area, overlap the previous area.

FINISHED?

- 19 Press and release the on/off switch , to turn the cleaner off.
- 20 Unplug the cleaner (switch the socket off first).
- 21 Press the , and hold it in – the cable will rewind.
- 22 Keep clear of the cable. If it catches on anything, stop pressing, and it'll stop rewinding.
- 23 We've tried not to make it too powerful, to avoid wrecking your home, so you may need to push the plug end in manually.

SUCTION LIGHT

- 24 The suction light, on top of the cleaner, glows if the cleaner is stressed, then goes out as the stress is removed.
 - a) unless it glows steadily, you needn't worry about it
 - b) it may flicker while you're cleaning, as the load changes
 - c) it may pulse with the turbo brush, as the load varies more
 - d) it'll glow steadily if you block the hose – move the hose
 - e) it'll glow steadily if you let the bag get full – stop and replace it
 - f) it'll glow steadily if there's a blockage – stop and clear it

REMOVING THE BAG

- 25 Keep an eye on the suction light, and change the bag when it's full, otherwise you'll choke the cleaner.
- 26 Switch off, unplug, and let the dust settle for a minute.
- 27 Squeeze the locks on either side of the hose end, and pull the hose out of the cleaner.
- 28 Squeeze the latch in towards the lid, then raise the lid.
- 29 Grip the card part of the bag, slide it up and out of the bag holder, then lower the bag gently into the dustbin..
- ★ Don't handle the bag itself – you might squeeze or burst it.
- 30 Don't try to empty and reuse the bag. It takes quite a pounding from the action of the cleaner, and from the dirt hitting it. Oils in your skin weaken it further, so it might burst inside the cleaner.

CHECK THE FILTERS

- 31 Spread out some newspaper, and wear rubber gloves.
- ★ Filters must be completely dry before replacing in the cleaner.
- 32 Pull the pre-motor filter away from the rear of the bag compartment, and tap it over the dustbin, to dislodge any dirt.
- 33 If it's really dirty, gently pull the fibre filter out of the pre-motor filter, soak it in warm soapy water for a few minutes, rinse under a running tap, then let it air dry.
- 34 When you replace it, the slit in the fibre filter fits over the "C"-shaped grip on the rear of the pre-motor filter.
- 35 Sit the pre-motor filter against the rear of the bag compartment, and push it till it clicks into place.
- 36 Pull the main filter out of its drawer above the pre-motor filter, and tap it over the dustbin, to dislodge any dirt.
- 37 If it's really dirty, soak it in warm soapy water for a few minutes, rinse under a running tap, then let it air dry.
- 38 When it's dry, replace it in its drawer.

FIT THE NEW BAG

- 39 Hold the new bag only by the card. Skin oils will weaken the bag.
- 40 Slide the card into the bag holder, under the guides.
- 41 Close the lid – you should hear the latch click into place.
- 42 Push the hose end into the inlet. It'll click as it locks into place.

CLEANING THE CLEANER

- 43 Switch the cleaner off and unplug it.
- 44 Wipe external surfaces of the cleaner with a damp cloth.
- 45 Wipe the tools and tubes with a damp cloth.
- 46 Don't put any part of the cleaner in a dishwasher.

TIMING

- 47 Clean the cleaner frequently. Basically, the better you look after it, the longer it'll last. Keep an eye on it as you use it, and examine the filters when you empty the bin. If anything needs cleaning, do it there and then, don't put it off, in case you forget.

BLOCKAGES

48 No matter how careful you are, sooner or later you'll block the cleaner.

DON'T PANIC!

If the cleaner starts to get noisy and you start to lose suction, don't worry, it's not the end of the world, you've probably just blocked it.

- 1 Switch the cleaner off and unplug it.
- 2 Spread a newspaper on the floor, you're going to make a mess.
- 3 If you're using one of the tools, remove and check it first.
- 4 Pull the hose out and check it.
- 5 Use something blunt, like the blunt end of a ball-point pen to dislodge any blockage.
- 6 Check the bag – if it's full, replace it.
- 7 Check the filters.
- 8 If you haven't cleared the blockage by now, try again.
- 9 Still not clear? – Ring the helpline.

WIRING INSTRUCTIONS UK plugs only

The cleaner doesn't need an earth. It has a 13A BS1362 fuse in a 13A BS1363 plug. To replace the plug, fit the blue wire to N, and the brown wire to L. Fit the cord grip. If in doubt, call an electrician. Don't use a non-rewireable/moulded plug unless the fuse cover is in place. If you remove the plug, dispose of it.

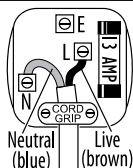



ENVIRONMENTAL PROTECTION

To avoid environmental and health problems due to hazardous substances in electrical and electronic goods, appliances marked with this symbol mustn't be disposed of with unsorted municipal waste, but recovered, reused, or recycled.



SERVICE

helpline – 0845 658 9700

If you need help, ring the helpline (it's a local rate number).

Please have the **Model No.** to hand, as we won't be able to help you without it. It's on the rating plate (usually underneath the product).

The product isn't user-serviceable. If it's not working, read the instructions, check the plug fuse and main fuse/circuit breaker. If it's still not working, consult your retailer.

If that doesn't solve the problem – ring Customer Service – they may be able to offer technical advice.

If they advise you to return the product to us, pack it carefully, include a note with your name, address, day phone number, and what's wrong. If under guarantee, say where and when purchased, and include proof of purchase (till receipt). Send it to:

**Customer Service, Spectrum Brands (UK) Limited, Fir Street,
Failsworth, Manchester M35 0HS**

email: service@russellhobbs.com

telephone: 0845 658 9700 (local rate number)

18213

551-235

➡ GUARANTEE

Defects affecting product functionality appearing within two years of first retail purchase will be corrected by replacement or repair provided the product is used and maintained in accordance with the instructions. Your statutory rights are not affected. Documentation, packaging, and product specifications may change without notice.



ONLINE

www.russellhobbs.co.uk for more products